

SURVEYOR'S STATEMENT

I, FRANK C. HULSE, a Professional Land Surveyor registered within the State of Nevada, and that this Parcel Map consisting of one sheet, accurately and completely delineates the survey made by him and completed on the 23rd day of December, 1995. This map has been prepared at the instance of D.C. DAY and FAY DAY, Owners. Lands surveyed lie within the SW1/4 of the SE1/4 of Section 35, T3S, R55E, M.D.M. All monuments are of the character and occupy the positions shown hereon and are sufficient to enable the survey to be retraced. This survey conforms to the definitions and provisions of N.R.S. 278.471 thru 278.4725, inclusive.

FRANK C. HULSE
 P.L.S. 6498
 8 Feb 1996

OWNER'S CERTIFICATE

We, D.C. DAY and FAY DAY, do hereby certify that we are the owners of the land shown hereon and that we consent to the preparation and recordation of this Parcel Map showing the land plotted into parcels and that it conforms to the provisions of N.R.S. 278.471 to 278.4725, inclusive. We also offer for dedication the roads and multiple use easements as shown hereon for public usage by Lincoln County, it's heirs and assigns and to the various utility companies as necessary for their usage.

D.C. DAY
 FAY DAY
 OWNERS

- LEGEND:
- SET 5/8" REBAR, P.L.S. 6498
 - FOUND 5/8" REBAR, P.L.S. 6498

ACKNOWLEDGEMENT

STATE OF NEVADA
 COUNTY OF LINCOLN ss

On this 8 day of February, 1996, D.C. DAY and FAY DAY appeared before me and acknowledged to me that they did approve and did execute the above instrument.

NOTARY PUBLIC: Edith M. Grover My commission expires Dec. 26, 1996

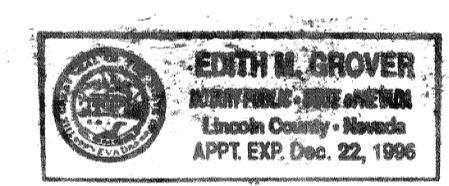

APPROVALS

This is to certify that the Planning Commission in and for Lincoln County, Nevada, on this 12 day of FEB, 1996, did approve for the purposes of land division and accept in behalf of the public this map and any parcels of land offered for dedication for public use in conformity with the terms of the offer of dedication per Section 278 of the Nevada Revised Statutes.

Chairman

Approved this 27th day of March, 1996, by the Lincoln County Commission as a Parcel Map.

Chairman

Attest: Clerk

Frank C. Hulse
 April 5, 1996
 40 MINUTES
 Plat A
 479
 Yuriko Setzer
 Leslie Boucher, Deputy

REFERENCE: PLAT A PAGE 131
 LINCOLN COUNTY NEVADA

ASSESSOR'S PARCEL NO. 10-161-07

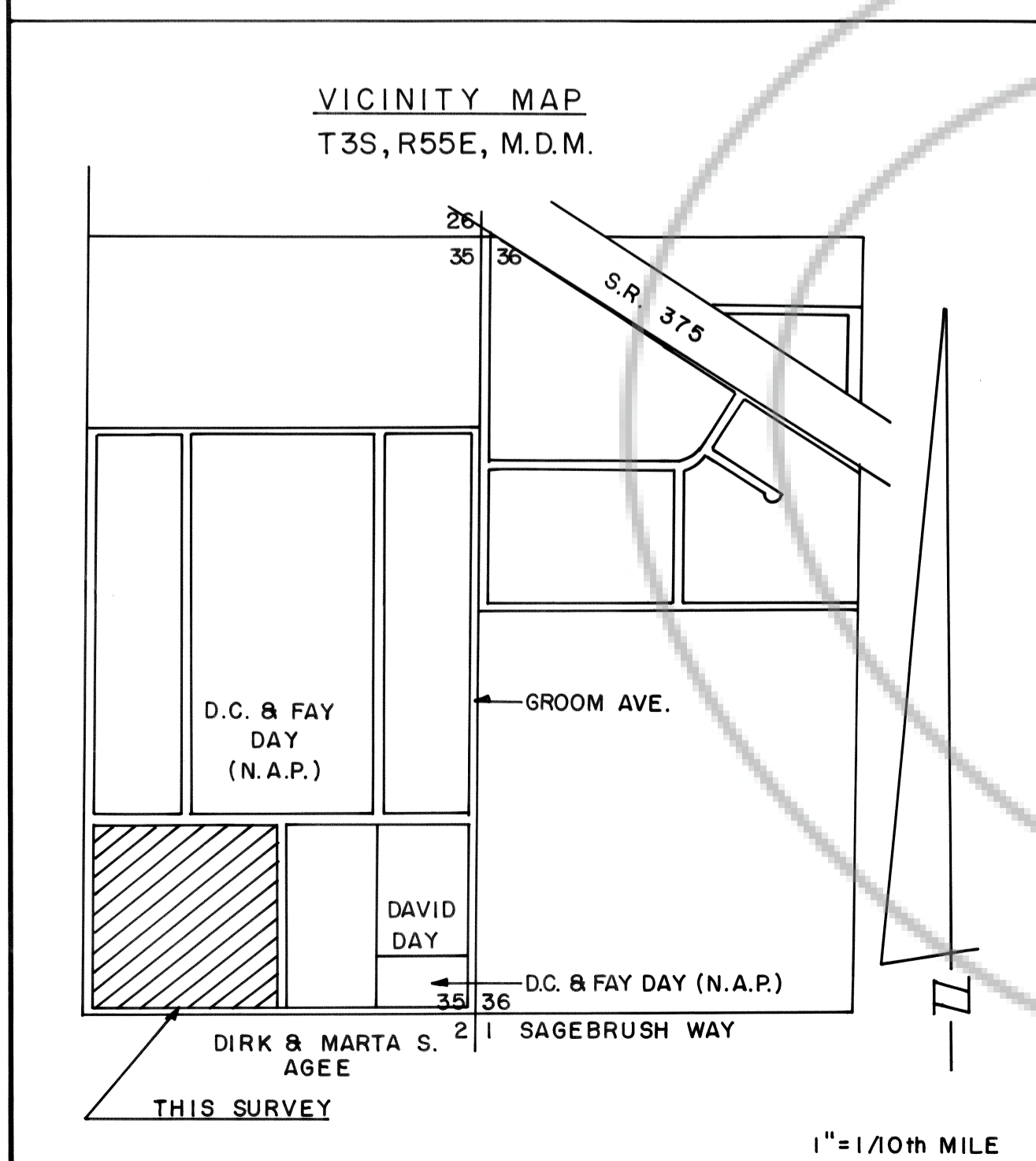
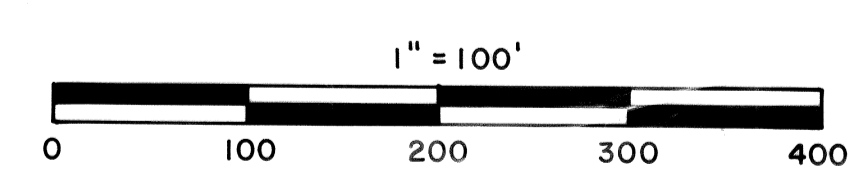

SUBSEQUENT PARCEL MAP OF THE SW1/4 OF THE SE1/4 OF SEC. 35, T3S, R55E, M.D.M. PREPARED AT THE INSTANCE OF D.C. DAY AND FAY DAY.