

SURVEYOR'S CERTIFICATE

I, James J. Owens, a Professional Land Surveyor registered in the State of Nevada, certify that:

- This plat represents the results of a survey conducted under my direct supervision at the instance of Ray Thompson, owner.
- The lands surveyed lie within Sec 21, T. 3 S., R. 67 E., M.D.M., Lincoln County, Nevada, and the survey was completed on the 7 of Sept., 1995.
- This plat complies with the applicable state statutes and any local ordinances in effect on the date that the Governing Body gave its final approval.
- The monuments depicted on the plat are of the character shown, occupy the positions indicated and are of sufficient number and durability.

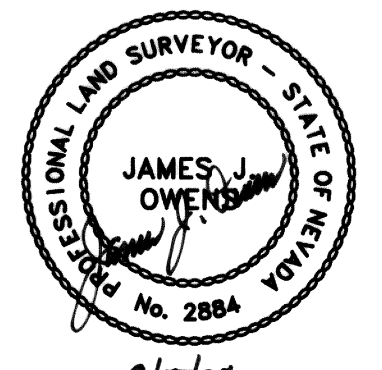

James J. Owens
Professional Land Surveyor
Nevada Certificate No. 2884

REFERENCE MAPS

- 1973 G.L.O. Dependent Resurvey of T. 3 S., R. 67 E., M.D.M.
- Nevada State Hwy Right of Way Map for U.S. 93 - Property Schedule dated June 1958.

BASIS OF BEARING

The Basis of Bearing is N. 89°52'00" W. being the South Line of Sec. 21, T. 3 S., R. 67 E., as shown on Bureau of Land Management Dependent Resurvey dated Sept. 6, 1973.

STATEMENT

Any subsequent changes to this map should be examined and may be determined by reference to the County Recorder's Cumulative Map Index, NRS 278.5635.

LEGEND

- ✕ 5/8" Iron w/ Plastic cap marked JOWENS/plat 2884
- Found Witness Corner - G.L.O. Brass Cap
- Hwy R.O.W. Marker Brass Cap
- Found G.L.O. Brass Cap - Sec. Corner
- Found E/W G.L.O. Brass Cap - 1/4 Sec. Corner
- Found N/S G.L.O. Brass Cap - 1/4 Sec. Corner
- Found E/W G.L.O. Brass Cap 1/4 Sec. Corner
- Sec. Line
- - - 1/4 Sec. Line
- - - 1/16 Sec. Line

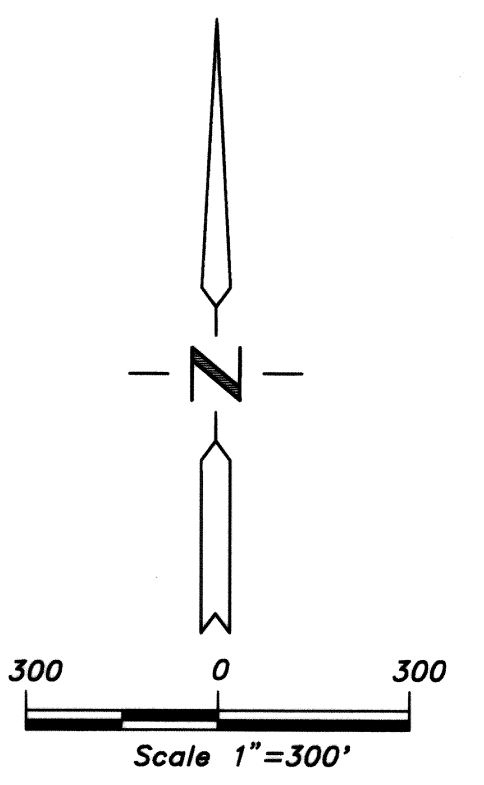

THIS SURVEY IS VOID

AMENDED

RECORD OF SURVEY
for
Ray Thompson
Sited in Sec 21, T. 3 S., R. 67 E., M.D.M.,
Lincoln County, Nevada

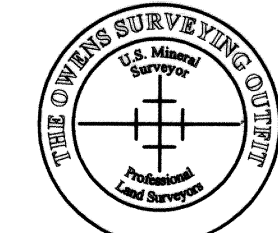

THE OWENS SURVEYING OUTFIT
Project Mineral, Land Surveying Throughout the West
P.O. Box 1330
110 N. Mesquite Blvd, Suite G
Mesquite, Nevada 89024
(702) 346-2930

Nav-375
J. JENSEN

No. **104551**
Filed at the request of
THE OWENS SURVEYING OUTFIT
Date **01-11-96** At **2:45 p.m.**
File _____ Page **416**
of Survey Maps
Official Records Book No. **Plat A**
Lincoln County, Nevada Records
Yuriko Setzer, Recorder
Fee **17.00** Deputy **Baucher**

No. **104163**
Filed at the request of
THE OWENS SURVEYING OUTFIT
Date **10-30-95** At **8:07 p.m.**
File _____ Page **456**
of Survey Maps
Official Records Book No. **Plat A**
Clark County, Nevada Records
Yuriko Setzer, Recorder
Fee **17.00** Deputy **Baucher**