

APPROVALS

This is to certify that the Planning Commission in and for Lincoln County, Nevada, on this 4 day of August, 1995, did approve for the purposes of land division and accept in behalf of the public this map and any parcels of land offered for dedication for public use in conformity with the terms of the offer of dedication per Section 278 of the Nevada Revised Statutes.

Val E. Washburn  
Chairman

Approved this 20<sup>th</sup> day of June, 1995, by the Lincoln County Commission, as a Parcel Map.

Edward E. Wright  
Chairman

Attest: Connie Hogan  
Clerk

LEGEND:  
Ø SET 5/8" REBAR, P.L.S. 6498

SURVEYOR'S STATEMENT

FRANK C. HULSE states that he is a Professional Land Surveyor within the State of Nevada and that this Parcel Map, consisting of one sheet, accurately and completely delineates the survey made by him and completed on the 18th day of May, 1995. This map has been prepared at the instance of D.C. DAY and FAY DAY, Owners. All monuments are of the character and occupy the positions shown hereon and are sufficient to enable the survey to be retraced. This survey conforms to the definitions and provisions of N.R.S. 278.471 thru 278.4725, inclusive.

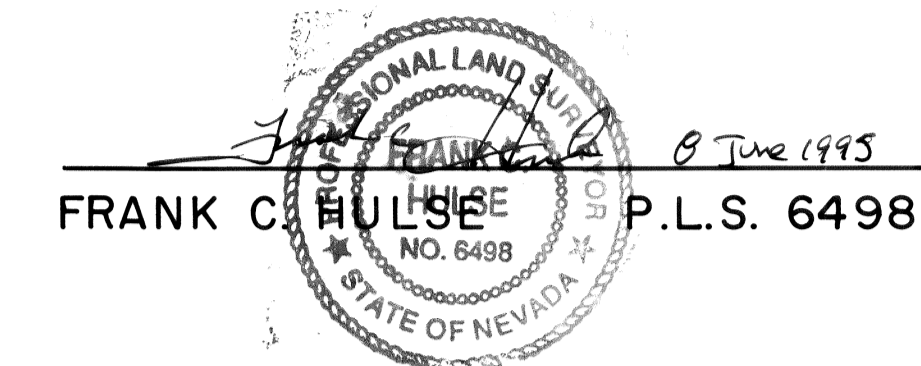

OWNER'S CERTIFICATE

We, D.C. DAY AND FAY DAY, do hereby certify that we are the owners of the land shown hereon and consent to the preparation and recordation of this Parcel Map showing the land plotted into parcels and that it conforms to the provisions of N.R.S. 278.471 to 278.4725, inclusive. We also offer for dedication the roads and multiple use easements as shown hereon for public usage by Lincoln County, it's heirs and assigns and to the various utility companies as necessary for their usage.

D.C. Day OWNERS Fay Day  
D.C. DAY FAY DAY

ACKNOWLEDGEMENT

STATE OF Nevada  
COUNTY OF Lincoln ss  
On this 8<sup>th</sup> day of June, 1995, D.C. DAY and FAY DAY appeared before me and acknowledged to me that they did approve and did execute the above instrument.

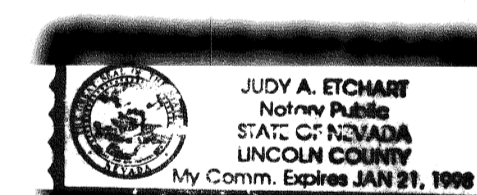

Judy A. Etchart  
Notary Public

My commission expires 1-21-98.

104221  
I, Frank Hulse  
November 7, 1995  
Notary Public  
Juriko Setzer  
County Recorder  
Judith Boucher, Deputy

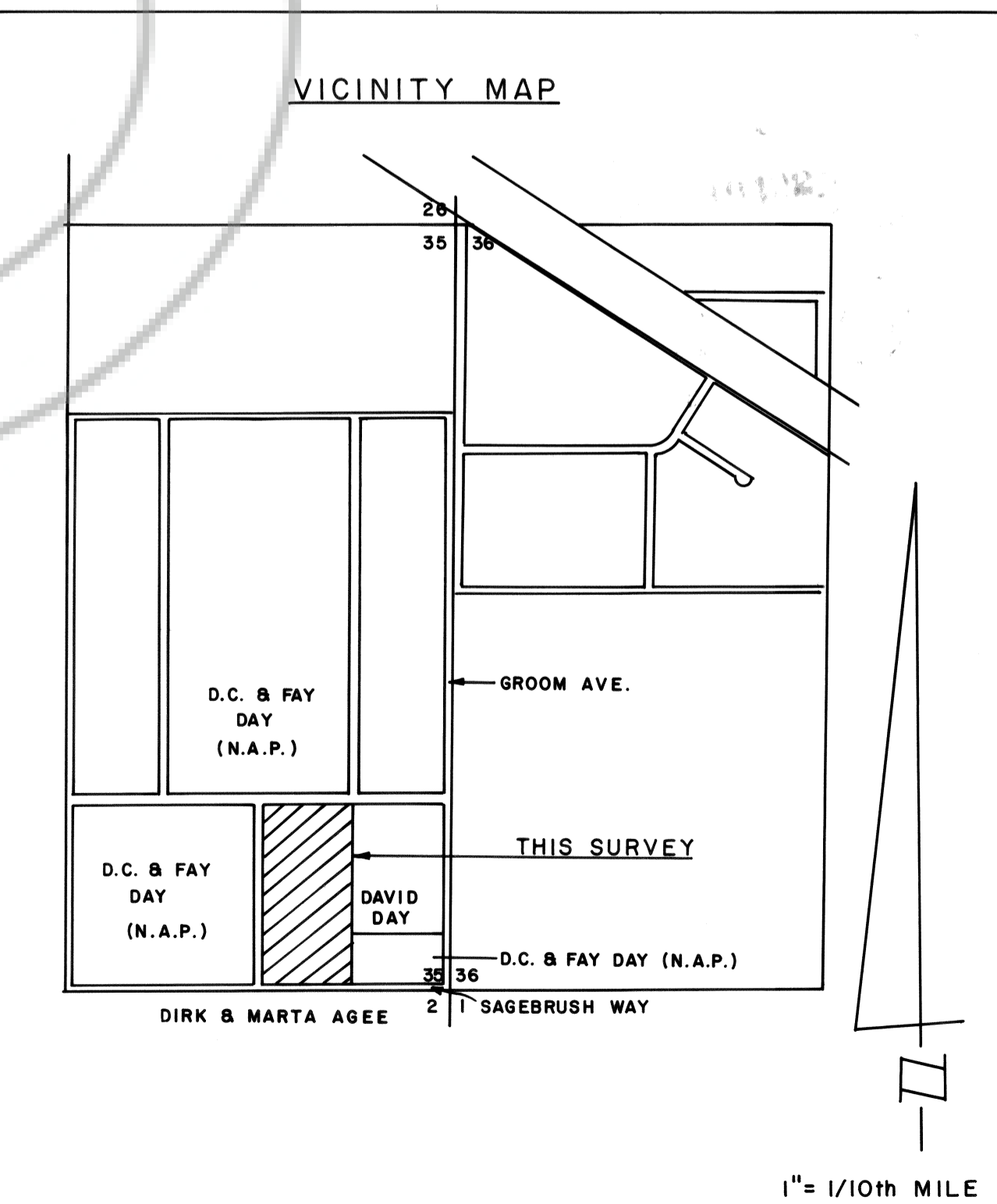
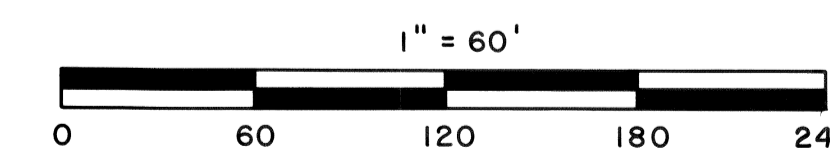

1" = 1/10th MILE

SUBSEQUENT

PARCEL MAP OF THE W1/2 SE1/4  
SE1/4 OF SECTION 35, T3S, R55E,  
M.D.M. PREPARED AT THE INSTANCE  
OF D.C. DAY AND FAY DAY, OWNERS.