

Lincoln County

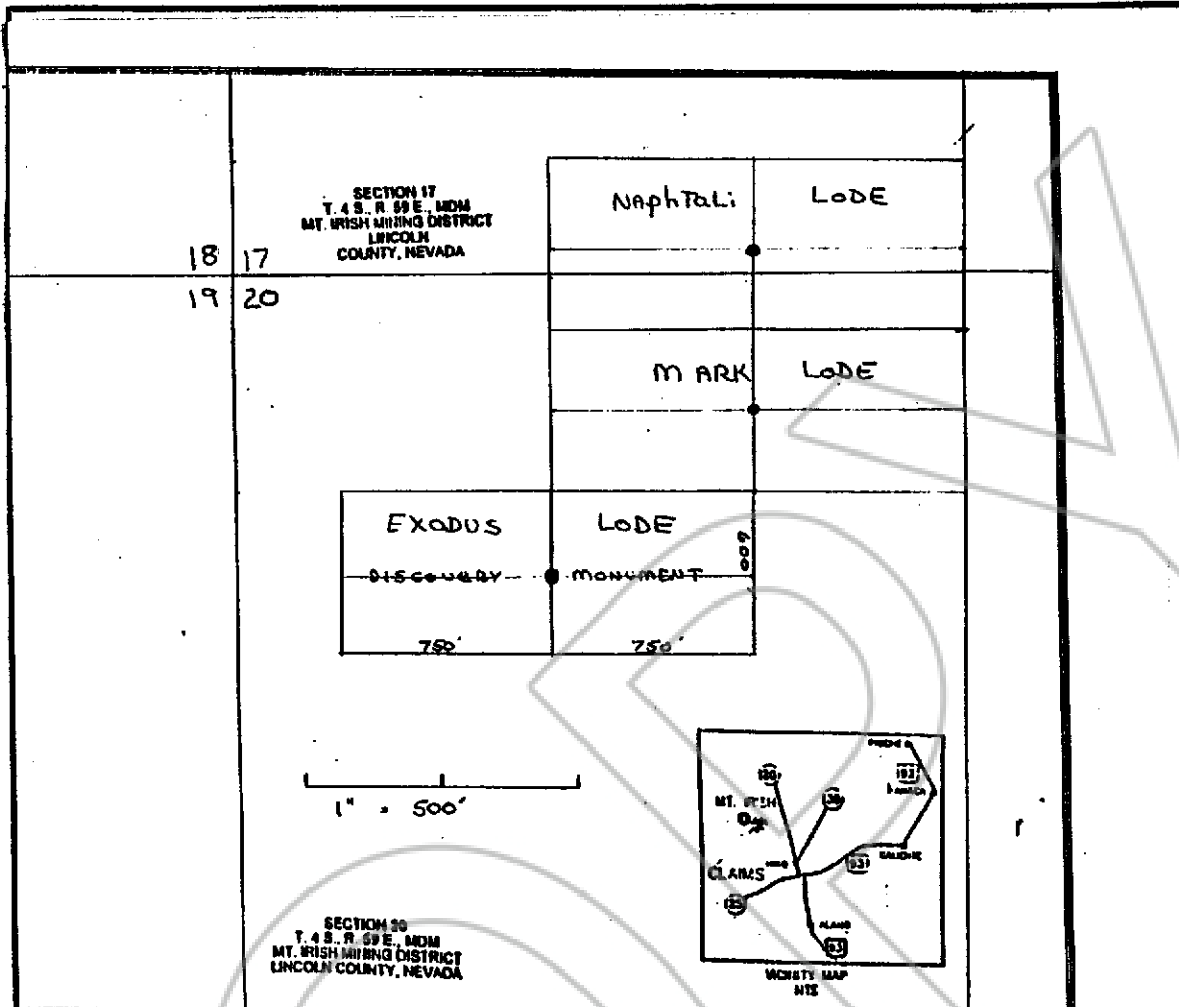

Describe here the position of the Claim Location Monument, if one is used.

Map of the EXODUS Mining Claim Group,

in Section <sup>NW 1/4</sup> 20 Township, 4 Range 59,

in the MOUNT IRISH Mining District,  
LINCOLN County, Nevada.

Located on the 11 day of Sept, 1985, by

MARK Gilcrest For

Locator name and address (please print)  
CAPITAUX Nevada Corp

2211 Paradise Road

Las Vegas NV 89104

CARLSIE FORM NO. 58 1-T

RECORDER'S STAMP

NO 104025

Filed and recorded at the request of Capitaux Nevada Corp. on October 5, 1995 at 20 minutes past 9 o'clock a.m. in Book 115, Page 312, Official Records, Lincoln County Nevada.

Yuriko Setzer Recorder

by Julie Boucher Deputy