

Lincoln County

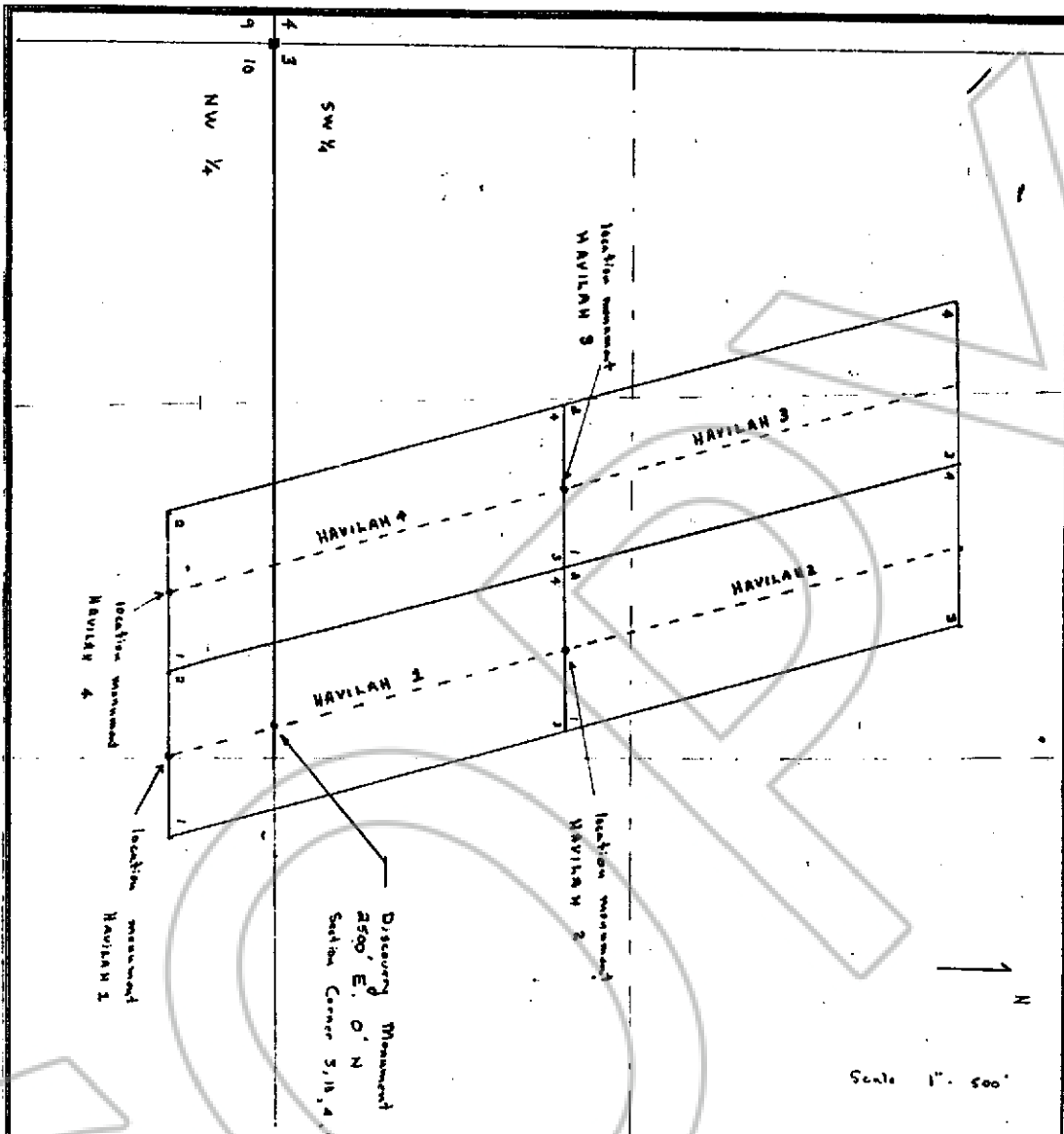

Describe here the position of the Claim Location Monument, if one is used.

Map of the HAVILAH Mining Claim Group,

in Section 34 10 Township 45 Range 69 E,
 in the unknown Mining District,
Lincoln County, Nevada.

Located on the 27 day of September, 1995, by

Jay R. Leavitt
 Locator name and address (please print)

Jay R. Leavitt
P.O. Box 4

Gunlock, Ut. 84733

CARLISLE FORM NO. 58 N-T

RECORDER'S STAMP

104005

FILED AND RECORDED AT REQUEST OF
Jay R. Leavitt

October 2, 1995

20 MINUTES EAST 12 CYCLES

2.11 IN BOOK 115 OF OFFICIAL

RECORDS, PAGE 266 LINCOLN
 COUNTY, NEVADA.

Yuriko Setzer

By Lelia Boucher deputy

BOOK **115** PAGE **266**