

**SURVEYOR'S CERTIFICATE**

I, James J. Owens, a Professional Land Surveyor registered in the State of Nevada, certify that:

- This plat represents the results of a survey conducted under my direct supervision at the instance of Ronal Young and Betty Young, owners.
- The lands surveyed lie within Sec 7, T. 4 S., R. 67 E., M.D.M., City of Caliente, Lincoln County, Nevada, and the survey was completed on the 23 of May, 1995.
- This plat complies with the applicable state statutes and any local ordinances in effect on the date that the Governing Body gave its final approval.
- The monuments depicted on the plat are of the character shown, occupy the positions indicated and are of sufficient number and durability.

James J. Owens  
Professional Land Surveyor  
Nevada Certificate No. 2884

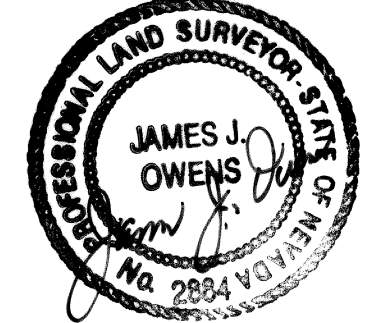

**OWNER'S CERTIFICATE**

We, Ronal Young and Betty Young, do hereby certify that being the owners of the land hereon shown, have caused this property to be platted into parcels, and easements as shown, and do hereby dedicate all shown public utility easements to the public utility agencies for the construction and maintenance of surface and subterranean utilities, and do hereby consent to the preparation and recordation of this parcel map.

Ronal Young 6-9-95  
Date

Betty Young 6-9-95  
Date

**ACKNOWLEDGEMENT**

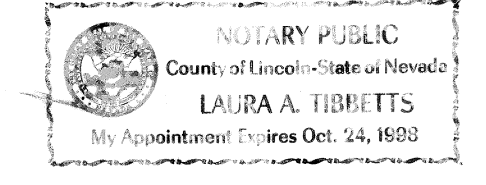

STATE OF NEVADA SS  
LINCOLN COUNTY

On this 09 day of June, 1995, personally appeared before me, a Notary Public in and for said County and State, Ronal and Betty Young owners, known to me to be the persons described in and who executed the foregoing instrument freely and voluntarily and for the uses and purposes therein mentioned.

Laura A. Tibbitts  
Notary Public in and for said County and State  
My appointment expires 10-24-98

**ZONING AND PLANNING APPROVAL**

This is to certify that the Director of Zoning and Comprehensive Planning, City of Caliente, did on this day of 1995, approve for purposes of land division and accept in behalf of the public, this map and any parcels of land offered for dedication for public use in conformity with the terms of the offer of dedication as per NRS 278.010 through 278.630

Director  
Zoning and Comprehensive Planning, City of Caliente

**CITY OF CALIENTE APPROVAL**

Approved this 5th day of JUNE, 1995 by the City of Caliente as a Parcel Map.

Mayor  
Attest: Clerk

**REFERENCE MAPS**

- 1881 G.L.O. Survey of T. 4 S., R. 67 E., M.D.M.
- 1934 G.L.O. Independent Resurvey of T. 4 S., R. 67 E., M.D.M.
- Plat Book A, Page 434, Official Record, Lincoln County, Nevada.

**BASIS OF BEARING**

Bearing between points as shown from recorded Parcel Map by Fonger Survey; Document No. 85389, Plat Book A, Page 263

**STATEMENT**

Any subsequent changes to this map should be examined and may be determined by reference to the County Recorder's Cumulative Map Index, NRS 278.5695.

**LEGEND**

- o Found original pipe corner monuments
- ⊙ Found G.L.O. Brass - Sec. Corner.
- Found rebar w/cap marked 6204

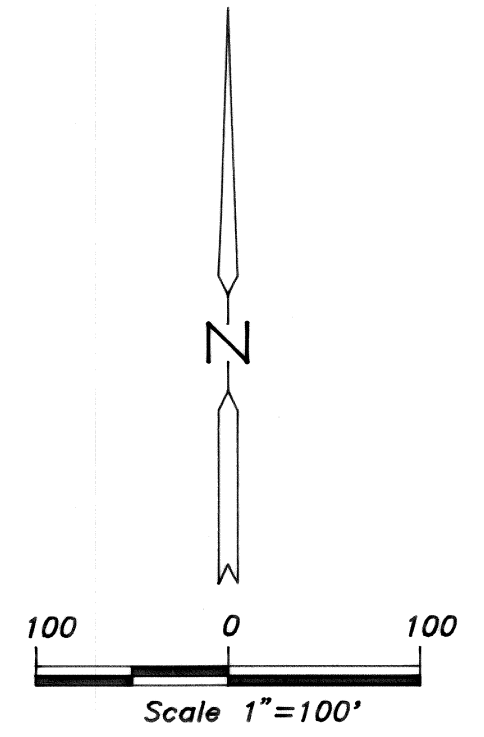

<p><b>PARCEL MAP</b> for <b>Ronal &amp; Betty Young</b> A Division of Parcel 4 located in the SW 1/4 NE 1/4, NW 1/4 SE 1/4 of Sec. 7, T. 4 S., R. 67 E., M.D.M., City of Caliente, Lincoln County, Nevada</p>	No.: 103645 Filed at the request of THE OWENS SURVEYING OUTFIT: Date: June 20, 1995 File: Page 447 Of Parcel Maps Official Records Book No. 104A Lincoln County, Nevada Records Yuriko Seizer, Recorder Fee: Deputy: Boucher
	<p><b>THE OWENS SURVEYING OUTFIT</b> Project: Mineral, Land Surveying throughout the West P.O. Box 1330 110 N. Mesquite Blvd. Suite G Mesquite, Nevada 89024 (702) 346-2930</p>