

**RIGHT-OF WAY EASEMENT**

**KNOW ALL MEN BY THESE PRESENTS**, that **Keith Lopeman** of Las Vegas, Nevada the undersigned, for a good and valuable consideration, the receipt whereof is hereby acknowledged, do hereby grant unto **LINCOLN COUNTY POWER DISTRICT NO. 1**, a municipal corporation of the State of Nevada, whose post office is Pioche, Nevada, and to its successors or assigns, the right to enter upon the lands and premises of the undersigned, situated in the County of Lincoln, State of Nevada, and more particularly described as follows:

A strip of land 20.00 feet wide, 10.00 feet each side of centerline, situated within Lincoln County Assesor Parcel No. 13-120-06, in the SE.1/4 NE.1/4 of Section 9, T.4S., R.67E., M.D.M., Lincoln County, Nevada, being more particularly described as follows:

Beginning at a point of intersection of said centerline of power line easement and the westerly boundary of said Parcel No. 13-120-06, said point being Station 70+64.15, whence the W.1/4 Corner of said Section 9 bears S. 82 degrees 39 minutes 47 seconds E. a distance of 3,872.79 feet; Thence N. 88 degrees 07 minutes 42 seconds E. a distance of 5.31 feet to Station 70+69.46, a point of intersection; Thence N. 60 degrees 28 minutes 28 seconds E. a distance of 350.39 feet to Station 74+19.85, a point of intersection; Thence N. 09 degrees 31 minutes 11 seconds W. a distance of 339.53 feet to Station 77+59.38, the end of said centerline of power line easement and the terminus of this easement, whence the W.1/4 Corner of said Section 9 bears S. 76 degrees 14 minutes 49 seconds W. a distance of 4,216.00 feet. Including a 20.00 foot wide Guy Wire Easement that extends S. 13 degrees 50 minutes 17 seconds E. a distance of 35.00 feet from Station 70+69.46; including a 20.00 foot wide Guy Wire Easement that extends N. 09 degrees 31 minutes 11 seconds W. a distance of 35.00 feet from Station 77+59.38.

and to construct, reconstruct, rephase, repair, operate and maintain on the above described lands and/or in or upon all streets, roads or highways abutting said lands, an electric transmission and/or distribution line or system; to cut, trim and control the growth by chemical means, machinery or otherwise of trees and shrubbery located within ten (10) feet each side of the center line of said overhead power line or system, or that may interfere with or threaten to endanger the operation and maintenance of said line or system (including any control of the growth of other vegetation in the right-of-way which may incidentally and necessarily result from the means of control employed); and to license, permit, or otherwise agree to the joint use of occupancy of that line or system by any other person, association or corporation, for electrifications or telephone purposes.

The undersigned agree that all poles, wires and other facilities including any main service entrance equipment, installed on the above described lands at the District's expense shall remain

the property of the District, removable at the option of the District, upon termination of services to or on said lands.

The undersigned covenant that they are the owners of the above described lands. (and that the said lands are free and clear of encumbrances and liens of whatsoever character except those held by the following persons:)

IN WITNESS WHEREOF, the undersigned have set their hands and seals this 16 day of JULY, 1993.

Keith Lopeman  
Keith Lopeman

State of Nevada )  
County of Clay ) ss.  
Lincoln )

The foregoing instrument was acknowledged before me this 16<sup>th</sup> day of July, 1993, by Keith Lopeman for Keith Lopeman

Witness my hand and official seal.

Dorothy M. Corneios  
Notary Public



Dorothy M. Corneios  
Notary Public, State of Nevada  
CLARK COUNTY  
My Appointment Expires Sept. 5, 1994

**SURVEYOR'S CERTIFICATE**

I, James J. Owens, hereby certify that this survey was made under my direct supervision and represents a field survey as shown on this map and is true and correct to the best of my knowledge and belief and was completed on May 20, 1992.

James J. Owens  
Professional Land Surveyor  
Nevada Certificate No. 2884

**LEGAL DESCRIPTION OF CENTERLINE OF PROPOSED POWER LINE EASEMENT**

A strip of land 20.00 feet wide, 10.00 feet each side of centerline, situated within Lincoln County Assessor Parcel No. 13-120-06, in the SE 1/4 NE 1/4 of Section 9, T.4 S., R.67 E., M.D.M., Lincoln County, Nevada, being more particularly described as follows:

Beginning at a point of intersection of said centerline of power line easement and the westerly boundary of said Parcel 13-120-06, said point being Station 70-6415, whence the W 1/4 corner of said Section 9 bears S. 82° 39' 47" E. a distance of 3672.79 feet, Thence N. 88° 07' 42" E. a distance of 5.31 feet to Station 70-69.46, a Point of Intersection, Thence N. 60° 28' 28" E. a distance of 350.39 feet to Station 74-19.85, a Point of Intersection, Thence N. 09° 31' 11" W. a distance of 339.53 feet to Station 77-59.38, the end of said centerline of power line easement and the terminus of this easement, whence the W 1/4 corner of said Section 9 bears S. 76° 14' 49" W. a distance of 4216.00 feet, including a 20.00 feet wide Guy Wire Easement that extends S. 13° 50' 17" E. a distance of 35.00 feet from Station 70-69.46, including a 20.00 feet wide Guy Wire Easement that extends N. 09° 31' 11" W. a distance of 35.00 feet from Station 77-59.38.

W 1/4 Corner Sec. 9  
T.4 S., R.67 E.,  
M.D.M.

SE 1/4 NE 1/4 Sec. 9  
PARCEL 13-120-06  
Keith Lopeman

CENTERLINE OF 2' WIDE PROPOSED POWER LINE EASEMENT

WIRE EASEMENT

Station 77-59.38 (End of Line)

Station 74-19.85 (P.I.)  
Existing Transformer Pole  
Structure

103496

FILED AND RECORDED AT REQUEST OF  
L. C. Power District No. 1  
May 18, 1995  
AT 15 MINUTES PAST 10 O'CLOCK  
A.M. IN BOOK 113 OF OFFICIAL  
RECORDS, PAGE 497 LINCOLN COUNTY, NEVADA.  
Yuriko Setzer  
Deputy

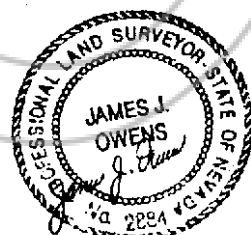

0' 100'  
SCALE 1"=100'

Job No. NEV-497 Lincoln Co. Power District  
**MAP OF POWER LINE EASEMENT**  
Crossing the Lands of  
Keith Lopeman  
Situated in the SE 1/4 NE 1/4 of  
Section 9, T.4 S., R.67 E., M.D.M.,  
Lincoln County, Nevada