

1 CASE NO. 17-4 9512
2 DEPT. NO. _____

FILED
1995 APR 10 10 59
[Handwritten Signature]

6 **IN THE SEVENTH JUDICIAL DISTRICT COURT OF THE STATE OF NEVADA**
7 **IN AND FOR THE COUNTY OF LINCOLN**

9 **RONALD J. and LOUISE PALMER,**
10 **Plaintiffs,**

11 vs.

**NOTICE OF PENDENCY OF ACTION
TO QUIET TITLE**

12 **DAN and CONNIE SIMKINS, GROVER**
13 **and BROOKIE SWALLOW, WILLIAM F.**
14 **and NORMA JEAN WALKER, and**
15 **NANCY ESCOBEDO FAMILY TRUST,**
16 **and all other unknown persons, partnerships or**
17 **corporations claiming any rights, title, estate,**
lien or an interest in the real property
described in the Complaint adverse to
Plaintiff's ownership or any cloud upon
Plaintiff's title thereto,
18 **Defendants.**

20 NOTICE IS HEREBY GIVEN that an action has been commenced in the above-entitled
21 Court by the above-named Plaintiffs against the above-named Defendants to quiet the title to the
22 premises and real estate in the Complaint in the said action, and hereinafter described and to
23 determine all and every claim, estate or interest therein of said Defendants or any of them, adverse to

24 ///
25 ///
26 ///
27 ///
28 ///

1 said Plaintiff, and the premises affected by this suit are situated in the County of Lincoln, State of
2 Nevada, and are more particularly described as follows: to wit:

3 See attached Exhibit "A" for legal description.

4 DATED this 2nd day of April, 1995

5
6 
7 **DAVID D. LOREMAN**
8 Attorney for Plaintiffs
9
10
11
12
13
14
15
16
17
18
19
20
21
22
23
24
25
26
27
28

EXHIBIT "A"

CHAIN OF TITLE ON THE FOLLOWING
PROPERTY HIGHLIGHTED IN YELLOW AND SITUATED
IN THE NORTH HALF OF BLOCK 19TH OR NEAR THE
TOWN OF PANACA LINCOLN COUNTY, NEVADA.

(Said Chain of title is started from January
1 1950 down to February 1, 1995.

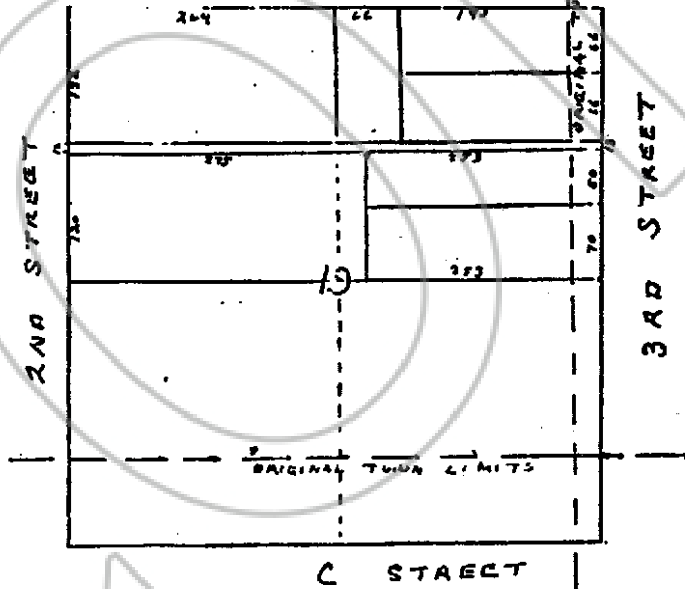

- This is not an exact map -

Lincoln County

Lincoln County

GRANT, BARGAIN, SALE deed

THIS INSTRUMENT WITNESSETH: That JOSEPH and EVELYN DECARLO, Husband and Wife, in consideration of \$7,000.00, the receipt of which is hereby acknowledged, do hereby Grant, Bargain, Sell and Convey to RONALD J. and LOUISE PALMER, Husband and Wife, as joint tenants with right of survivorship, all that real property situate in the Town of Panaca, County of Lincoln, State of Nevada, bounded and described as follows:

A parcel of land situate within the SE 1/4 of the SE 1/4 of Section 5, and also the SW 1/4 of the SW 1/4 of Section 4, all Township 2 South, Range 68 East, Mount Diablo Meridian, subject parcel being that portion of Lots 1 & 2, of Block 19, between 3rd Street on the East, and 2nd Street on the West, of Panaca Nevada Townsite, being more particularly described as follows:

Beginning at the Northeast Corner of this parcel from which the Northeast Corner of said Block 19 of Panaca Townsite bears N 00° 51' 34" E a distance of 132.00 feet; thence S 00° 51' 34" W along the Westerly boundary of 3rd Street a distance of 12.00 feet, to the Southeast Corner; thence N 89° 32' 39" W a distance of 528.00 feet to the Southwest Corner; thence N 00° 51' 34" E along the Easterly boundary of 2nd Street a distance of 12.00 feet to the Northwest Corner; thence S 89° 32' 39" E a distance of 528.00 feet to the Northeast Corner; which is the point of beginning.

Said parcel contains 6,336.00 square feet or 1455 acres, more or less.

- SUBJECT TO: 1. Taxes for the fiscal year
2. Rights of way, reservations, restrictions, easements and conditions of record.

15 Apr 1994
ack v
Recorded v

APN-02-043-12

BOOK 113 PAGE 153

REC 109 MAR 29 1994

COPY

103367

FILED AND RECORDED AT REQUEST OF
DAVID D. LOREMAN

APRIL 24, 1995

PLAT 01 LAMAR PARCELS 2-000000
PARTITION 113

SECTION 155
COUNTY, MISSOURI

YURIKO SETZER

BY *Yvonne Boucher* DEPUTY