

SURVEYOR'S CERTIFICATE

I, James J. Owens, a Professional Land Surveyor registered in the State of Nevada, certify that:

1. This plat represents the results of a survey conducted under my direct supervision at the instance of Town of Plache - Lincoln County, Sandra Sears, Tom Smith & Peggy Smith owners.
2. The lands surveyed lie within Lots 3,4,5,6, & 7 of Block 5, Town of Plache, Lincoln County, Nevada, and the survey was completed on 13 of July, 1994.
3. This plat complies with the applicable state statutes and any local ordinances.
4. The monuments depicted on the plat are of the character shown and occupy the positions indicated, and are of sufficient number and durability.

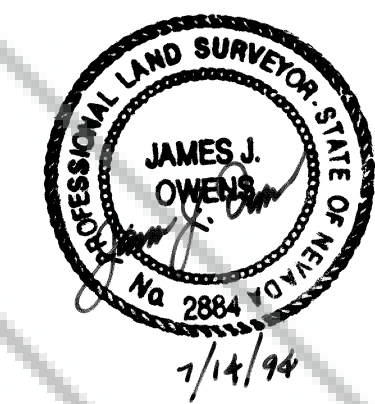

James J. Owens
Professional Land Surveyor
Nevada Certificate No. 2884

OWNER'S CERTIFICATE

I, Eve Culverwell, Chairman, Lincoln County Commissioners, do hereby certify that Lincoln County is the sole owner of Lots 1, 2, and 3, Block 5, Town of Plache, APN 01-065-18, and that I am in agreement with the adjustment of the common boundary between Lots 3 and 4 of said Block 5; and that I have examined this Plat and approve it as represented and authorize the recordation thereof.

Eve Culverwell

Date

ACKNOWLEDGEMENT

STATE OF NEVADA SS
COUNTY OF LINCOLN

On this _____ day of _____, 1994, personally appeared before me, a Notary Public in and for said County and State, Eve Culverwell, Chairman, Lincoln County Commissioners, known to me to be the person described in and who executed the foregoing instrument, and for the uses and purposes therein mentioned.

Notary Public in and for said County and State,
My appointment expires _____

OWNER'S CERTIFICATE

I, Sandra Sears, do hereby certify that I am the sole owner of Lots 4, 5 and 6, Block 5, Town of Plache, APN 01-065-02, and that I am in agreement with the adjustment of the common boundary between Lot 3 and 4 and 6 and 7 of said Block 5, and that I have examined this Plat and approve it as represented and authorize the recordation thereof.

I further certify that all property taxes for the fiscal year have been paid; and any lender with an Impound account has been notified of the adjustment of the boundary line on the transfer of land.

Sandra Sears
Sandra Sears

8/15/94
Date

ACKNOWLEDGEMENT

STATE OF NEVADA SS
COUNTY OF CLARK

On this 15 day of Aug, 1994, personally appeared before me, a Notary Public in and for said County and State, Sandra Sears, known to me to be the person described in and who executed the foregoing instrument, and for the uses and purposes therein mentioned.

Betina McCrosky
Betina McCrosky

Notary Public in and for said County and State,
My appointment expires 7/3/96

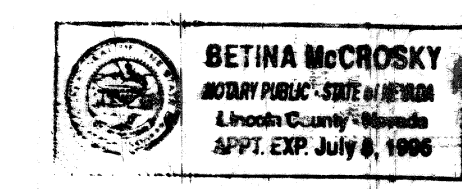

LEGEND

- Set 5/8" rebar w/ plastic cap marked "OWENS RLS 2884".
- ⊙ Bullcock Bros. FK nail w/ Washer.
- Chain-Link Fence
- ▨ Adjusted Area

BASIS OF BEARING

Main Street Map of Survey of Town of Plache as recorded on Plat A Page 38.2.

REFERENCE MAPS

1. Survey of Town of Plache.
2. Record of Survey Plat A Page 38.2.

LEGAL DESCRIPTION

Lincoln County APN 01-065-018;
South 5.50 feet of Lot 4 Block 5 Town of Plache.

LEGAL DESCRIPTION

Sandra Sears APN 01-065-02;
Lot 4 less the South 5.50 feet thereof, Lot 5, Lot 6 and the South 7 feet Lot 7 Block 5 Town of Plache.

LEGAL DESCRIPTION

Tom Smith and Peggy Smith APN 01-065-03;
Lot 7 less the South 7 feet thereof Block 5 Town of Plache.

OWNER'S CERTIFICATE

We, Tom Smith and Peggy Smith, husband and wife, do hereby certify that we are the sole owner of Lots 7 and 8, Block 5, Town of Plache, APN 01-065-03, and that we are in agreement with the adjustment of the common boundary between Lots 6 and 7 of said Block 5; and that we have examined this Plat and approve it as represented and authorize the recordation thereof.

We further certify that all property taxes for the fiscal year have been paid; and any lender with an Impound account has been notified of the adjustment of the boundary line on the transfer of land.

Tom Smith 7/21/94 Date
Peggy Smith 7-20-94 Date

ACKNOWLEDGEMENT

STATE OF NEVADA SS
COUNTY OF NYE

On this 20 day of July, 1994, personally appeared before me, a Notary Public in and for said County and State, Tom Smith and Peggy Smith, husband and wife, known to me to be the person described in and who executed the foregoing instrument, and for the uses and purposes therein mentioned.

Anna Perchetti
Notary Public in and for said County and State,
My appointment expires 10/21/97

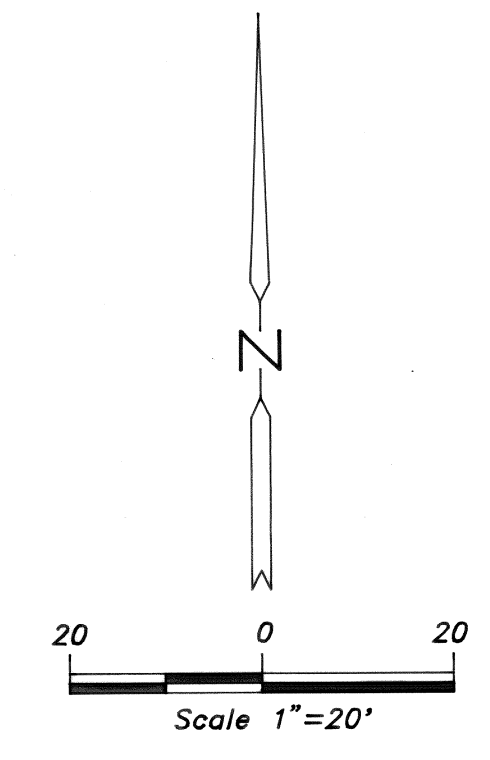
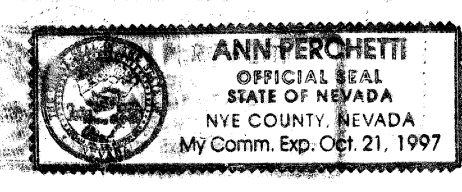

<p>Record of Survey Boundary Line Adjustment Town of Plache for Lincoln County, Sandra Sears, Tom Smith & Peggy Smith Situating in Lots 3,4,5,6 & 7 of Block 5, Town of Plache Lincoln County, Nevada</p>		<p>No. 104250 Filed at the request of THE OWENS SURVEYING OUTFIT: Date Aug 22, 1994 12:02 Plat A Page 426 Of Survey Maps Official Records Book Lincoln County, Nevada Records Yuriko Setzer Fee 17.00 Deputy <i>Boucher</i></p>
	<p>THE OWENS SURVEYING OUTFIT Project Mineral, Land Surveying throughout the West: P.O. Box 1330 110 N. Mesquite Blvd., Suite # 7 Mesquite, Nevada 89024 (702) 346-2930</p>	<p>Nav-295</p>