

T.6 S., R.61 E., M.D.M.  
T.7 S., R.61 E., M.D.M.

31 32  
6 5  
NW CORNER OF SEC. 5, T.7 S., R.61 E., M.D.M.  
FOUND REBAR WITH PLASTIC CAP MARKED  
K.J. BROWN R.L.S. 4685

N. 60° 47' 08" W.  
4499.34' L.T.R.

PARCEL 1 OF  
PARCEL MAP BOOK PLAT "A" PAGE 189  
04-141-04  
Floyd and Eleanor Lamb

20.00' Witness Corner Found Rebar and Cap RLS 4428  
S. 88° 30' 22" E.  
488.37' Found Rebar and Cap RLS 4428

PARCEL 3 OF  
PARCEL MAP BOOK PLAT "A" PAGE 189  
04-141-04  
Floyd and Eleanor Lamb

IRRIGATION CANAL  
N. 02° 46' 15" W.  
181.30'

2,000 ACRES  
PARCEL 2 OF PARCEL MAP  
BOOK PLAT "A" PAGE 189  
04-141-21

180.80'  
S. 01° 10' 39" W.  
U.S. HIGHWAY NO. 93  
RIGHT-OF-WAY

4019' Witness Corner Found Rebar and Cap RLS 4428  
EXISTING FENCE  
475.79'  
N. 88° 30' 22" W.

04-141-14  
Elwyn and Kae Robinson

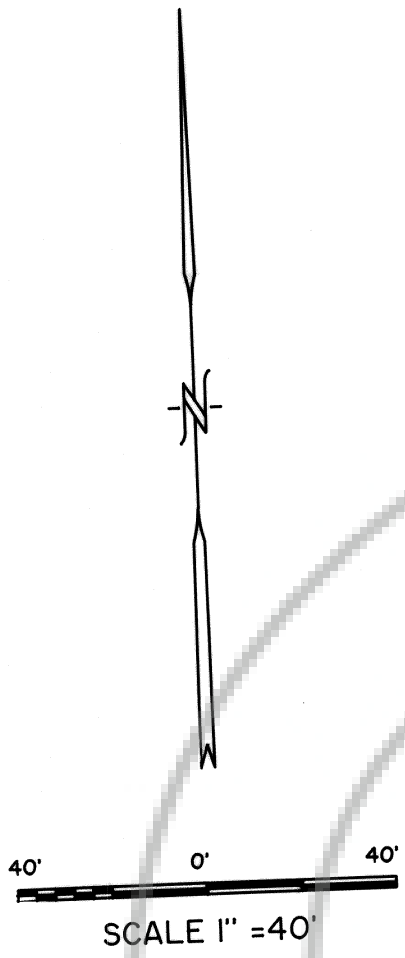

**SURVEYOR'S CERTIFICATE**

I, James J. Owens, a Professional Land Surveyor registered in the State of Nevada, hereby certify that this Record of Survey was made at the instance of Floyd R. Lamb; that all monuments are of the character as indicated and occupy the positions as shown and are sufficient to enable the survey to be retraced; that this survey conforms with the provisions of NRS 625.340 to 625.360 inclusive. This survey was completed on August 24, 1993

James J. Owens  
Professional Land Surveyor  
Nevada Certificate No. 2884

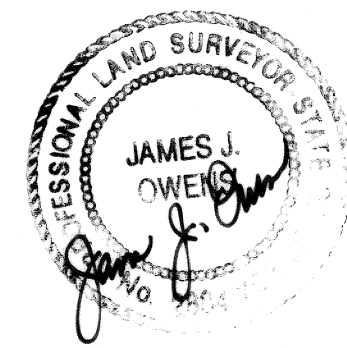

8/26/93

**REFERENCE MAPS**

1. MAP of the proposed Town Limits for Alamo, Nevada - Book Plat A Page 177.

**BASIS OF BEARING**

The Basis of Bearing is the west boundary of Section 5, T.7 S., R.61 E., M.D.M., as shown on Record of Survey Book Plat A, Page 177.

**STATEMENT**

Any subsequent changes to this map should be examined and may be determined by reference to the County Recorder's Cumulative Map Index. NRS 278.5695.

**LEGEND**

- Found rebar and cap marked RLS 4428
- Set 1/2" rebar with plastic cap marked PLS 2884.
- ⊙ Found Section Corner

**AMENDED**

RECORD OF SURVEY  
for

**FLOYD R. LAMB**

Parcel 2 of Parcel Map Plat "A" Page 189,  
situated within the SE 1/4 of Section 5, T.7 S., R.61 E., M.D.M.,  
Lincoln County, Nevada

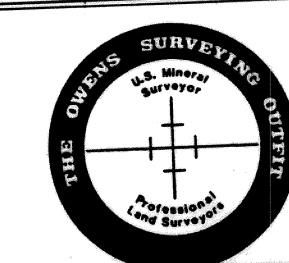

**THE OWENS SURVEYING OUTFIT**  
Project Mineral, Land Surveying throughout the west

P.O. Box 1330  
61 East Mesquite Blvd.  
Mesquite, Nevada 89024  
(702) 346-2930

No. **100898**  
Filed at the request of  
**JAMES OWENS**  
Date **SEPT. 9, 1993** At **4:55 P.M.**  
File **PLAT - A** Page **391**  
of Survey Maps  
Official Records Book No. **PLAT - A**  
Lincoln County, Nevada Recorder  
Yurko Setzer, Recorder  
*Yurko Setzer*  
Fey **000** Deputy