

THIS MAP IS TAKEN FROM UNITED STATES DEPT. OF THE INTERIOR  
 GEOLOGICAL SURVEY MAP OF WHITE BLOTCH SPRINGS, ALSO A 1987  
 MAP UPDATE FROM THE USGS  
 THE CHANGE IN ELEVATION IS 1000 FEET BETWEEN THE BLUEBIRD #4 AND  
 THE HIDDEN TREASURE #4  
 THIS IS UNSURVEYED LANDS BY BLM  
 MINING CLAIM PROCEDURES BY KEITH G. PAPKE THIRD EDITION

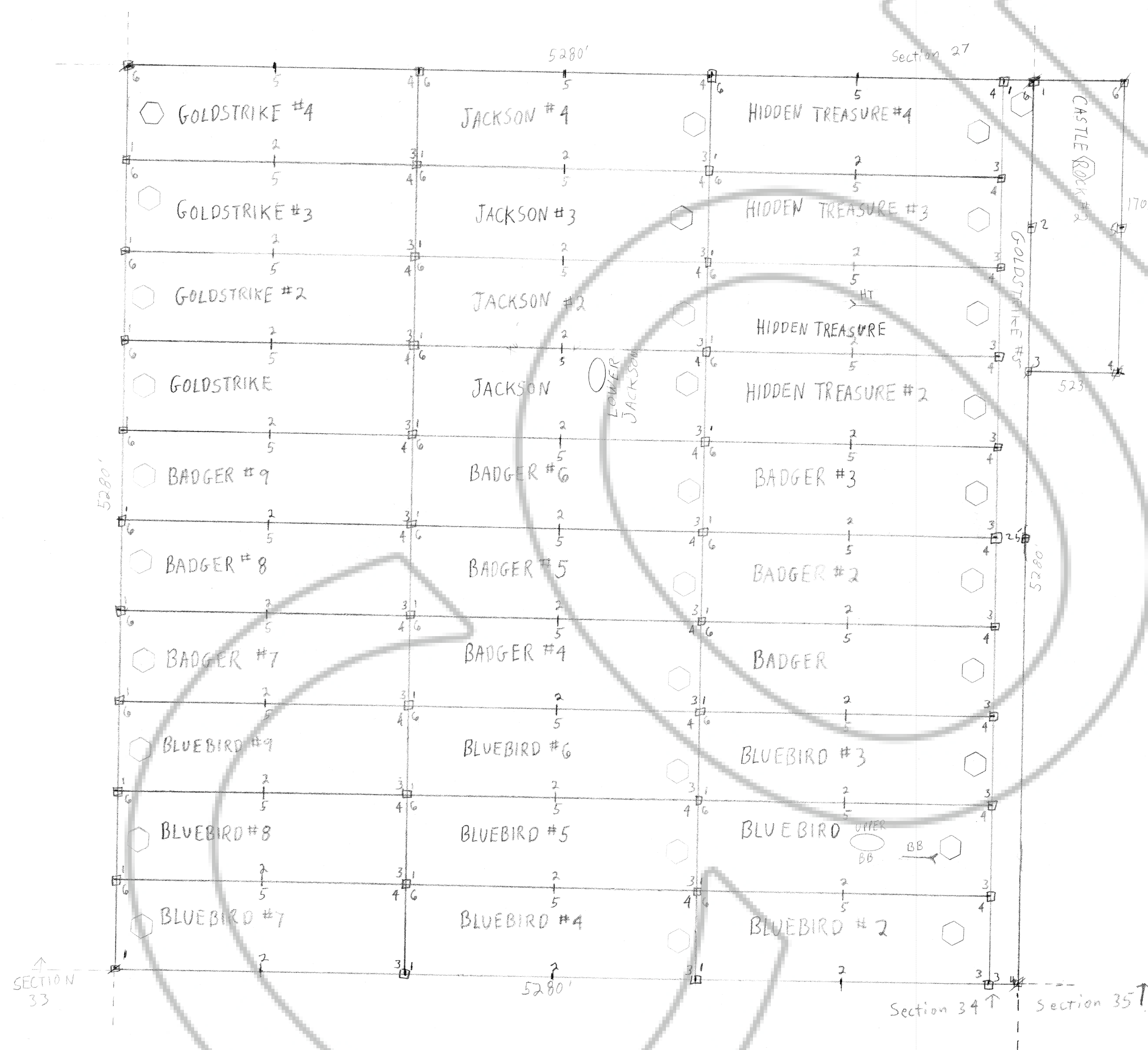

100701  
 AND RECORDED AT REQUEST OF  
 Paul R. Edwards  
 July 29, 1993  
 12 MINUTES EAST 3 CORNER  
 P. 106 OF OFFICIAL  
 RECORDS PAGE 580 LINCOLN  
 COUNTY, NEVADA  
 Yuriko Setzer  
 Julie Boucher, Deputy

DONDALE MINING DISTRICT

CLAIM GROUPS		
GOLDSTRIKE	JACKSON	HIDDEN TREASURE
BADGER	BLUEBIRD	CASTLE ROCK
SCALE: 1" = 500'	APPROVED BY:	DRAWN BY: PE
DATE: 7-25-93		REVISED:
DISCOVERY	CORNER POST	TUNNEL
MINE SHAFTS		DRAWING NUMBER: