

Lincoln County

Order No. 6335.Lin

Escrow No. 6335.Lin

WHEN RECORDED, MAIL TO:
GRANTEE
458 E. 10600 South
Sandy, UT 84070

RPTT: 26.00 Space above this line for recorder's use
APN: 11-090-14

GRANT, BARGAIN and SALE DEED

FOR A VALUABLE CONSIDERATION, receipt of which is hereby acknowledged,
FREEDA M. SCHOFIELD and D. ROGER STEWART, successor Trustees of the William U.
Schofield Trust

do(es) hereby GRANT, BARGAIN and SELL to
STUART TWITCHELL and VALERIE TWITCHELL

the real property situate in the County of Lincoln, State of
Nevada, described as follows:

SEE ATTACHED EXHIBIT "A"

TOGETHER with all tenements, hereditaments and appurtenances, including
easements and water rights, if any, thereto belonging or appertaining,
and any reversions, remainders, rents, issues or profits thereof.

Dated x June 22, 1992

Freeda M. Schofield
FREEDA M. SCHOFIELD, successor Trustee
D. Roger Stewart
D. ROGER STEWART, successor Trustee

STATE OF NEVADA)
County of x Nye) ss.

On x June 22, 1992 personally
appeared before me, a Notary Public,
x Freeda M. Schofield, personally known
or proved to me to be the person whose
name is subscribed to the above instrument,

who acknowledged that he executed
the above instrument.
C. L. Flavin
Notary Public

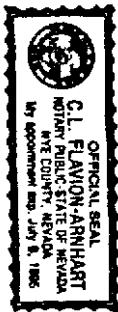

BOOK 101 PAGE 577

Lincoln County

STATE OF NEVADA)
)ss.
COUNTY OF WASHOE)

On JUNE 26, 1992, personally appeared before me, a Notary Public,
D. ROGER STEWART, SUCCESSOR TRUSTEE OF THE WILLIAM U. SCHOFIELD, JR. TRUST,

personally known or proved to me to be the person whose name ~~was~~^{is} subscribed to
the above instrument, who acknowledged that he executed the above instrument.

Hildegard J. Brandstrom
Notary Public

My Commission expires: 10-13-93

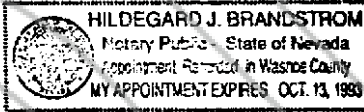

098606

AND RECORDED AT REQUEST OF
Gov County Title

June 30, 1992

55 MINUTES PAST 1 O'CLOCK OF

P M IN BOOK 101 OF OFFICIAL

577 PAGE LINCOLN

NEVADA

YURIKO SETZER

COUNTY RECORDER

By Mara Condie, Deputy

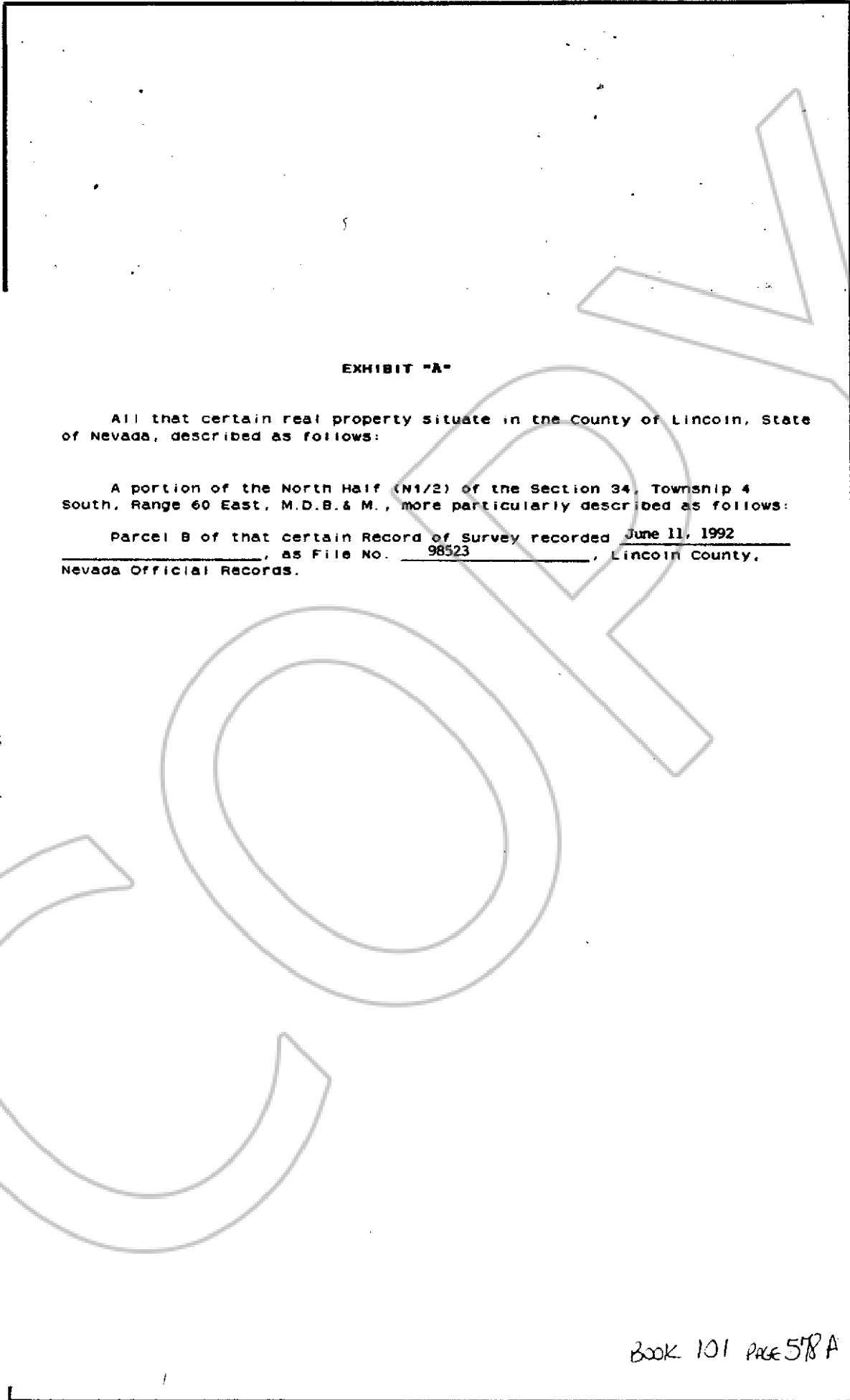

EXHIBIT "A"

All that certain real property situate in the County of Lincoln, State of Nevada, described as follows:

A portion of the North Half (N1/2) of the Section 34, Township 4 South, Range 60 East, M.D.B. & M., more particularly described as follows:

Parcel B of that certain Record of Survey recorded June 11, 1992, as File No. 98523, Lincoln County, Nevada Official Records.