

SURVEYOR'S CERTIFICATE

I, James J. Owens, a Professional Land Surveyor registered in the State of Nevada, do hereby certify that this Parcel Map was made at the instance of Mary Jeanett McCrosky, Larry A. Dotson and Blanche H. Dotson; that all monuments are of the character as indicated and occupy the positions shown and are sufficient to enable the survey to be retraced; that this survey conforms with the provisions of NRS 625.340 to 625.380, inclusive. This survey was completed on October 23, 1991.

James J. Owens
Professional Land Surveyor
Nevada Certificate No. 2884

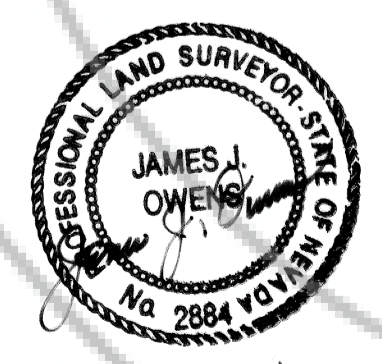

LEGEND

- Property Corner - set 1/2" rebar with plastic cap marked "Owens PLS 2884".
- x- Fence
- ⊙ G.L.O. Brass Cap dated 1919.
- Right-of-Way Monument.

BASIS OF BEARING

The Basis of Bearing is a line between the NW Corner and N 1/4 Corner of Sec. 4, T. 2 S., R. 68 E., M.D.M., which bears N. 89° 45' 16" E., as shown on James J. Owens Boundary Line Adjustment Book 94 Page 616.

REFERENCE MAPS

1. Patent - U.S.A. to the Town of Panaca - Book 583 Page 0 - misc. R.E.Deeds.
2. Map of Panaca City - Book Plat "A" Page 34.
3. 1872 G.L.O. Survey of T. 2 S., R. 68 E., M.D.M.
4. 1920 G.L.O. Survey of T. 1 S., R. 68 E., M.D.M.
5. 1983 Street Map - Town of Panaca - Book Plat "A" Page 210.
6. State of Nevada Department of Highways Right-of-Way Map, Federal Aid Project No. 120 - dated June 11, 1942.
7. James J. Owens Record of Survey Book Plat "A" Page 337.
8. Boundary Line Adjustment Book 94 Page 616.
9. James J. Owens Record of Survey Book Plat "A" Page 353.

OWNERS' CERTIFICATE

We, Mary Jeanett McCrosky, Larry A. Dotson and Blanche H. Dotson, hereby certify that we are the owners of the lands shown hereon, that we consent to the preparation and recordation of this Parcel Map showing the land platted into parcels and that it conforms to the provisions in NRS 278.500 through 278.560.

Mary Jeanett McCrosky 11-15-91
MARY JEANETT McCROSKY DATE

Larry A. Dotson 11-14-91
LARRY A. DOTSON DATE

Blanche H. Dotson 11-12-91
BLANCHE H. DOTSON DATE

ACKNOWLEDGEMENT

STATE OF NEVADA }
COUNTY OF LINCOLN } SS

On this 15 day of November, 1991, personally appeared before me, a Notary Public in and for said County and State, Mary Jeanett McCrosky, Larry A. Dotson and Blanche H. Dotson, known to me to be the persons described in and who executed the foregoing instrument freely and voluntarily and for the uses and purposes therein mentioned.

Janice Barr

Notary Public in and for said County and state
My appointment expires 2-8-92

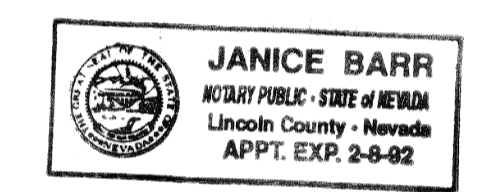

ZONING AND PLANNING APPROVAL

This is to certify that the Director of Zoning and Comprehensive Planning, Lincoln County, Nevada, did on this 9 day of June, 1991, approve for purposes of land division and accept in behalf of the public this map and any parcels of land offered for dedication for public use in conformity with the terms of the offer of dedication per NRS 278.010 through 278.630.

Will Washburn June 9 1992
Director Date

COUNTY COMMISSION APPROVAL

Approved this 22 day of June, 1991, by the Lincoln County Commissioners as a Parcel Map.

Edward E. Wright 6-22-92
Chairman Date

Cornie Logan 6-22-92
Attest: Clerk Date

PARCEL MAP
for
MARY JEANETT McCROSKY, LARRY A. DOTSON
and BLANCHE H. DOTSON

Parcels of land situate in Lots 3 & 4 of Block 36 of the Town of Panaca, NW 1/4 of Sec. 4, T. 2 S., R. 68 E., M.D.M., Lincoln County, Nevada

No. 098568
Filed at the request of
JEANETT McCROSKY
Date JUNE 20 1991 at 12:35 PM
File RAT-A Page 375
of Parcel Maps
Official Records Book No.
Lincoln County, Nevada Records
Yuriko Setzer, Recorder
Deputy

THE OWENS SURVEYING OUTFIT
Project Mineral, Land Surveying throughout the west:
P.O. Box 1330
61 E. Mesquite Boulevard
Mesquite, Nevada 89024
(702) 346-2930