

5494.Lin
Escrow No. LV 715497 LAD

When Recorded Mail To:
R. Frank Zimmerman and Bette Zimmerman, Trustees
417 Bedford Road
Las Vegas, NV 89107

DEED OF TRUST WITH ASSIGNMENTS OF RENTS

THIS DEED OF TRUST, made July 17, 1991 between Shawn Wiscombe and Teri Sue Wiscombe, husband and wife as joint tenants TRUSTOR, whose address is 730 Front St., Caliente, NV, FIRST AMERICAN TITLE COMPANY OF NEVADA, a Nevada Corporation, TRUSTEE, and R. Frank Zimmerman and Bette Zimmerman, Trustees of the R. Frank Zimmerman and Bette Zimmerman Revocable Family Trust, BENEFICIARY,

WITNESSETH: That Trustor grants to Trustee in trust, with power of sale, that property in the County of Lincoln, State of Nevada described as: SEE EXHIBIT "A" ATTACHED HERETO FOR COMPLETE LEGAL DESCRIPTION AND BY REFERENCE MADE A PART HEREOF.

"IT IS EXPRESSLY UNDERSTOOD AND HEREBY ACKNOWLEDGED THAT THIS DEED OF TRUST AND THE NOTE SECURED HEREBY SHALL BECOME IMMEDIATELY DUE AND PAYABLE AT THE OPTION OF THE BENEFICIARY HEREIN, IN THE EVENT THE PROPERTY DESCRIBED HEREIN IS TRANSFERRED OR CONVEYED TO ANY OTHER PERSON OR PERSONS IN ANY MANNER WHATSOEVER."

NOTE SECURED HEREBY CONTAINS PROVISIONS FOR A LATE CHARGE

Together with the rents, issues and profits thereof, subject, however, to the right, power and authority hereinafter given to and conferred upon Beneficiary to collect and apply such rents, and profits.

For the purposes of securing (1) payment of the sum of \$93,900.00 with interest thereon according to the terms of the promissory note or notes of even date herewith made by Trustor, payable to order of Beneficiary, and all extensions or renewal thereof; and (2) the performance of each agreement of Trustor incorporated herein by reference or contained herein; (3) payment of additional sums and interest thereon which may hereafter be loaned to Trustor, or to his successors or assigns, when evidenced by a promissory note or notes reciting that they are secured by this Deed Of Trust.

To protect the Security of this Deed of Trust, and with respect to the property above described, Trustor expressly makes each and all of the agreements, and adopts and agrees to perform and be bound by each and all of the terms and provisions set forth in subdivision A, and it is mutually agreed that each and all of the terms and provisions set forth in subdivision B of the fictitious Deed of Trust recorded in the office of each County Recorder in the State of Nevada on January 30, 1968, in the book and at the page thereof, or under the document or file number, noted below opposite the name of such county, namely:

COUNTY	BOOK	PAGE	DOC. NO.	COUNTY	BOOK	PAGE	DOC. NO.
Churchill	39 Mortgages	363	115384	Lincoln			45902
Clark	850 Off.Rec.		682747	Lyon	37 Off.Rec.	341	100661
Douglas	57 Off.Rec.	115	40050	Mineral	11 Off.Rec.	129	89073
Elko	92 Off.Rec.	652	35747	Nye	105 Off.Rec.	107	04823
Esmeralda	3-X Deeds	195	35922	Ormsby	72 Off.Rec.	537	32867
Eureka	22 Off.Rec.	138	45941	Parshing	11 Off.Rec.	249	66107
Humboldt	28 Off.Rec.	124	131075	Storey	"S" Mortgages	208	31506
Lander	24 Off.Rec.	168	50782	Washoe	300 Off.Rec.	517	107192
				White Pine	295 F.I.E. Records	258	

shall inure to and bind the parties hereto, with respect to the property above described. Said agreements, terms and provisions contained in said subdivision A and B, identical in all counties, and printed on the reverse side hereof, are by the within reference thereto, incorporated herein and made a part of this Deed of Trust for all purposes as fully as if set forth at length herein, and Beneficiary may charge for a statement regarding the obligation secured hereby, provided the charge therefor does not exceed a reasonable amount.

The undersigned Trustor requests that a copy of any notice of default and any notice of sale hereunder be mailed to him at his address above set forth.

Shawn Wiscombe 7-19-91
 Shawn Wiscombe Date

Teri Sue Wiscombe 7-19-91
 Teri Sue Wiscombe Date

STATE OF NEVADA)

County of Nye) ss.

On July 19, 1991 personally appeared before me, a Notary Public, Shawn Wiscombe & Teri Sue Wiscombe, personally known and proved to me to be the persons whose names are subscribed to the above instrument who acknowledged that they executed the above instrument.

Cynthia L. Flavin
Notary Public

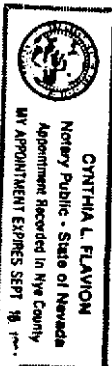

Lincoln County



Exhibit "A"

Lot 4 in Block "A" of the West End Addition to the City of Caliente, Lincoln County, Nevada, as shown on the subdivision map thereof recorded October 6, 1926 in the Office of the County Recorder of Lincoln County, Nevada in Book A of Plats, page 44 Lincoln County, Nevada records.

NOTALS
[Signature]
1/10

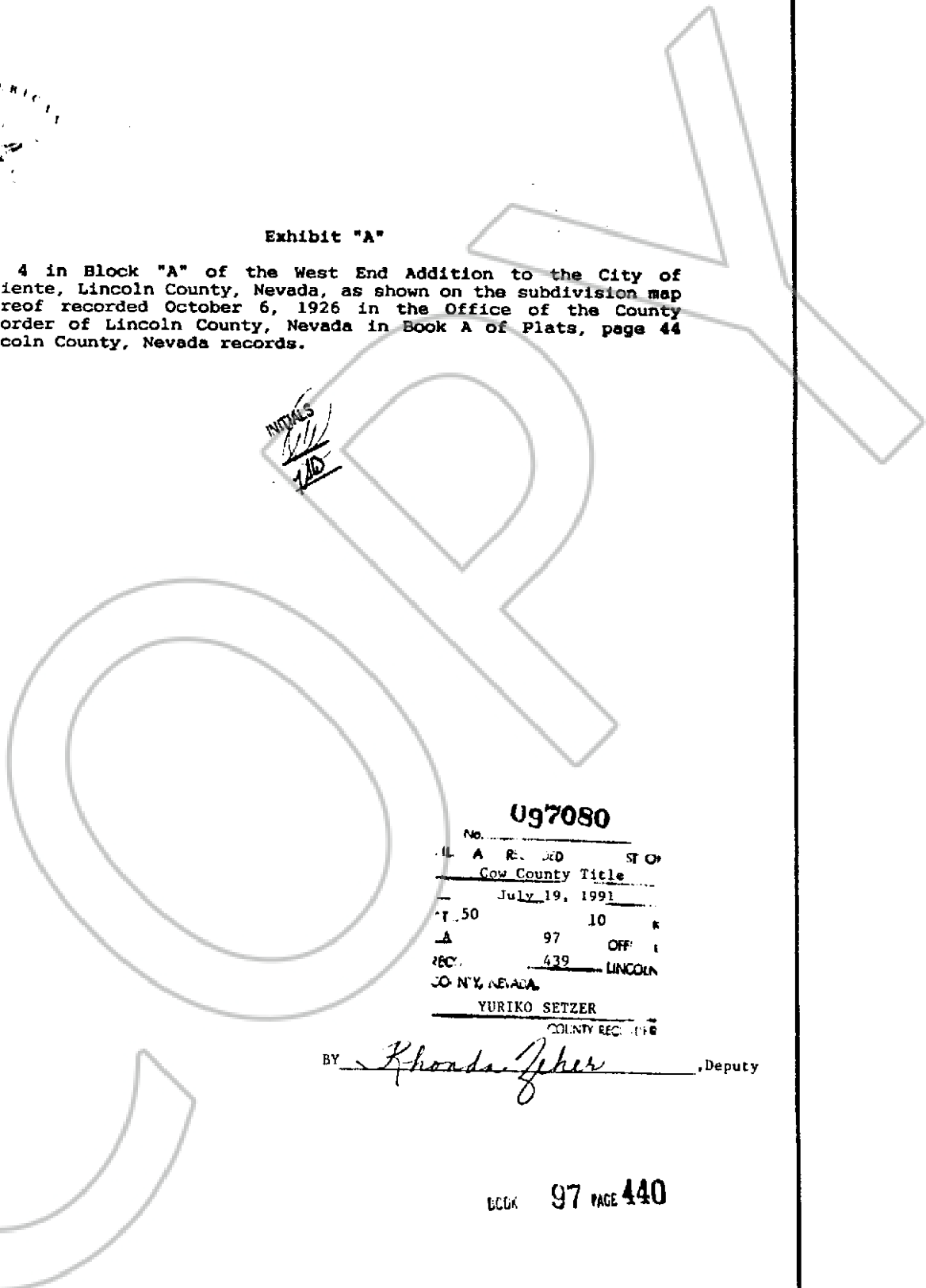

Ug7080

No.	Ug7080	
FILED	RECORDED	STATE OF
Lincoln County Title		
July 19, 1991		
10	50	10
97	Δ	OFF
439	REC'D	LINCOLN
CO. NV, NEVADA		
YURIKO SETZER		
COUNTY RECORDER		

BY *Rhonda Zuber*, Deputy

BOOK 97 PAGE 440