

A MAP OF THE CAMPER LODGE CLAIMS
 Ts. 7 & 8 N., Rs. 68 & 69 E.
 LINCOLN COUNTY, NEVADA

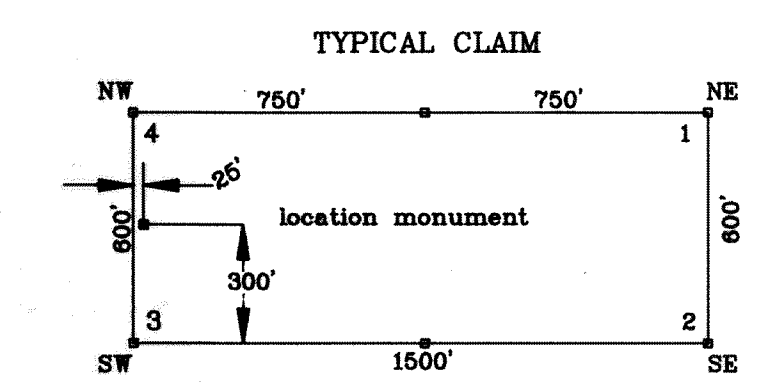
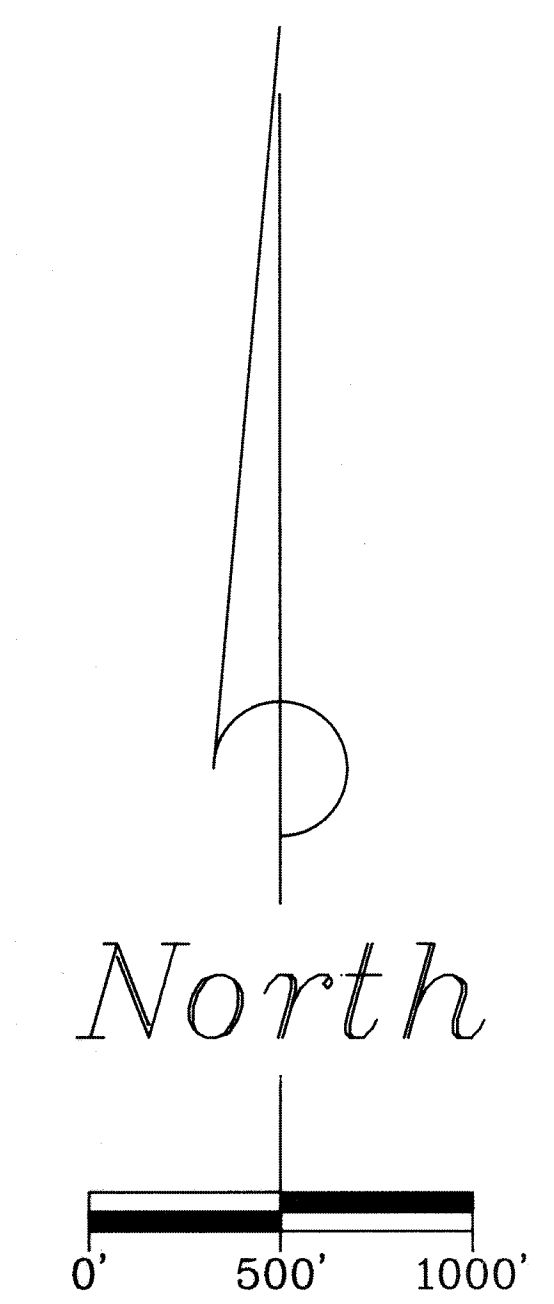
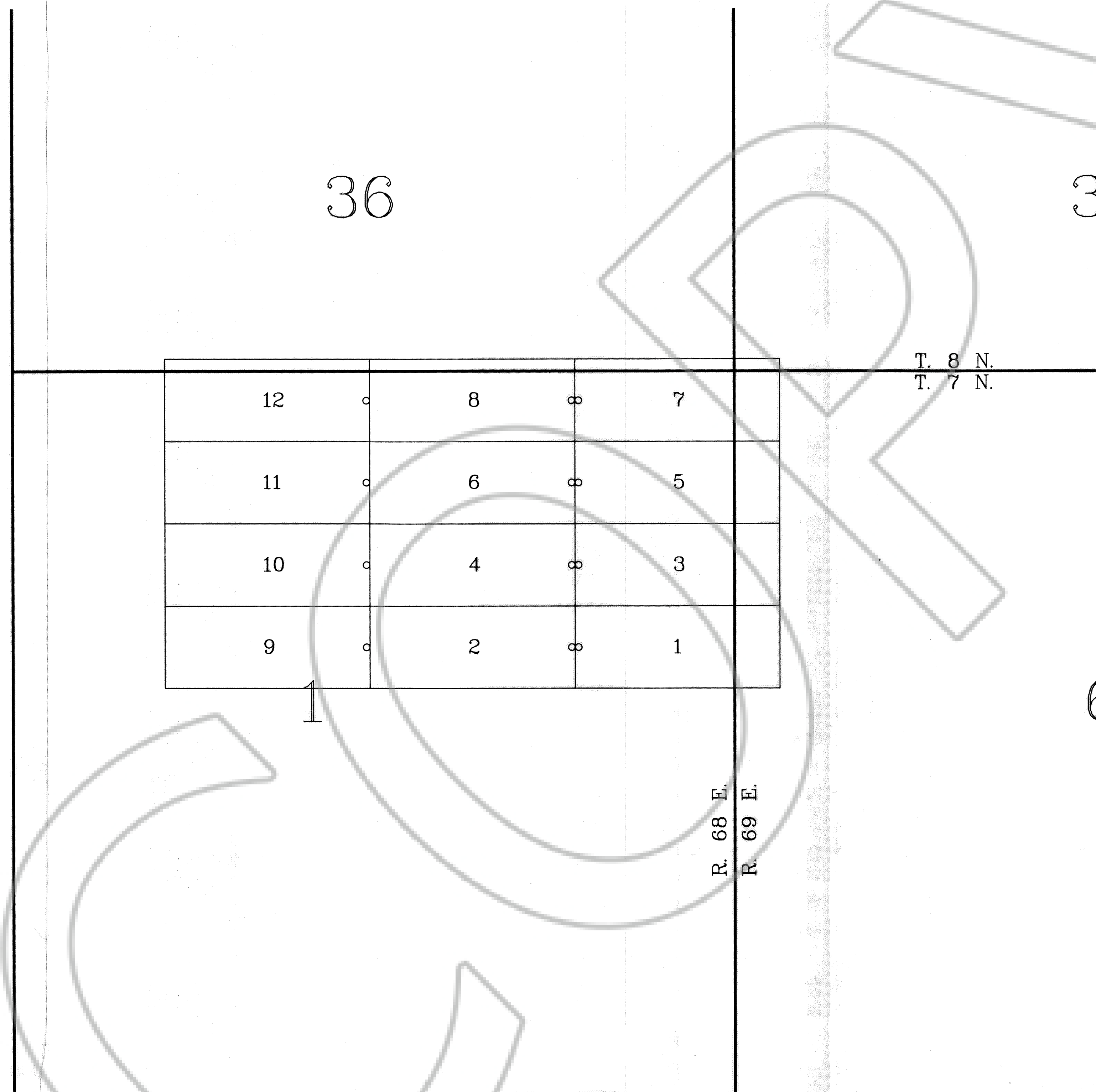

NOTE:
 All section lines are projected.
 NOTE:
 All corners and location monuments are 3" PVC pipe.
 BASIS OF BEARING:
 Magnetic North using 18' declination.
 TIE:
 The Northwest corner of CAMPER 12 bears 13140 ft. North
 and 7001 ft. East of U.S.L.M. 4843
 DATE OF LOCATION:
 CAMPER 1 - 12 on March 11, 1991.

096685
 FILE A RECORD
 Gold Fields Mining
 May 7, 1991
 T. 8 N.
 R. 68 E.
 REC 512 LINCOLN
 CO. NV, EVANS
 James Setzer

		GOLD FIELDS MINING CORP.	
		1687 Cole Blvd., P.O. Box 4014 Golden, Colorado 80402-4014	
SURVEYED BY	DATE	CRD. BY	E. SCHAAF & ASSOCIATES
D.S.	8-22-91		381 PALMER DELTA, COLORADO 81416 (L.S. 18407-U.S. MINERAL SURVEYOR)
DRAWN BY	SCALE	ACCT. NO.	
D.S.	1"=500'	J914814	SHEET 1 of 1