

A MAP OF THE LANA LODGE CLAIMS  
T. 8 N., R. 68 E., M.D.M.  
LINCOLN COUNTY, NEVADA

28

27

26

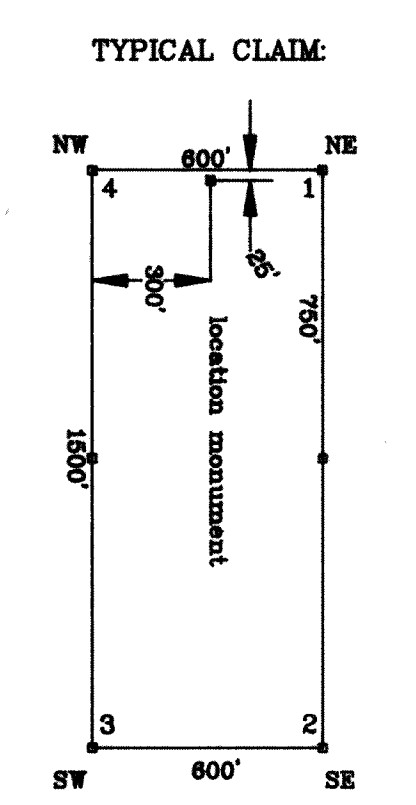
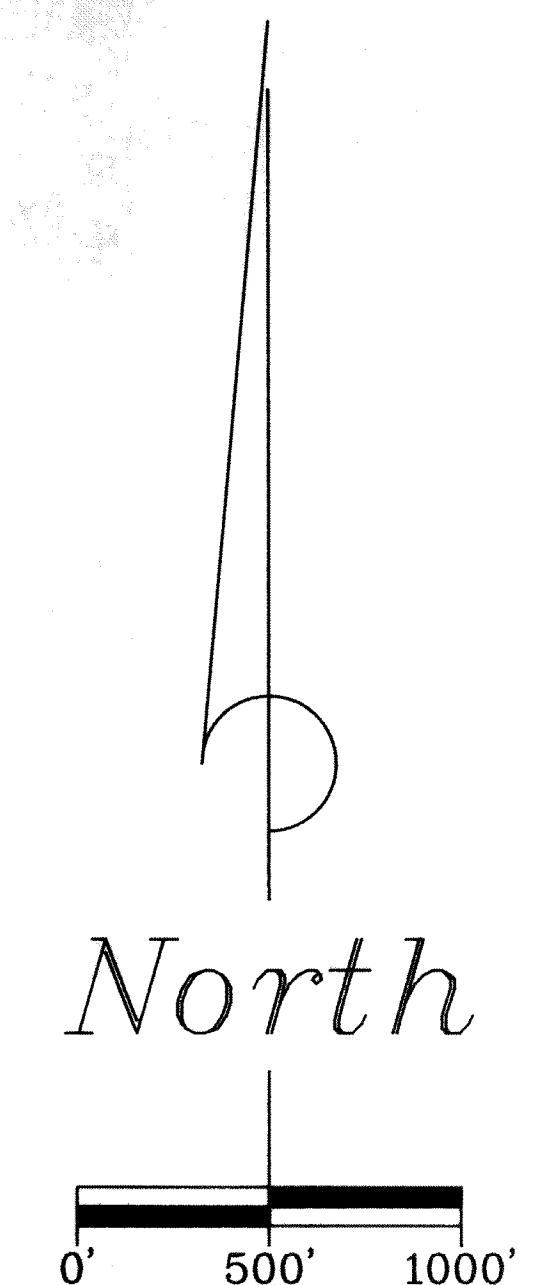
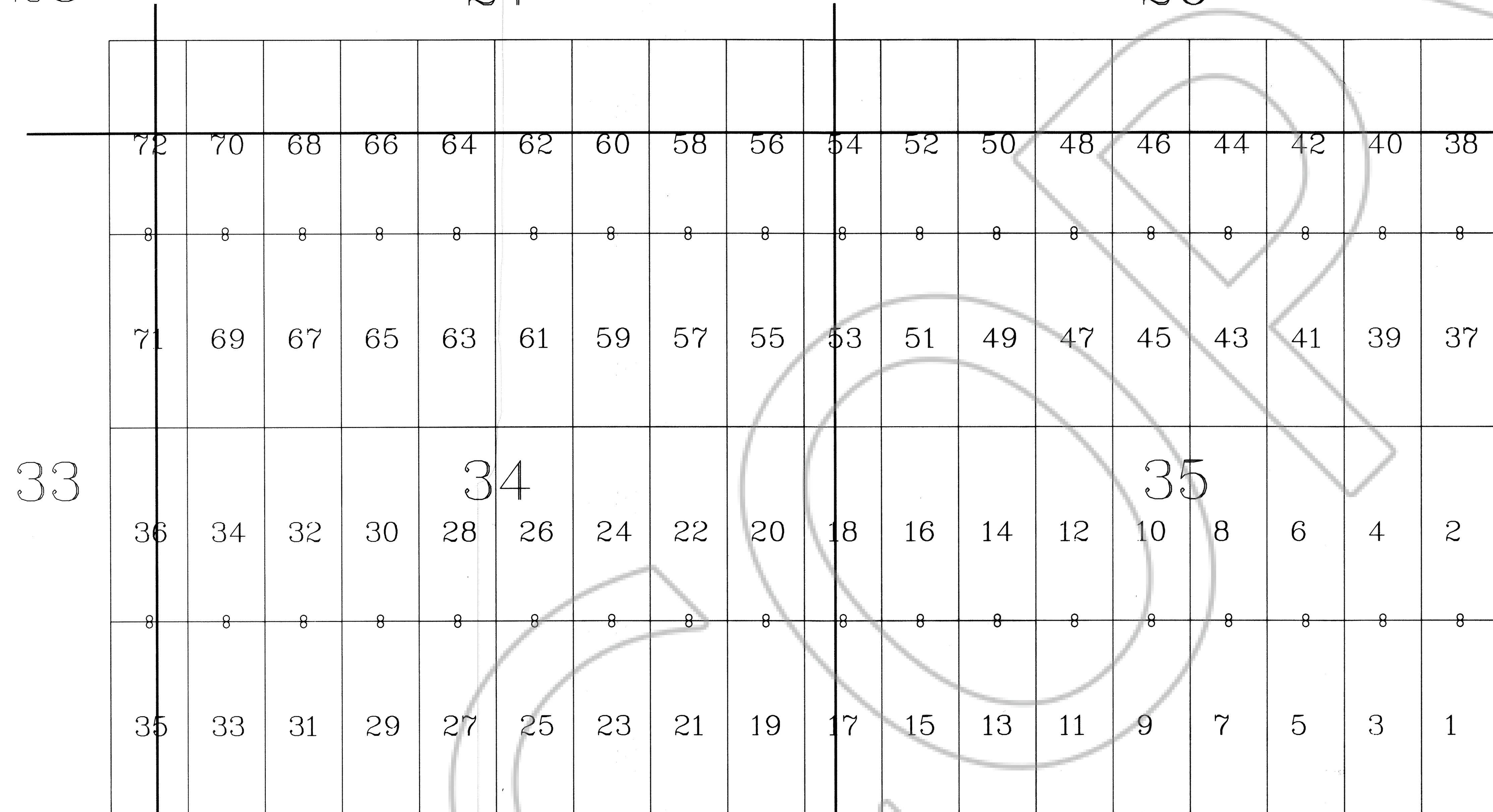

NOTE: All section lines are projected.  
NOTE: All corners and location monuments are 3" PVC pipe.  
BASIS OF BEARING:  
Magnetic North using 16' East declination.  
TIE: The Northeast corner of LANA 1 bears  
North 14559 ft. and East 7252 ft. from U.S.L.M. 4843.  
DATE OF LOCATION:  
LANA 1-36 and 62-72 on March 20, 1991.  
LANA 37 - 61 on March 21, 1991.

4

3

2

T. 8 N.  
T. 7 N.

096684  
RECORDED  
Gold Fields Mining  
Mar 21 1991  
96 OFF  
511 LINCOLN  
NEVADA  
Gussie Lopez

		GOLD FIELDS MINING CORP.	
		1687 Cole Blvd., P.O. Box 4014 Golden, Colorado 80402-4014	
SURVEYED BY	DATE	CHK. BY	E. SCHAAF & ASSOCIATES
D.S.	9-26-91		361 PALMER DELTA, COLORADO 8446 R.L.S. 1847-U.S. MINERAL SURVEYOR
DRAWN BY	SCALE	ACCT. NO.	
D.N.	1'=500'	J914819	SHEET 1 of 1