

A MAP OF THE BUCK LODGE CLAIMS

T. 7 N., R. 68 E., M.D.M.

LINCOLN COUNTY, NEVADA

6	37	35	33	31	29	27	25	23	21	19	17	15	13	11	9	7	5	3	1	61			
	8	8	8	8	8	8	8	8	8	8	8	8	8	8	8	8	8	8	8	8			
	38	36	34	32	30	28	26	24	22	20	18	16	14	12	10	8	6	4	2	62			
	0	0	0	0	0	0	0	0	0	0	0	0	0	0	0	0	0	0	0	0			
	60	59	58	57	56	55	54	53	52	51	50	49	48	47	46	45	44	43	42	41	40	39	93

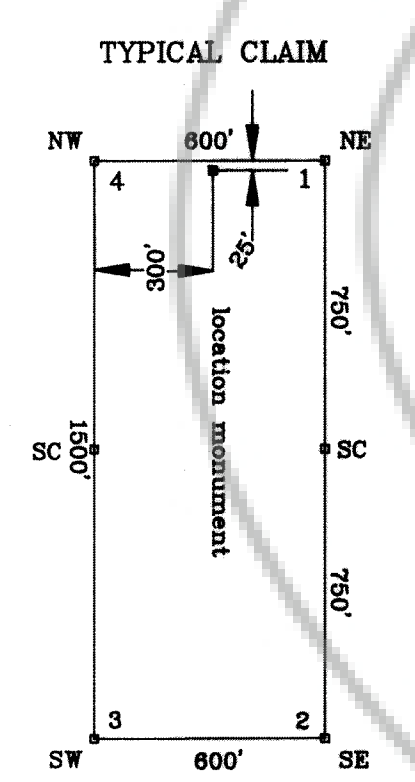

All monuments are 3" OD
PVC pipe 5' in length.

BASIS OF BEARING:
All bearings are based on magnetic North using 16' E. declination.

NOTE:
All Section lines are projected.

TIE:
Corner No. 1 (Northeast Cor.) of the BUCK 1 bears North 13,058.06 ft. and West 606.25 ft. from USLM 4843.

DATES OF LOCATION
BUCK 1 to 10 on Jan. 12, 1991
BUCK 11 to 32 on Feb. 23, 1991
BUCK 47 to 53 on Feb. 24, 1991
BUCK 33 to 46 and 54 to 60 on Feb. 26, 1991

096129
RECORDED
GOLD FIELDS MINING CORP.
MAY 20, 1991
BY 95
193
YUKIO SETZER
COUNTY RECORDER
Mara Cordie / Deputy

BOOK 95 PAGE 193

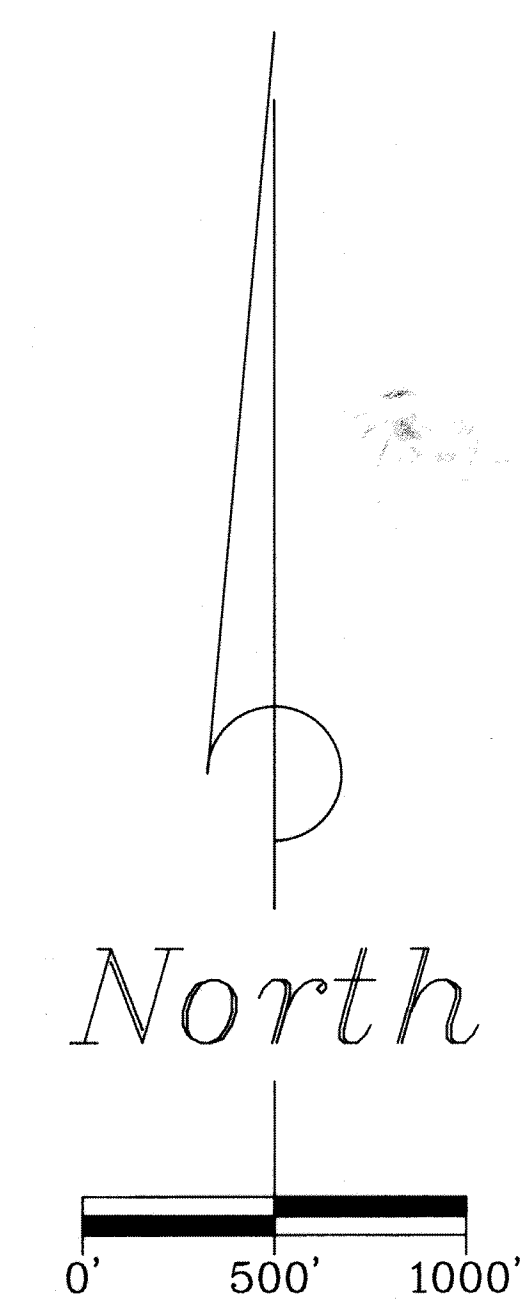

GOLD FIELDS MINING CORP.	
1687 Cole Blvd., P.O. Box 4014 Golden, Colorado 80402-4014	
SURVEYED BY D.S.	DATE 3-4-91
DRAWN BY D.H.	SCALE 1"=500'
BY E. SCHAAF & ASSOCIATES 801 PALMER DELTA, COLORADO 80410 R.L.S. 1847-U.S. MINERAL SURVEYOR ACCT. NO. J914811A	
SHEET 1 of 2	