

R. 57 E. R. 58 E.

N 90°W 3700'
to SE/corner Section 24
T. 3 S., R. 57 E.

N 00°E 13,900'

ECON
1026

N 90°E

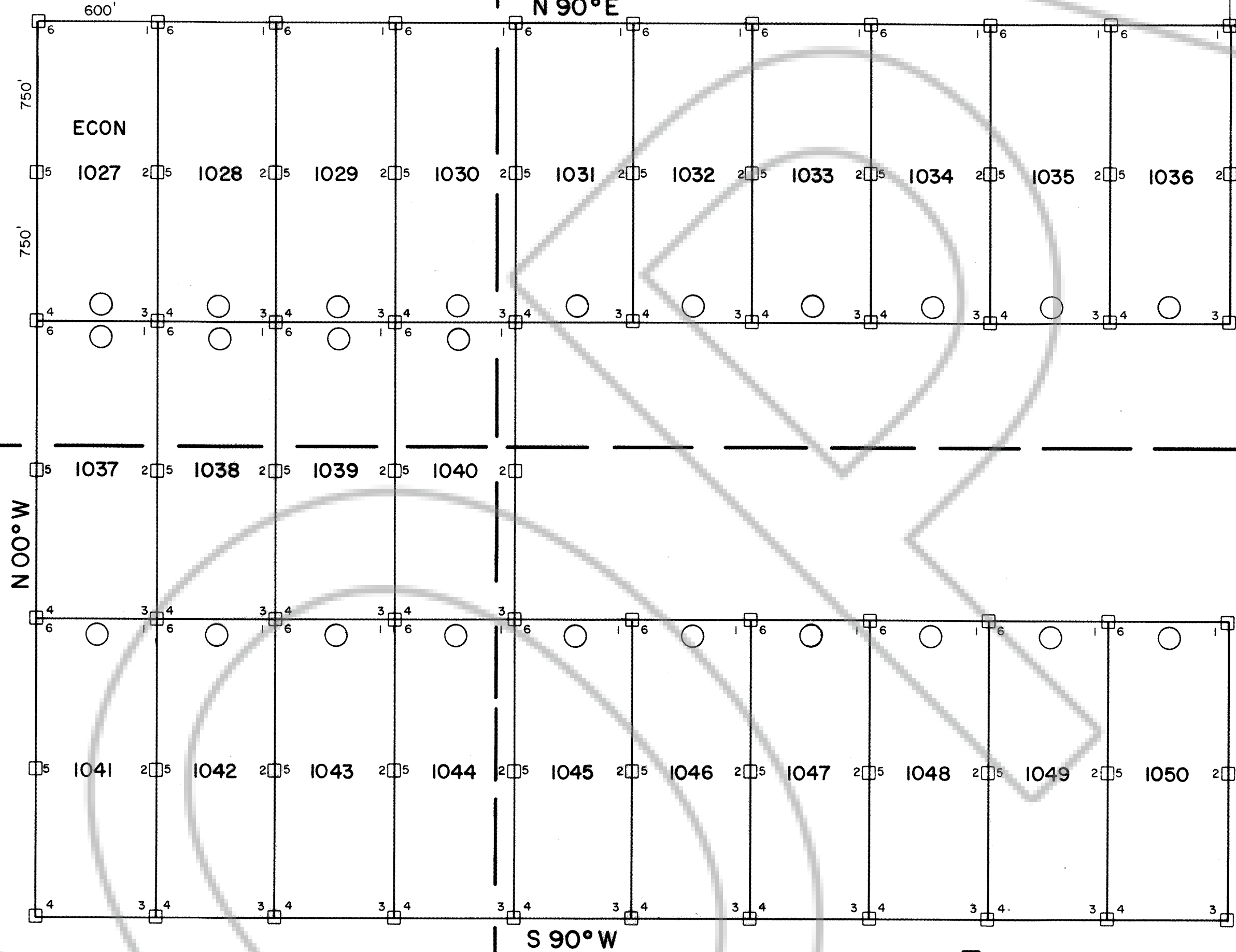

T.
4
S.

12

7

8

○ = LOCATION MONUMENT
 ALL CLAIMS ARE 600' x 1500' UNLESS OTHERWISE NOTED.
 ALL LOCATION MONUMENTS ARE OFFSET 10' FROM END CENTERS UNLESS OTHERWISE NOTED.
 ALL LOCATION MONUMENTS, SIDE CENTERS AND CORNERS ARE MONUMENTED WITH 3" DIA. BY 5' IN LENGTH PVC PIPE.
 BEARINGS SHOWN HEREON ARE TRUE BEARINGS.
 - - - - - PROTRACTED SECTION LINE

MAP
 OF
 LODGE MINING CLAIMS
 WITHIN
 TOWNSHIPS 3 & 4 SOUTH, RANGES 57 & 58 EAST
 MOUNT DIABLO MERIDIAN
 LINCOLN COUNTY, NEVADA
 FOR
 ENVIRONMENTAL COMPANY OF NEVADA, L.P.
 P.O. BOX 10350
 RENO, NEVADA 89510

No. 095121
 FILED AND RECORDED IN ST. OF
 Environmental Court, NV.
 + 15
 11-15-92 OFFICE
 REC 769 LINCOLN
 COUNTY, NEVADA
Franklin
 COUNTY REC. CLERK

ECON CLAIMS 171-200, 991-1050
 LOCATED - AUGUST 22-24, 1990

BOOK 92 PAGE 469

Survey and Map by: ROCKY MOUNTAIN SURVEYORS Albuquerque, New Mexico Job No. 13-90