

**SECTION BREAKDOWN - GOVERNMENT LOTS  
IN N 1/2 SEC. 2, T.4N., R.67E., M.D.M. IN  
LINCOLN COUNTY, NEVADA**

SCALE 1"=400'

- LEGEND**
- Property Corner-set rebar with cap marked 2884
  - Section Corner
  - 1/4 Corner
  - Subject Property
  - 28 Lincoln Co. Assessors Parcel No.

**SURVEYOR'S CERTIFICATE**

I, James J. Owens, a Professional Land Surveyor registered in the State of Nevada, hereby certify that this Record of Survey was made at the instance of Herman R. & Rebecca H. Hoge, that all monuments are of the character as indicated and occupy the positions as shown and are sufficient to enable the survey to be retraced; that this survey conforms with the provisions of N.R.S. 625.340 to 625.380. This survey was completed on April 20, 1990.

James J. Owens  
Professional Land Surveyor  
Nevada Certificate No. 2884

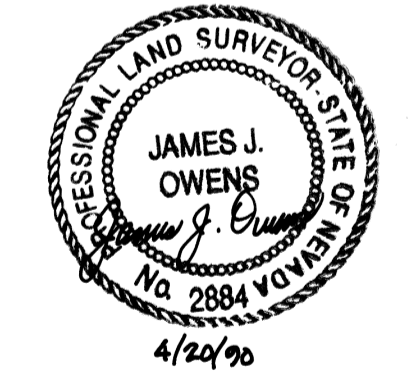

**REFERENCE MAP**

I, 1924 G.L.O. Dependent Resurvey of a portion of T. 4 N., R. 67 E., M.D.M.

**BASIS OF BEARING**

The Basis of Bearing is a line between the NW Corner and the W. 1/4 Corner of Section 2, Township 4 North, Range 67 EAST, M.D.M., which bears N. 00°17'00" W., as shown on 1924 G.L.O. Dependent Resurvey of a portion of T. 4 N., R. 67 E., M.D.M.

SCALE 1"=100'

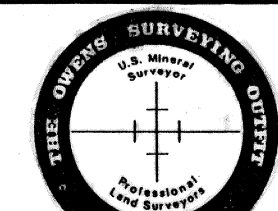
<b>RECORD OF SURVEY</b>		No. <b>63952</b>
FOR <b>HERMAN R. &amp; REBECCA H. HOGE</b>		Filed at the request of <i>James Owens</i>
SE 1/4 of Government Lot 7, Sec. 2, T. 4 N., R. 67 E., M.D.M., Lincoln County, Nevada		Date <b>25 Apr 90</b> At <b>4:30 PM</b>
 <b>THE OWENS SURVEYING OUTFIT</b> Project Mineral, Land Surveying throughout the west. P.O. Box 1330 Mesquite, Nevada 89024 702-346-2930		File <b>Plot A</b> Page <b>312</b> of Survey Maps
NV-65		Official Records Book No. <b>Plot A</b>
		Fee <b>10.00</b> Deputy <i>[Signature]</i>