

**SECTION BREAKDOWN - GOVERNMENT LOTS
IN N 1/2 SEC. 2, T. 4N., R. 67E., M.D.M. IN
LINCOLN COUNTY, NEVADA**

SCALE 1"=400'

- LEGEND**
- Property Corner - set rebar with cap marked 2884
 - Section Corner
 - 1/4 Corner
 - Subject Property
 - Lincoln Co. Assessors Parcel No.

SURVEYOR'S CERTIFICATE

I, James J. Owens, a Professional Land Surveyor registered in the State of Nevada, hereby certify that this Record of Survey was made at the instance of Wesley A. & Dorothy G. Holt, that all monuments are of the character as indicated and occupy the positions as shown and are sufficient to enable the survey to be retraced; that this survey conforms with the provisions of N.R.S. 625.340 to 625.360. This survey was completed on April 20, 1990.

James J. Owens
Professional Land Surveyor
Nevada Certificate No. 2884

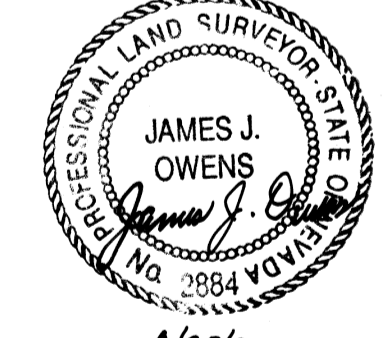

REFERENCE MAP

I. 1924 G.L.O. Dependent Resurvey of a portion of T. 4 N., R. 67 E., M.D.M.

BASIS OF BEARING

The Basis of Bearing is a line between the NW Corner and the W. 1/4 Corner of Section 2, Township 4 North, Range 67 EAST, M.D.M., which bears N. 00°17'00" W., as shown on 1924 G.L.O. Dependent Resurvey of a portion of T. 4 N., R. 67 E., M.D.M.

SCALE 1"=100'

RECORD OF SURVEY		No. 093951	
FOR WESLEY A. & DOROTHY G. HOLT		Filed at the request of <i>James J. Owens</i>	
West 1/2 of Government Lot 2, Sec. 2, T. 4 N., R. 67 E., M.D.M., Lincoln County, Nevada.		Date 25 April 1990 at 1:30 PM	
		File PLAT A Page 311	
		of Survey Maps	
		Official Records Book No. PLAT A	



THE OWENS SURVEYING OUTFIT
Project Mineral, Land Surveying throughout the west:

P.O. Box 1330
Mesquite, Nevada 89024
702-346-2930