

R 70 E

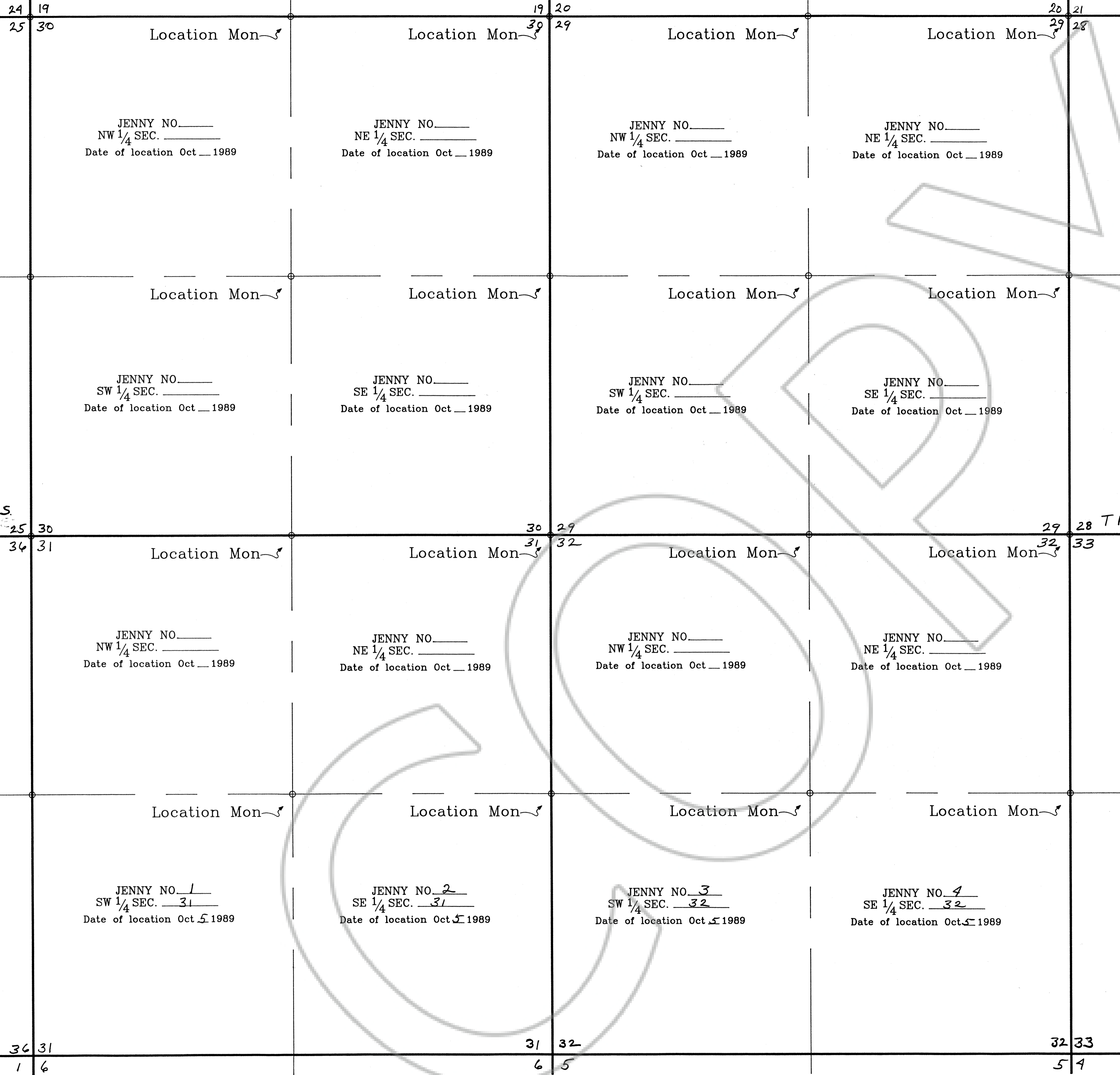

NOTES: All claims are 160 acre, association claims taken by legal subdivision.

All location monuments are 3" plastic pipe at least 5' long sunk at least 1' into the ground, and situated at the NE corner of each claim.

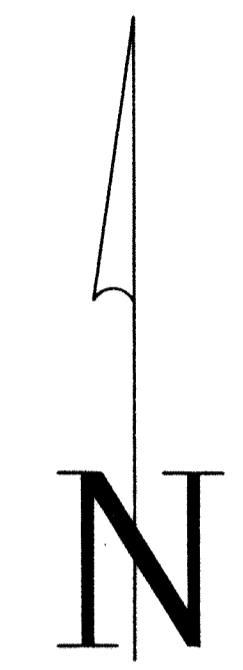

TRUE NORTH
SCALE 1" = 500'

Showing a portion of the Jenny group of placer claims situated in the Unknown Mining District Lincoln County, Nevada.

N 93179
PL A RECORD TO
George D Fehr
2 January 1990
ST 20 S 11 X
1900 08 QRL
692 LINCOLN
COUNTY REC. DES

Located by:

- George D. Fehr 10 Exchange Place, Suite 610 Salt Lake City, Utah 84111
- Eloise M. Fehr 2127 St. Mary's Drive Salt Lake City, Utah 84108
- Kristie Fehr Briggs 11568 Hidden Valley Blvd. Sandy, Utah 84092
- Gary E. Fehr 211 East 6850 South Midvale, Utah 84047
- Dennis Ross Fehr 8190 South Viscounti Drive Sandy, Utah 84092
- Diane Fehr 8190 South Viscounti Drive Sandy, Utah 84092
- Donald J. Fehr 3001 East Millcreek Road Salt Lake City, Utah 84109
- Caroline E. Fehr 3001 East Millcreek Road Salt Lake City, Utah 84109