

Sec. 5

Sec. 35

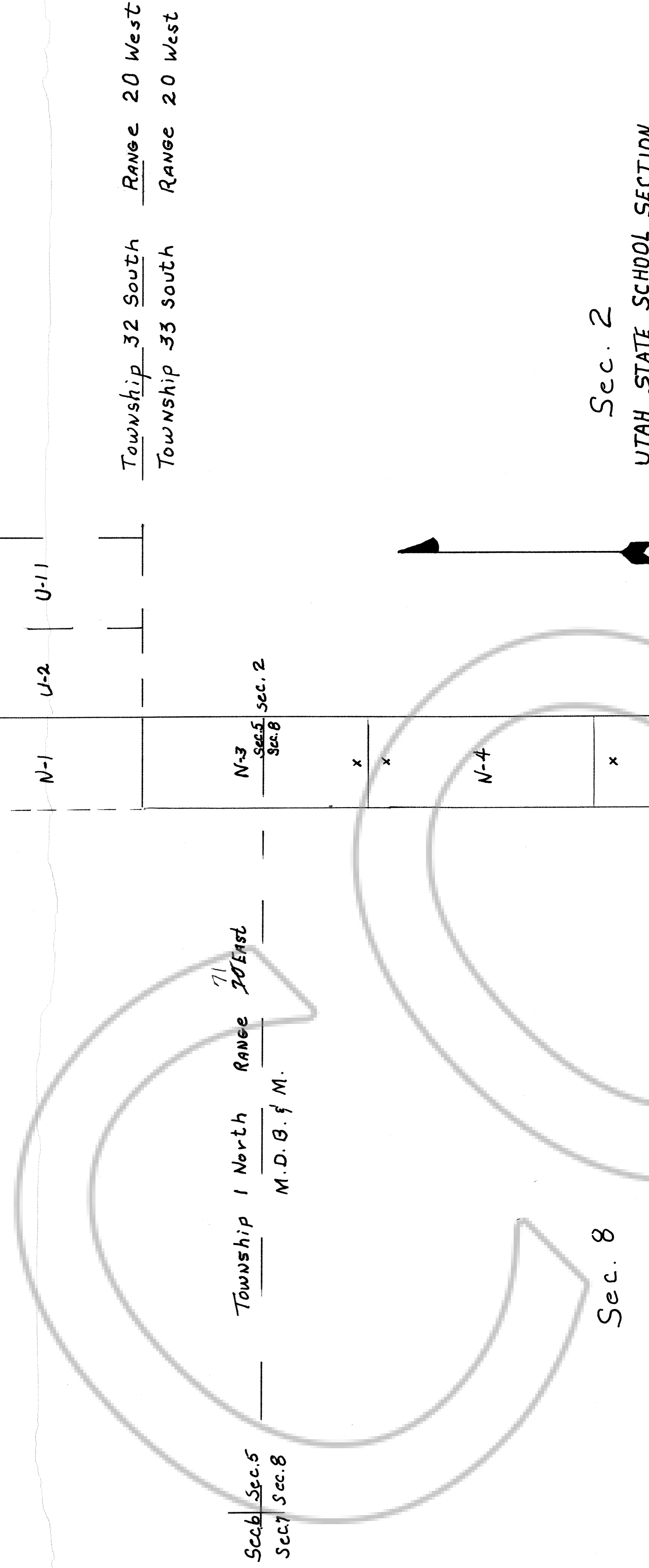

Sec. 6
Sec. 7
Sec. 8

Township 1 North
Range 20 East
M.D.B. & M.

Township 32 South
Range 20 West
Township 33 South
Range 20 West

Sec. 8

Sec. 2
UTAH STATE SCHOOL SECTION

UTAH

Sec. 17

Sec. 11

MT HOLLY LODGE CLAIMS N-3 thru N-14
DEER LODGE MINING DISTRICT NEVADA

Township 1 North, Range 20 East, Sections 5, 8, 17

Shirley McCrosky, Jody McCrosky, Lavar Hollingshead
Locabars

SR 63, Box 172, Pioche, Nevada 89043

March 18, 1989

Scale 1" to 500'

No. 30335
 Shirley McCrosky
 21 March 1989
 A. D. BY J. L. COIN
 COUNTY RECORDER