

R 70 E

R 70 E

R 71 E

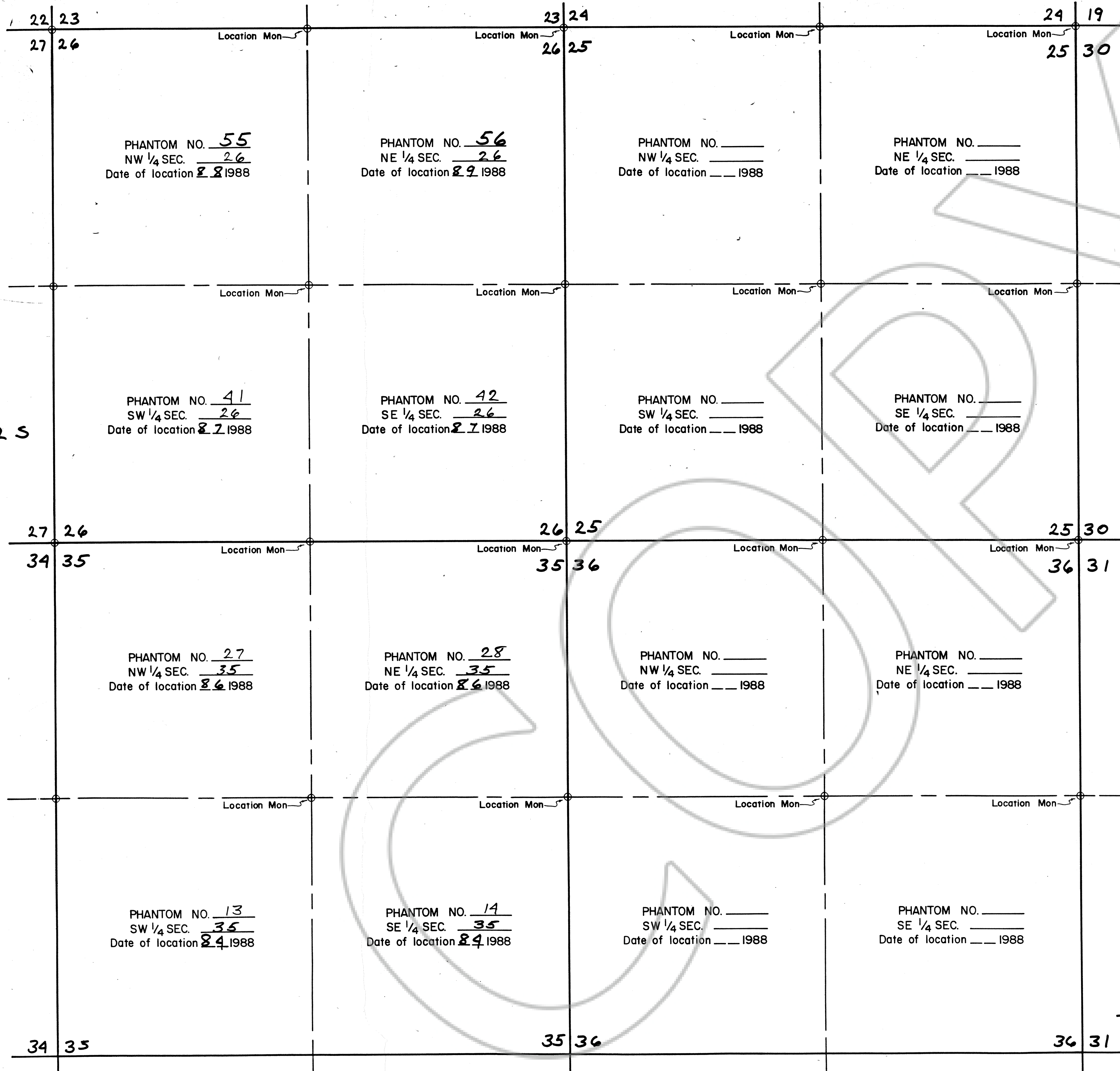

NOTES: All are 160 acres, association claims taken by legal subdivision.
 All location monuments are 3" plastic pipe at least 5' long and sunk at least 1' into the ground, situated at the NE corner of each claim.

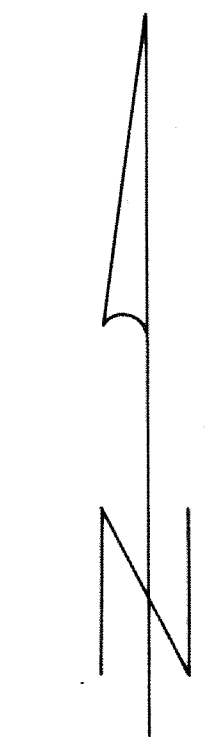

TRUE NORTH
SCALE 1" = 500'

MAP

Showing a portion of the Phantom group of placer claims situated in the Unknown Mining District Lincoln County, Nevada.

Located by:

- George D. Fehr _____ 10 Exchange Place, Suite 610
Salt Lake City, Utah 84111
- Eloise M. Fehr _____ 2127 St. Mary's Drive
Salt Lake City, Utah 84108
- Janet N. Davison _____ 10 Exchange Place, Suite 610
Salt Lake City, Utah 84111
- Joe Lyon, Jr. _____ 600 East Capitol Street
Salt Lake City, Utah 84103
- Hal Nichols _____ 230 South Decatur, Suite 224
Las Vegas, Nevada 89107
- Teresa Nichols _____ c/o Hal Nichols, 230 South Decatur,
Suite 224, Las Vegas, Nevada 89107
- Doug Nichols _____ c/o Hal Nichols, 230 South Decatur,
Suite 224, Las Vegas, Nevada 89107
- Donald J. Fehr _____ 3001 East Millcreek Road
Salt Lake City, Utah 84104

90200

George D. Fehr TCF
November 1, 1988
A 5 11 K
A 83 L
C 43 DN
FRANK C. HULSE
Mark Curtis/Deputy

T 12 S
T 13 S