

A PORTION OF UNSURVEYED
 Section 20, T 7N, R 6E
 M. D. B. + M

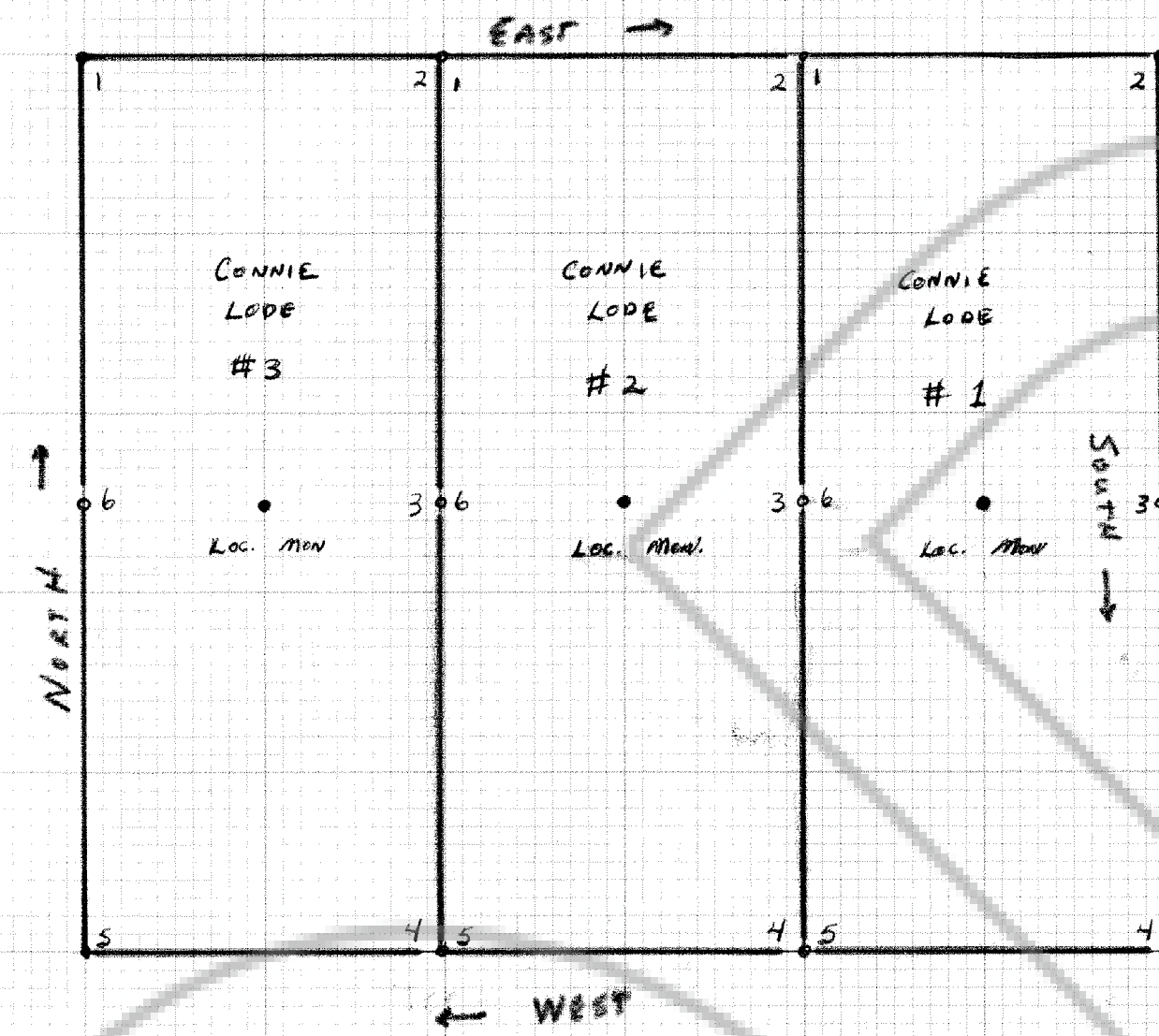

All monuments are of the
 character as described in the
 notices and occupy the positions
 shown hereon

(Tie)
 N 1° 17' 43" W
 11,962.72

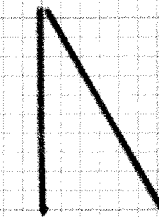

1" = 300'
 SCALE

(UNSURVEYED)
 T 7N, R 6E MDB+M
 T 6N, R 6E MDB+M

86599
 PARTIALLY SURVEYED AT ORDER OF
 CONNIE SIMKINS
 21 MARCH 1987
 A 59 12 12 12 12
 A 59 12 12 12 12
 342
 J. C. Cottrell

MAP of CONNIE LOBE CLAIMS
 Nos 1, 2, + 3
 SILVER PARK MINING District
 Filed by
 CONNIE SIMKINS, PANAMA NEVADA
 30 MARCH 1987