

STATE OF NEVADA
CERTIFICATE OF MINING LOCATION

LODE CLAIM ON PUBLIC DOMAIN

NOTICE IS HEREBY GIVEN that the BOOT # 2 lode mining claim has been located by Sherman Jensen, whose mailing address is 705 East Capitol Boulevard, Salt Lake City, Utah 84103. The general course of this claim is S 45° W 1/2. This claim is 1500 feet in length along the course of the claim, being 10 feet from the point of discovery in a SW direction to the SW end line of the claim and feet in a NE direction to the NE end line of the claim. This claim is 600 feet in width. The claim being 300 feet in width on each side of the center line of the claim.

This claim is located within the UNSURVEYED NW 1/4 SEC 9 T35 R59E SW 1/4 SE 1/4 SEC 33 T35 R59E, Mount Diablo Base and Meridian, PARRANAGA Mining District, Lincoln County, Nevada. The location (discovery) of this claim is situated with reference to some natural object or permanent monument as follows: THIS CLAIM BEING BOOT # 1 ON SW

The corners of this claim are marked by 4" DIAPYCN PIPE with metal tags inscribed with the appropriate corner number as shown on the following sketch and the accompanying claim map.

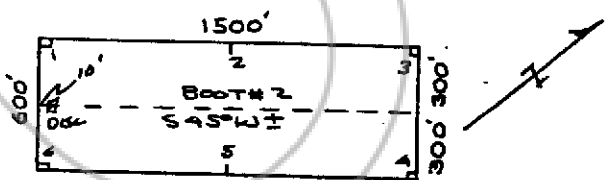

The location work consisted of making the maps as provided in NRS 517.040.

Dated and posted on the ground this 15 day of DECEMBER, 1986

Witnesses:

Locator: Sherman Jensen

STATE OF NEVADA
COUNTY OF LINCOLN

: ss.
)

I hereby certify that the within instrument was filed and recorded at the request of Sherman Jensen
FILE NO. 86167
on Jan. 26, 1987
at 1 min. past 9 o'clock a.m.
Docket Book 73 Page 423

Witness my hand and official seal the day and year aforesaid.
FRANK C. HULSE
County Recorder
By Mara Connie
Deputy Recorder