

SECTION 36 TOWNSHIP 11S RANGE 65E MDB+M

LINCOLN COUNTY NEVADA

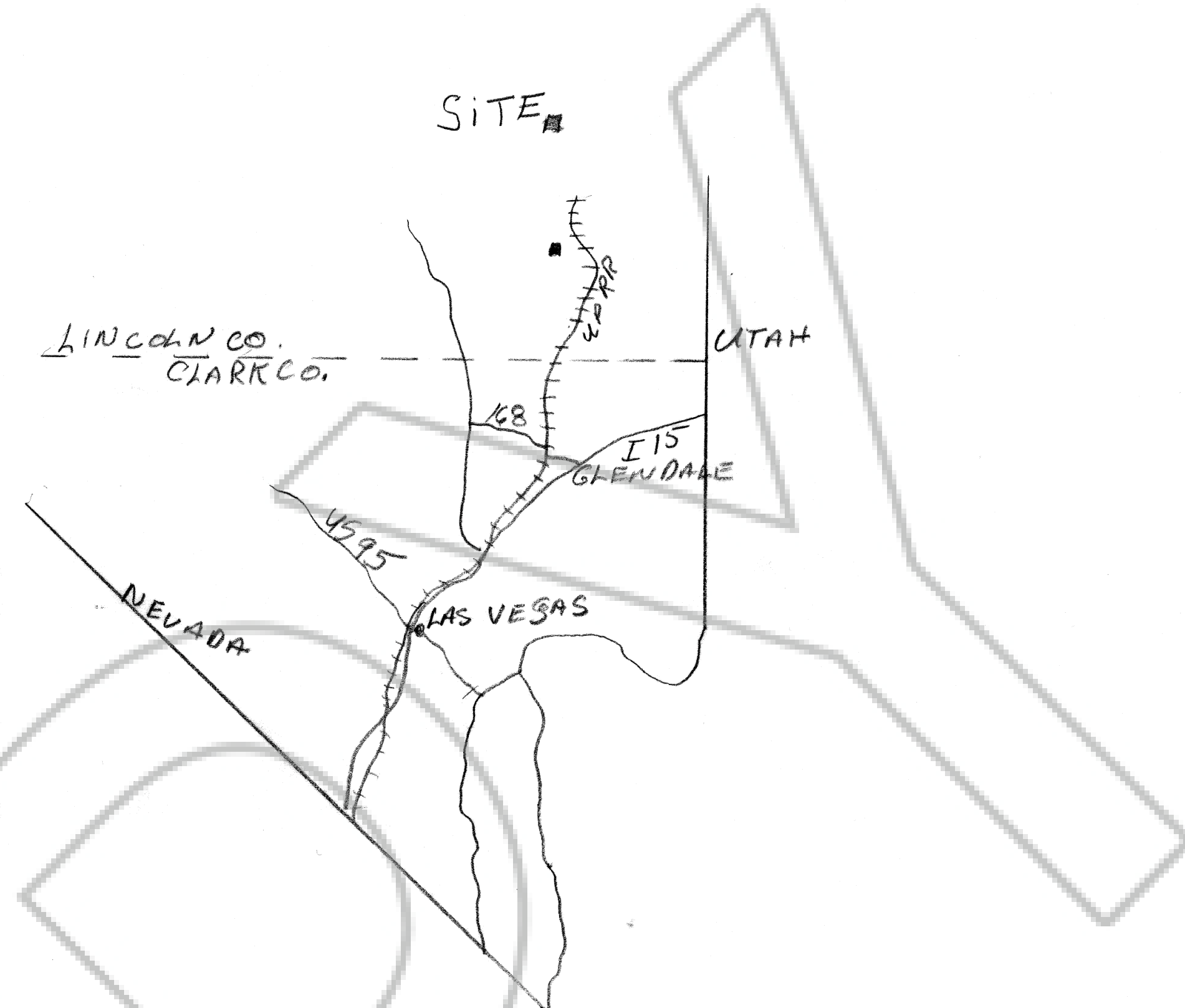
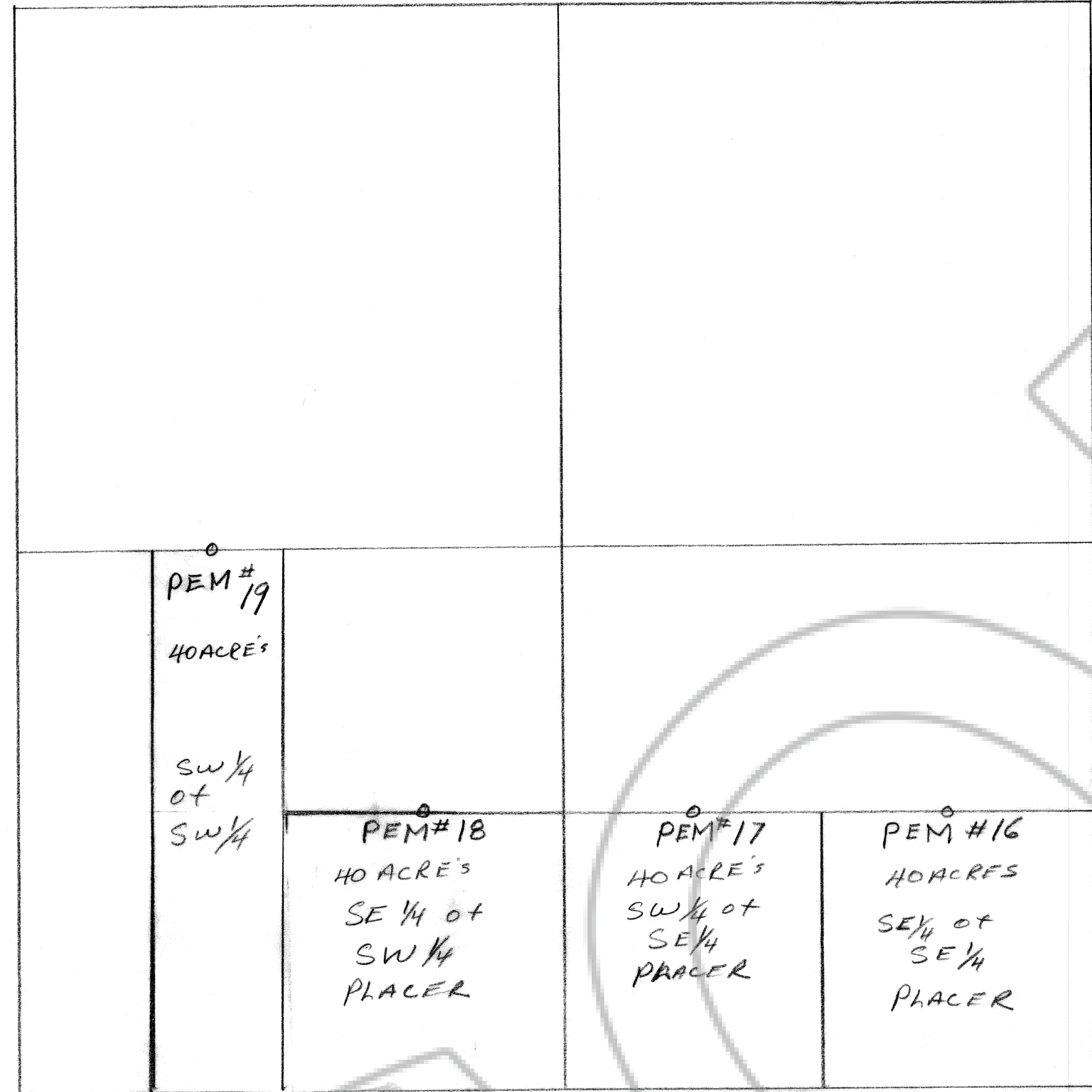

N

SCALE 1" = 500'

LEGEND
0 3" PVC PIPE

PHILIP FRANKLIN 1918 ROSEDALE AV
 LAS CRUCES NM 88001
 EDWARD AND MARY ELLEN WILLARD
 305 FALCON LN LAS VEGAS NV 89107

RECORDERS STAMP
 No. 86105
 FILED AND RECORDED AT REQUEST OF
 ARTHUR C. LONE
 Jan. 7, 1987
 AT 55 MINUTES PAST 1 O'CLOCK
 P.M. IN BOOK 73 OF OFFICIAL
 RECORDS, PAGE 316 LINCOLN
 COUNTY, NEVADA.
 FRANK HULSE
 COUNTY RECORDER
 Marie Concha Deputy