

Lincoln County

AFFIDAVIT OF VALUE OF LABOR AND IMPROVEMENTS

STATE OF COLORADO)
) ss * LODE
County of PARK)

BEFORE ME, the subscriber, personally appeared Mark A. Bowron, who being duly sworn, saith that at least Five thousand four hundred and no/100 dollars' worth of work or improvements were performed or made upon the the following lode claims (see attachments):

<u>CLAIMS NAME</u>	<u>BLM NUMBER</u>	<u>LOCATION NOTICE RECORD</u>
		<u>BOOK</u> <u>PAGE</u>

SEE ATTACHMENTS

The character of the expenditures, labor, and improvements is as follows: geological mapping and sampling, geochemical analyses, road construction, drill pad construction, and core drilling.

situated in unknown Mining District, County of Lincoln, State of Nevada, as recorded in book (see attached), page (see attached), of the records of said Lincoln County, such expenditure made by or at the expense of JEDEDIAH MINERALS COMPANY, P. O. BOX 479, 500 FRONT STREET, FAIRPLAY, COLORADO 80440-0479 owners of said claims, for the year ending September, 1985, and for the purpose of holding said claims. Such expenditure made between the first day of September, 1985 and the first day of September, 1986.

Subscribed and sworn to me, this
20th. day of June, 1986.

Linda Sweetland
Linda Sweetland, Notary Public
My Commission Expires:
March 28, 1988

Mark A. Bowron
MARK A. BOWRON

Lincoln County

<u>CLAIMS NAME</u>	<u>BLM NUMBER</u>	<u>LOCATION NOTICE RECORD</u>	
		<u>BOOK</u>	<u>PAGE</u>
BW-124	260000	53	282
BW-125	260001	53	283
BW-127	260002	53	284
BW-137	260003	53	285
BW-138	260004	53	286
BW-145	260005	53	287
BW-146	260006	53	288
BW-147	260007	53	289
BW-148	260008	53	290
BW-168	279410	56	354
BW-169	279411	56	355
BW-170	279412	56	356
BW-171	279413	56	357
BW-172	279414	56	358
BW-173	279415	56	359
BW-174	279416	56	360
BW-175	279417	56	361
BW-176	279418	56	362
BW-177	279419	56	363
BW-178	279420	56	364
BW-179	279421	56	365
BW-180	279422	56	366
BW-181	279423	56	367
BW-182	279424	56	368
BW-183	279425	56	369
BW-184	279426	56	370
BW-185	279427	56	371
BW-186	279428	56	372
BW-187	279429	56	373
BW-188	279430	56	374
BW-189	279431	56	375
BW-190	279432	56	376
BW-191	279433	56	377
BW-192	279434	56	378
BW-193	279435	56	379
BW-194	279436	56	380
BW-195	279437	56	381
BW-196	279438	56	382
BW-197	279439	56	383
BW-198	279440	56	384
BW-199	279441	56	385
BW-200	279442	56	386
BW-201	279443	56	387
BW-202	279444	56	388
BW-203	279445	56	389
BW-204	279446	56	390
BW-205	279447	56	391
BW-206	279448	56	392
BW-207	279449	56	393

Lincoln County

<u>CLAIMS NAME</u>	<u>BLM NUMBER</u>	<u>LOCATION NOTICE RECORD</u> <u>BOOK</u>	<u>PAGE</u>
BW-208	279450	56	394
BW-209	279451	56	395
BW-210	279452	56	396
BW-211	279453	56	397
BW-212	279454	56	398

Lincoln County

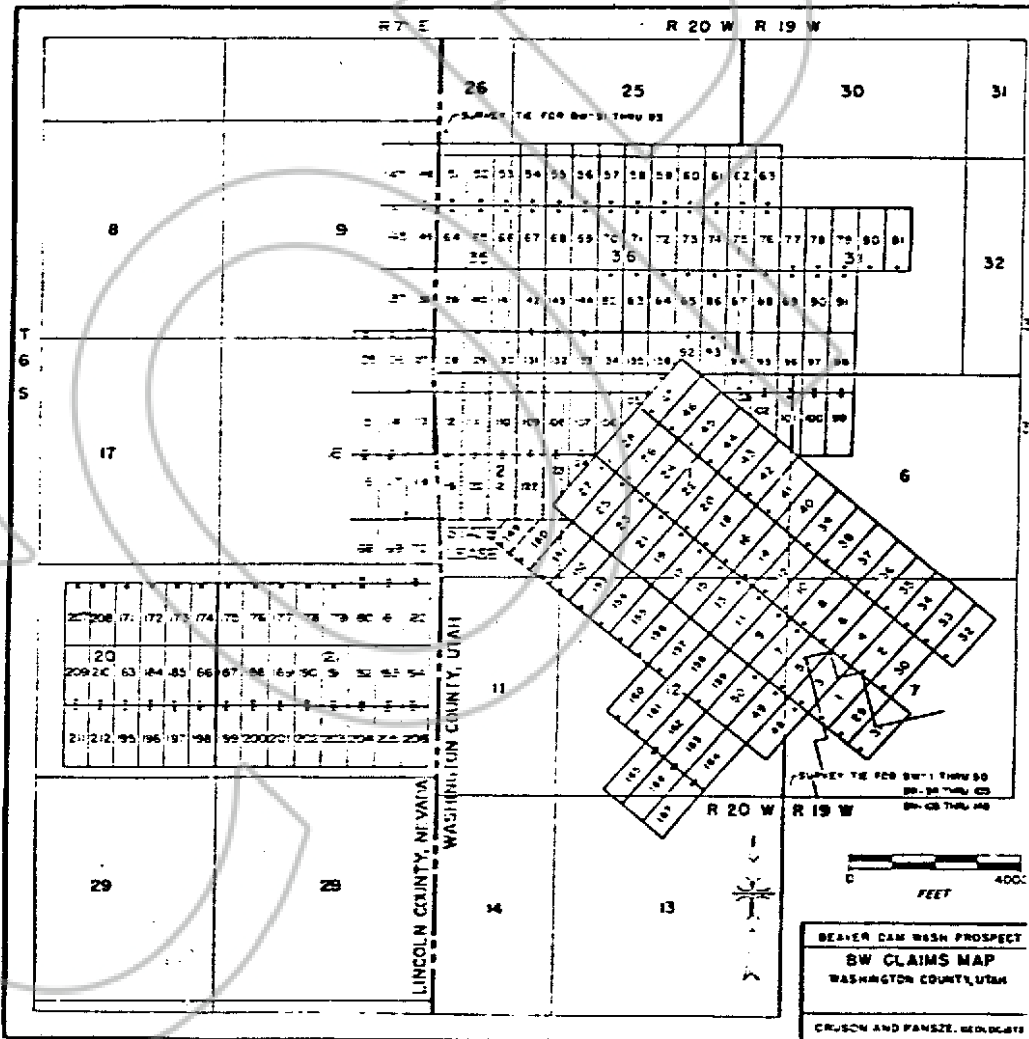

Lincoln County

COPY

No. 85180
FILED AND RECORDED AT REQUEST OF
Alma Americana Milling Corp.

June 23, 1986
AT 1 MINUTES PAST 1 O'CLOCK
P AM IN BOOK 71 OF OFFICIAL
RECORDS, PAGE 45 LINCOLN
COUNTY, NEVADA

Geniled Setzer
COUNTY RECORDER