

S17 516
S20 541

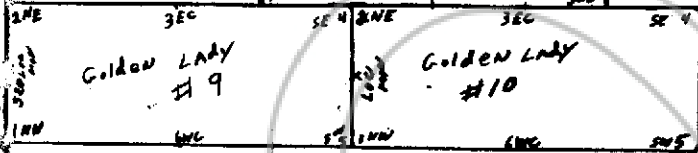
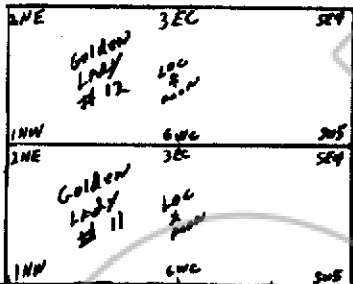

TDS
ACRE 5.17

TRUE NORTH ← SCALE 1" = 500'

MAP OF THE GOLDEN LADY LODE 9-12 Mining claim map
 IN SECTION S20 TOWNSHIP 13S RANGE 67E
 IN THE CHIEF Mining District
LINCOLN COUNTY NEVADA
 LOCATED ON THE 8 DAY OF DEC 1985, by
 LOCATOR NAME & ADDRESS
JERRY A. MAEDER Box 486 CAHENTE NV.
JUDY A. MAEDER Box 486 CAHENTE NV

RECORDER'S STAMP

No. 81617

FILED AND RECORDED AT REQUEST OF
JERRY MAEDER
FEA 26, 1986
 AT 45 MINUTES PAST 10 O'CLOCK
 A.M. IN BOOK 69 OF OFFICIAL
 RECORDS, PAGE 652 LINCOLN
 COUNTY, NEVADA
MURRAY SETZER
 COUNTY RECORDER
M. J. Conroy