

Lincoln County

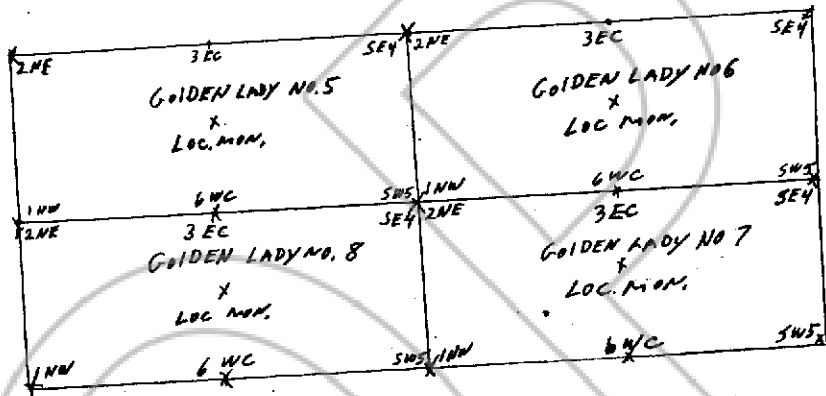

TRUE NORTH

SCALE 1" = 500'

Describe here the position of the Claim Location Monument, if one is used:

Map of the GOLDEN LADY LODE 1-8 Mining Claim Group,
 in Section 517-520 Township, T3S Range 67E,
 in the CHIEF Mining District,
LINCOLN County, Nevada.

Located on the 5 day of OCT, 1985, by

Locator name and address (please print)
JERRY A. MAEDER BOX 486 CALIENTE NEV.
JUDY A. MAEDER BOX 486 CALIENTE NEV.

RECORDER'S STAMP

No. **83888**

FILED AND RECORDED AT REQUEST OF
Jerry Maeder
Nov. 1, 1985

at 55 MINUTES PAST 11 O'CLOCK
 AM IN BOOK 68 OF OFFICIAL
 RECORDS, PAGE 190 LINCOLN
 COUNTY, NEVADA.

YURIKO SETZER
 COUNTY RECORDER

By Mara Corrie, Deputy

BOOK **68** PAGE **190**