

EASEMENT AGREEMENT

1 THIS EASEMENT AGREEMENT, made and entered into this 31<sup>st</sup>  
2 day of July, 198~~7~~<sup>5</sup>, by and between the undersigned, (here-  
3 inafter called "First Parties"), and LINCOLN COUNTY POWER DISTRICT  
4 NO. 1 (hereinafter called "Second Party");

5 W I T N E S S E T H:

6 WHEREAS, First Parties are the owners of the properties  
7 hereinafter referred to, situate and being in the County of  
8 Lincoln, State of Nevada, and

9 WHEREAS, Second Party is desirous of obtaining a right-of-  
10 way and easement over, under and across a portion of said property  
11 for the operation, maintenance and repair of a power line, and

12 WHEREAS, First Parties are desirous and willing to grant  
13 said easement and right-of-way for the purposes hereinabove set  
14 forth;

15 NOW, THEREFORE, for and in consideration of the premises  
16 and the terms, covenants, agreements and conditions hereinafter  
17 set forth, the said First Parties agree as follows:

18 1. To, and they do hereby, assign, grant and convey unto  
19 said Second Party, now and forever an easement and right-of-way  
20 for a power line over, under and across the hereinafter described  
21 tracts of land owned and hereby represented to be owned exclusive-  
22 ly by said First Parties and which said tracts of land are more  
23 particularly described as follows, to-wit:

24 The following are legal descriptions of the  
25 existing power transmission lines on or about  
26 the Mount Wilson Guest Ranch as delineated on  
27 the attached map listed as Exhibit "A" and  
28 located within Sections 34 and 35 of Township  
29 5 North, Range 67 East and Section 2 of Township  
30 4 North, Range 67 East, Mount Diablo Base &  
31 Meridian, being more particularly described as  
32 follows:

2

1  
2  
3  
4  
5  
6  
7  
8  
9  
10  
11  
12  
13  
14  
15  
16  
17  
18  
19  
20  
21  
22  
23  
24  
25  
26  
27  
28  
29  
30  
31  
32

Line A - Primary Service Line

Beginning at a point on the existing 22KV power transmission line to Mount Wilson from which the NW corner of said Section 35 and the NE corner of said Section 34 bears N 13° 06' 45" W a distance of 665.80 feet more or less; thence S 09° 07' E a distance of 517.83 feet; thence S 09° 15' 11" E a distance of 136.04 feet to an angle pole; thence S 28° 44' 58" W a distance of 263.07 feet to the service pole for Line A'2; thence, continuing S 28° 04' 16" W a distance of 270.48 feet to a transformer rack on which the 22KV line is reduced to a 2.4 KV service; thence continuing S 2° 53' 17" W a distance of 1,049.43 feet to an angle pole; thence continuing S 14° 25' 05" W a distance of 669.99 feet to an angle pole; thence S 2° 03' 18" W a distance of 806.26 feet to a service pole and the angle pole for Line A'3; thence continuing S 2° 11' 14" W a distance of 699.79 feet to an angle pole and service pole; (Said pole is tied to the SE Corner of said Section 34 S 38° 51' 33" E distance of 422.34 feet) thence continuing S 59° 56' 57" E a distance of 402.91 feet to the angle pole for service Line C; thence continuing S 59° 52' 05" E a distance of 755.06 feet to the angle pole for service Line D and Line E; thence S 59° 28' 26" E a distance of 378.22 feet to the End of the Primary Service Line A and the angle pole for service Lines F, G and H.

Line A'1

Beginning at a point on the existing 22KV power transmission line to Mount Wilson from which the NW corner of said Section 35 and the NE corner of said Section 34 bears N 13° 06' 45" W a distance of 665.80 feet more or less; thence N 53° 24' E along the primary Mount Wilson line a distance of 600 feet more or less to a service pole; thence S 11° 07' 30" E a distance of 94.74 feet more or less; thence S 20° 45' W a distance of 99.03 feet more or less.

Line A'2

Beginning at a point on the existing Primary Line A within the SW ¼ of the NW ¼ of Section 35; thence N 10° 50' 31" W a distance of 94.67 feet more or less; thence N 10° 41' 20" W a distance of 106.32 feet to an angle pole; thence S 11° 07' 30" E a distance of 136.38 feet; thence N 54° 38' 32" E a distance of 133.45 feet to the end of service.

*Richard Alfano*  
RICHARD ALFANO

*Lois Alfano*  
LOIS ALFANO

Line A'3

Beginning at a point on the existing Primary Line A within the SW 1/4 of the SW 1/4 of Section 34; thence S 75° 24' 53" W a distance of 1,610.27 feet to an angle pole; thence S 16° 01' 02" W a distance of 448.80 feet to a service pole.

Richard Alfano  
RICHARD ALFANO

Lois Alfano  
LOIS ALFANO

Eugene Alfano  
EUGENE ALFANO

Florentina Alfano  
FLORENTINA ALFANO

Richard Corn  
RICHARD CORN

Marie Corn  
MARIE CORN

Line B

Beginning at a point on the existing Primary Line A within the NE 1/4 of the NW 1/4 of Section 2; thence S 50° W a distance of 410 feet more or less to a service pole; thence S 06° W a distance of 330 feet more or less to a service pole.

Thorne J. Butler  
THORNE J. BUTLER

Katherine A. Butler  
KATHERINE A. BUTLER

Maureen Ann Slocum  
MAUREEN ANN SLOCUM

Richard Thomas McHugh  
RICHARD THOMAS MCHUGH

Eileen McHugh  
EILEEN MCHUGH

Clinton M. Bentley  
CLINTON M. BENTLEY

Patricia J. Bentley  
PATRICIA J. BENTLEY

Line C

Beginning at a point on the existing Primary Line A within the NE 1/4 of the NW 1/4 of Section 2; thence S 06° E a distance of 350 feet more or less to a service pole; thence S 10° W a distance of 300 feet more or less, to a service pole and angle pole; thence S 64° 07' 02" E a distance of 425.33 feet to the angle pole for Line C'1; thence S 64° 07' 02" W a distance of 738.33 feet to an angle pole for Line C'2; thence continuing S 12° W a distance of 1,100 feet more or less to a service pole.

Thorne J. Butler  
THORNE J. BUTLER

Katherine A. Butler  
KATHERINE A. BUTLER

Floyd Charles  
FLOYD CHARLES

Ashley C. Rice  
ASHLEY C. RICE

Leora O. Rice  
LEORA O. RICE

Albert C. Biederman  
ALBERT C. BIEDERMAN

Phyllis L. Biederman  
PHYLLIS L. BIEDERMAN

1  
2  
3  
4  
5  
6  
7  
8  
9  
10  
11  
12  
13  
14  
15  
16  
17  
18  
19  
20  
21  
22  
23  
24  
25  
26  
27  
28  
29  
30  
31  
32

Ralph M. Seeliger  
RALPH M. SEELIGER  
George L. Gildorf  
GILDORE FAMILY TRUST

Pauline Seeliger  
PAULINE SEELIGER

Kevin T. Orrock  
KEVIN T. ORROCK

Diana Orrock  
DIANA ORROCK

Line C'1

Beginning at a point on the existing Line C within the NE $\frac{1}{4}$  of the NW $\frac{1}{4}$  of Section 2; thence South a distance of 250 feet more or less to a service pole.

Ashley C. Rice  
ASHLEY C. RICE

Leora O. Rice  
LEORA O. RICE

Albert C. Biederman  
ALBERT C. BIEDERMAN

Phyllis L. Biederman  
PHYLLIS L. BIEDERMAN

Line C'2

Beginning at a point on the existing Line C within the SE $\frac{1}{4}$  of the NW $\frac{1}{4}$  of Section 2; thence N 67° W a distance of 220 feet more or less to a service pole.

Ralph M. Seeliger  
RALPH M. SEELIGER

Pauline Seeliger  
PAULINE SEELIGER

Walter Joseph Walter  
WALTER JOSEPH WALTER

Ruth Joseph-Walter  
RUTH JOSEPH-WALTER

Line D

Beginning at a point on the existing Primary Line A within the NW $\frac{1}{4}$  of the NE $\frac{1}{4}$  of Section 2; thence N 07° 59' 42" E a distance of 227.07 feet to a service pole.

George W. Galindo  
GEORGE W. GALINDO

Allen Eiring  
ALLEN EIRING

Lewis Lytle  
LEWIS LYTLE

Leroy Kelting  
LEROY KELTING

Wesley A. Holt  
THE WESLEY A. HOLT FAMILY TRUST

Line E

Beginning at a point on the existing Primary Line A within the NW $\frac{1}{4}$  of the NE $\frac{1}{4}$  of Section 2; thence S 01° 58' 06" E a distance of 325.39 feet to a service pole; thence continuing S 01° 58' 06" E a distance of 300 feet more or less, to a service pole; thence continuing S 55° W a distance of 120 feet more or less to a service pole.

George A. Galindo  
GEORGE A. GALINDO

Allen Eiring  
ALLEN EIRING

5

1  
2  
3  
4  
5  
6  
7  
8  
9  
10  
11  
12  
13  
14  
15  
16  
17  
18  
19  
20  
21  
22  
23  
24  
25  
26  
27  
28  
29  
30  
31  
32

*Lewis Lytle*  
LEWIS LYTLE

*Leroy Kelting*  
LEROY KELTING

*Wesley A. Holt*  
THE WESLEY A. HOLT FAMILY TRUST

Line E

Beginning at a point on the existing Primary Line A within the NW $\frac{1}{4}$  of the NE $\frac{1}{4}$  of Section 2; thence S 01° 58' 06" E a distance of 325.39 feet to a service pole; thence continuing S 01° 58' 06" E a distance of 300 feet more or less, to a service pole; thence continuing S 55° W a distance of 120 feet more or less to a service pole.

*George A. Galindo*  
GEORGE A. GALINDO

*Allen Eiring*  
ALLEN EIRING

*Lewis Lytle*  
LEWIS LYTLE

*Leroy Kelting*  
LEROY KELTING

*Philip C. Hulse*  
PHILIP C. HULSE

*Billie Jean Hulse*  
BILLIE JEAN HULSE

*Gerry Dale Hulse*  
GERRY DALE HULSE

*John R. McKay*  
JOHN R. MCKAY

*Wanda J. McKay*  
WANDA J. MCKAY

*Steven F. Windish*  
STEVEN F. WINDISH

*Helen G. Windish*  
HELEN G. WINDISH

Line F

Beginning at the end of the existing Primary Line A within the NW $\frac{1}{4}$  of the NE $\frac{1}{4}$  of Section 2; thence N 75° 11' 09" E a distance of 247.32 feet to a service pole.

*Ray Jeffers*  
RAY JEFFERS

Line G

Beginning at the end of the existing Primary Line A within the NW $\frac{1}{4}$  of the NE $\frac{1}{4}$  of Section 2; thence S 78° 26' 15" E a distance of 1,281.31 feet to an angle pole; thence continuing S 57° 15' 06" E a distance of 582.38 feet to a service pole.

*Ray Jeffers*  
R. Y. JEFFERS

*Inez Thomas*  
INEZ THOMAS

BARRARA SEVERANCE

*Gary C. Simmons*  
GARY C. SIMMONS

*Bonnie L. Simmons*  
BONNIE L. SIMMONS

*Leroy E. Hamilton*  
LEROY E. HAMILTON

*Anna B. Hamilton*  
ANNA B. HAMILTON

6

1  
2  
3  
4  
5  
6  
7  
8  
9  
10  
11  
12  
13  
14  
15  
16  
17  
18  
19  
20  
21  
22  
23  
24  
25  
26  
27  
28  
29  
30  
31  
32

Line H

Beginning at the end of the existing Primary Line A within the NW $\frac{1}{4}$  of the NE $\frac{1}{4}$  of Section 2; thence S 36° 06' 11" E a distance of 241.83 feet to a service pole.

*Ray Jeffers*  
RAY JEFFERS

*Inez Thomas*  
INEZ THOMAS

2. There is hereby given and granted to said Second Party all rights of ingress and egress necessary for the full use, occupation and enjoyment of the hereinabove referred to easement and right-of-way hereby granted, and to all rights and privileges incident thereto.

3. For and in consideration of the premises and the things to be done and performed by First Parties, Second Party agrees as follows:

(a) All work incident to the maintenance and repair of said power line shall be done and performed at the cost and expense of Second Party.

4. For and in consideration of the premises and the things to be done and performed by each of the parties hereto, it is mutually agreed by and between the parties hereto as follows:

(a) A copy of a Map, marked Exhibit "A" is attached hereto and made a part hereof for all purposes.

(b) This Agreement shall be binding upon and inure to the benefit of the heirs, successors, legal representatives and assigns of the respective parties hereto.

. . . . .  
. . . . .  
. . . . .  
. . . . .  
. . . . .  
. . . . .  
. . . . .  
. . . . .  
. . . . .  
. . . . .

7

1 IN WITNESS WHEREOF, the parties have hereunto caused the  
2 foregoing to be executed the day and year first above written.

3 Richard Alfano  
RICHARD ALFANO

Lois Alfano  
LOIS ALFANO

4 Eugene Alfano  
EUGENE ALFANO

Florentina Alfano  
FLORENTINA ALFANO

5 Richard Corn  
RICHARD CORN

Marie Corn  
MARIE CORN

6 Thorne J. Butler  
THORNE J. BUTLER

Katherine A. Butler  
KATHERINE A. BUTLER

7 Maureen Ann Slocum  
MAUREEN ANN SLOCUM

8 Richard T. McHugh  
RICHARD THOMAS MCHUGH

Eileen McHugh  
EILEEN MCHUGH

9 Clinton M. Bentley  
CLINTON M. BENTLEY

Patricia J. Bentley  
PATRICIA J. BENTLEY

10 Lloyd Charles  
LOYD CHARLES

11 Ashley C. Rice  
ASHLEY C. RICE

Leora O. Rice  
LEORA O. RICE

12 Albert C. Biederman  
ALBERT C. BIEDERMAN

Phyllis L. Biederman  
PHYLLIS L. BIEDERMAN

13 Ralph M. Seeliger  
RALPH M. SEELIGER

Pauline Seeliger  
PAULINE SEELIGER

14 Gilborf Family Trust  
GILBORF FAMILY TRUST

15 Kevin T. Orrock  
KEVIN T. ORROCK

Diana Orrock  
DIANA ORROCK

16 Joseph H. Walter  
JOSEPH H. WALTER

Ruth Joseph Walter  
RUTH JOSEPH WALTER

17 George A. Galindo  
GEORGE A. GALINDO

Allen Eiring  
ALLEN EIRING

18 Lewis Lytle  
LEWIS LYTLE

Veroy Kelting  
VEROY KELTING

19 The Wesley A. Holt Family Trust  
THE WESLEY A. HOLT FAMILY TRUST

20 Phillip C. Hulse  
PHILIP C. HULSE

Billie Jean Hulse  
BILLIE JEAN HULSE

21 Gerry Dale Hulse  
GERRY DALE HULSE

22 John R. McKay  
JOHN R. MCKAY

Wanda J. McKay  
WANDA J. MCKAY



1 Steven P. Windish  
STEVEN P. WINDISH

Helen G. Windish  
HELEN G. WINDISH

2 Ray Jeffers  
RAY JEFFERS

Inez Thomas  
INEZ THOMAS

3 BARBARA SEVERANCE

4 Gary C. Simmons  
GARY C. SIMMONS

Bonnie L. Simmons  
BONNIE L. SIMMONS

5 Leroy E. Hamilton  
LEROY E. HAMILTON

Anna B. Hamilton  
ANNA B. HAMILTON

6 LINCOLN COUNTY POWER DISTRICT NO. 1

7 By: [Signature]  
Its President

8 STATE OF NEVADA)  
9 Lincoln ) ss.  
10 COUNTY OF CLARK)

11 On the 22nd day of August, 1985, personally  
12 appeared before me, WR Orr, President of  
13 Lincoln County Power District No. 1, who acknowledged that he  
14 executed the above instrument.

15 Ronald J. Barnett  
16 NOTARY PUBLIC



17 NOTARY PUBLIC  
18 STATE OF NEVADA  
19 County of Lincoln  
20 RONALD J. BARNETT  
21 My Appointment Expires Sept. 1, 1988

- 22 . . . . .
- 23 . . . . .
- 24 . . . . .
- 25 . . . . .
- 26 . . . . .
- 27 . . . . .
- 28 . . . . .
- 29 . . . . .
- 30 . . . . .
- 31 . . . . .
- 32 . . . . .



1 STATE OF NEVADA )  
2 ) ss.  
3 COUNTY OF CLARK )

4 On the 17<sup>th</sup> day of May, 1984, personally  
5 appeared before me, RICHARD ALFANO, who acknowledged that he  
6 executed the above instrument.

7  CINDY ALEXANDER  
8 Notary Public-State of Nevada  
9 COUNTY OF CLARK  
10 My Appointment Expires Oct. 14, 1986

*Cindy Alexander*  
NOTARY PUBLIC

9 STATE OF NEVADA )  
10 ) ss.  
11 COUNTY OF CLARK )

12 On the 17<sup>th</sup> day of May, 1984, personally  
13 appeared before me, LOIS ALFANO, who acknowledged that she executed  
14 the above instrument.

15  CINDY ALEXANDER  
16 Notary Public-State of Nevada  
17 COUNTY OF CLARK  
18 My Appointment Expires Oct. 14, 1986

*Cindy Alexander*  
NOTARY PUBLIC

17 STATE OF NEVADA )  
18 ) ss.  
19 COUNTY OF CLARK )

20 On the 21<sup>st</sup> day of June 1985, 1984, personally  
21 appeared before me, EUGENE ALFANO, who acknowledged that he  
22 executed the above instrument.

23  CINDY ALEXANDER  
24 Notary Public-State of Nevada  
25 COUNTY OF CLARK  
26 My Appointment Expires Oct. 14, 1986

*Cindy Alexander*  
NOTARY PUBLIC

25 STATE OF NEVADA )  
26 ) ss.  
27 COUNTY OF CLARK )

28 On the 21<sup>st</sup> day of June 1985, 1984, personally  
29 appeared before me, FLORENTINA ALFANO, who acknowledged that she  
30 executed the above instrument.

31  CINDY ALEXANDER  
32 Notary Public-State of Nevada  
33 COUNTY OF CLARK  
34 My Appointment Expires Oct. 14, 1986

*Cindy Alexander*  
NOTARY PUBLIC

1 STATE OF NEVADA)  
2 ) ss.  
3 COUNTY OF CLARK)

4 On the 17<sup>th</sup> day of May, 1984, personally  
5 appeared before me, RICHARD CORN, who acknowledged that he executed  
6 the above instrument.

7  CINDY ALEXANDER  
8 Notary Public-State of Nevada  
9 COUNTY OF CLARK  
10 My Appointment Expires Oct. 14, 1986

*Cindy Alexander*  
NOTARY PUBLIC

11 STATE OF NEVADA)  
12 ) ss.  
13 COUNTY OF CLARK)

14 On the 17<sup>th</sup> day of May, 1984, personally  
15 appeared before me, MARIE CORN, who acknowledged that she executed  
16 the above instrument.

17  CINDY ALEXANDER  
18 Notary Public-State of Nevada  
19 COUNTY OF CLARK  
20 My Appointment Expires Oct. 14, 1986

*Cindy Alexander*  
NOTARY PUBLIC

21 STATE OF NEVADA)  
22 ) ss.  
23 COUNTY OF CLARK)

24 On the 20<sup>th</sup> day of June 1985, 1984, personally  
25 appeared before me, THORNE J. BUTLER, who acknowledged that he  
26 executed the above instrument.

27  CINDY ALEXANDER  
28 Notary Public-State of Nevada  
29 COUNTY OF CLARK  
30 My Appointment Expires Oct. 14, 1986

*Cindy Alexander*  
NOTARY PUBLIC

31 STATE OF NEVADA)  
32 ) ss.  
COUNTY OF CLARK)

On the 20<sup>th</sup> day of June 1985, 1984, personally  
appeared before me, KATHERINE A. BUTLER, who acknowledged that she  
executed the above instrument.

 CINDY ALEXANDER  
Notary Public-State of Nevada  
COUNTY OF CLARK  
My Appointment Expires Oct. 14, 1986

*Cindy Alexander*  
NOTARY PUBLIC

1 STATE OF NEVADA )  
2 ) ss.  
3 COUNTY OF CLARK )

4 On the 17<sup>th</sup> day of May, 1984, personally  
5 appeared before me, MAUREEN ANN STOCUM, who acknowledged that she  
6 executed the above instrument.

7  CINDY ALEXANDER  
8 Notary Public-State of Nevada  
9 COUNTY OF CLARK  
10 My Appointment Expires Oct. 14, 1986

*Cindy Alexander*  
NOTARY PUBLIC

9 STATE OF NEVADA )  
10 ) ss.  
11 COUNTY OF CLARK )

12 On the 25<sup>th</sup> day of July, 1984, personally  
13 appeared before me, RICHARD THOMAS McHUGH, who acknowledged that he  
14 executed the above instrument.

15  CINDY ALEXANDER  
16 Notary Public-State of Nevada  
17 COUNTY OF CLARK  
18 My Appointment Expires Oct. 14, 1986

*Cindy Alexander*  
NOTARY PUBLIC

17 STATE OF NEVADA )  
18 ) ss.  
19 COUNTY OF CLARK )

20 On the 17<sup>th</sup> day of May, 1984, personally  
21 appeared before me, EILEEN McHUGH, who acknowledged that she  
22 executed the above instrument.

23  CINDY ALEXANDER  
24 Notary Public-State of Nevada  
25 COUNTY OF CLARK  
26 My Appointment Expires Oct. 14, 1986

*Cindy Alexander*  
NOTARY PUBLIC

25 STATE OF NEVADA )  
26 ) ss.  
27 COUNTY OF CLARK )

28 On the 17<sup>th</sup> day of May, 1984, personally  
29 appeared before me, CLINTON M. BENTLEY, who acknowledged that he  
30 executed the above instrument.

31  CINDY ALEXANDER  
32 Notary Public-State of Nevada  
COUNTY OF CLARK  
My Appointment Expires Oct. 14, 1986

*Cindy Alexander*  
NOTARY PUBLIC

Lincoln County

1 STATE OF NEVADA)  
2 ) ss.  
3 COUNTY OF CLARK)

4 On the 17<sup>th</sup> day of May, 1984, personally  
5 appeared before me, PATRICIA J. BENTLEY, who acknowledged that she  
6 executed the above instrument.



*Cindy Alexander*  
NOTARY PUBLIC

9 STATE OF NEVADA)  
10 ) ss.  
11 COUNTY OF CLARK)

12 On the 10<sup>th</sup> day of June 1985, 1984, personally  
13 appeared before me, LLOYD CHARLES, who acknowledged that he  
14 executed the above instrument.



*Cindy Alexander*  
NOTARY PUBLIC

17 STATE OF NEVADA)  
18 ) ss.  
19 COUNTY OF CLARK)

20 On the 21<sup>st</sup> day of July, 1984, personally  
21 appeared before me, ASHLEY C. RICE, who acknowledged that he  
22 executed the above instrument.



*Cindy Alexander*  
NOTARY PUBLIC

25 STATE OF NEVADA)  
26 ) ss.  
27 COUNTY OF CLARK)

28 On the 21<sup>st</sup> day of July, 1984, personally  
29 appeared before me, LEORA O. RICE, who acknowledged that she  
30 executed the above instrument.



*Cindy Alexander*  
NOTARY PUBLIC

1 STATE OF NEVADA )  
2 ) ss.  
3 COUNTY OF CLARK )

4 On the 12 day of June, 1984, personally  
5 appeared before me, ALBERT C. BIEDERMAN, who acknowledged that he  
6 executed the above instrument.

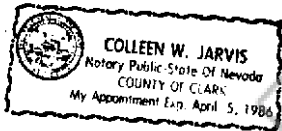

*Colleen W. Jarvis*  
NOTARY PUBLIC

9 STATE OF NEVADA )  
10 ) ss.  
11 COUNTY OF CLARK )

12 On the 12 day of June, 1984, personally  
13 appeared before me, PHYLLIS L. BIEDERMAN, who acknowledged that she  
14 executed the above instrument.



*Colleen W. Jarvis*  
NOTARY PUBLIC

17 STATE OF NEVADA )  
18 ) ss.  
19 COUNTY OF CLARK )

20 On the 14 day of June 1985, 1984, personally  
21 appeared before me, RALPH M. SEELIGER, who acknowledged that he  
22 executed the above instrument.



*Cindy Alexander*  
NOTARY PUBLIC

25 STATE OF NEVADA )  
26 ) ss.  
27 COUNTY OF CLARK )

28 On the 14 day of June 1985, 1984, personally  
29 appeared before me, PAULINE SEELIGER, who acknowledged that she  
30 executed the above instrument.



*Cindy Alexander*  
NOTARY PUBLIC

1 STATE OF NEVADA)  
2 COUNTY OF CLARK) ss.

3 On the 10th day of June 1985, 1984, personally  
4 appeared before me, Gary G. Isdorf as

5 \_\_\_\_\_ for the GILSDORF FAMILY TRUST, who acknow-  
6 ledged that he executed the above instrument.



Cindy Alexander  
NOTARY PUBLIC

10 STATE OF NEVADA)  
11 COUNTY OF CLARK) ss.

12 On the 21st day of July, 1984, personally  
13 appeared before me, KEVIN T. ORROCK, who acknowledged that he  
14 executed the above instrument.



Cindy Alexander  
NOTARY PUBLIC

18 STATE OF NEVADA)  
19 COUNTY OF CLARK) ss.

20 On the 21st day of July, 1984, personally  
21 appeared before me, DIANA ORROCK, who acknowledged that she  
22 executed the above instrument.



Cindy Alexander  
NOTARY PUBLIC

26 STATE OF NEVADA)  
27 COUNTY OF CLARK) ss.

28 On the 11th day of June 1985, 1984, personally  
29 appeared before me, ~~WALTER JOSEPH~~, who acknowledged that he  
30 executed the above instrument.  
Joseph Walter



Cindy Alexander  
NOTARY PUBLIC

1 STATE OF NEVADA)  
2 ) ss.  
3 COUNTY OF CLARK)

4 On the 11<sup>th</sup> day of June 1985, 1984, personally  
5 appeared before me, ~~RUTH JOSEPH~~, who acknowledged that she executed  
6 Ruth Walters  
7 the above instrument.

8  CINDY ALEXANDER  
9 Notary Public-State of Nevada  
10 COUNTY OF CLARK  
11 My Appointment Expires Oct. 14, 1986

Cindy Alexander  
NOTARY PUBLIC

9 STATE OF NEVADA)  
10 ) ss.  
11 COUNTY OF CLARK)

12 On the 21<sup>st</sup> day of June 1985, 1984, personally  
13 appeared before me, GEORGE A. GALINDO, who acknowledged that he  
14 ~~executed the above instrument.~~

15  CINDY ALEXANDER  
16 Notary Public-State of Nevada  
17 COUNTY OF CLARK  
18 My Appointment Expires Oct. 14, 1986

Cindy Alexander  
NOTARY PUBLIC

17 STATE OF NEVADA)  
18 ) ss.  
19 COUNTY OF CLARK)

20 On the 11<sup>th</sup> day of June 1985, 1984, personally  
21 appeared before me, ALLEN EIRING, who acknowledged that he executed  
22 the above instrument.

23  CINDY ALEXANDER  
24 Notary Public-State of Nevada  
25 COUNTY OF CLARK  
26 My Appointment Expires Oct. 14, 1986

Cindy Alexander  
NOTARY PUBLIC

25 STATE OF NEVADA)  
26 ) ss.  
27 COUNTY OF CLARK)

28 On the 10<sup>th</sup> day of June 1985, 1984, personally  
29 appeared before me, LEWIS LYTLE, who acknowledged that he executed  
30 the above instrument.

31  CINDY ALEXANDER  
32 Notary Public-State of Nevada  
COUNTY OF CLARK  
My Appointment Expires Oct. 14, 1986

Cindy Alexander  
NOTARY PUBLIC



1 STATE OF NEVADA )  
2 ) ss.  
3 COUNTY OF CLARK )

4 On the 10<sup>th</sup> day of June 1985, 1984, personally  
5 appeared before me, LEROY KELTING, who acknowledged that he  
6 executed the above instrument.

7  CINDY ALEXANDER  
8 Notary Public-State of Nevada  
9 COUNTY OF CLARK  
10 My Appointment Expires Oct. 14, 1986

*Cindy Alexander*  
NOTARY PUBLIC

9 STATE OF NEVADA )  
10 ) ss.  
11 COUNTY OF CLARK )

12 On the 28<sup>th</sup> day of May 1985, 1984, personally  
13 appeared before me, Wesley Holt, as  
14 \_\_\_\_\_ for THE WESLEY A. HOLT FAMILY TRUST, who

15  CINDY ALEXANDER  
16 Notary Public-State of Nevada  
17 COUNTY OF CLARK  
18 My Appointment Expires Oct. 14, 1986

*Cindy Alexander*  
NOTARY PUBLIC

18 STATE OF NEVADA )  
19 ) ss.  
20 COUNTY OF CLARK )

21 On the 1<sup>st</sup> day of June 1985, 1984, personally  
22 appeared before me, PHILIP C. HULSE, who acknowledged that he  
23 executed the above instrument.

24  CINDY ALEXANDER  
25 Notary Public-State of Nevada  
26 COUNTY OF CLARK  
27 My Appointment Expires Oct. 14, 1986

*Cindy Alexander*  
NOTARY PUBLIC

26 STATE OF NEVADA )  
27 ) ss.  
28 COUNTY OF CLARK )

29 On the 1<sup>st</sup> day of June 1985, 1984, personally  
30 appeared before me, BILLIE JEAN HULSE, who acknowledged that she  
31 executed the above instrument.

32  CINDY ALEXANDER  
Notary Public-State of Nevada  
COUNTY OF CLARK  
My Appointment Expires Oct. 14, 1986

*Cindy Alexander*  
NOTARY PUBLIC

1 STATE OF NEVADA)  
2 ) ss.  
3 COUNTY OF CLARK)

4 On the 11<sup>th</sup> day of June 1985, 1984, personally  
5 appeared before me, GERRY DALE HULSE, who acknowledged that he  
6 executed the above instrument.

7  CINDY ALEXANDER  
8 Notary Public-State of Nevada  
9 COUNTY OF CLARK  
10 My Appointment Expires Oct. 14, 1986

*Cindy Alexander*  
NOTARY PUBLIC

9 STATE OF NEVADA)  
10 ) ss.  
11 COUNTY OF CLARK)

12 On the 2<sup>nd</sup> day of July, 1984, personally  
13 appeared before me, JOHN R. McKAY, who acknowledged that he  
14 executed the above instrument.

15  CINDY ALEXANDER  
16 Notary Public-State of Nevada  
17 COUNTY OF CLARK  
18 My Appointment Expires Oct. 14, 1986

*Cindy Alexander*  
NOTARY PUBLIC

17 STATE OF NEVADA)  
18 ) ss.  
19 COUNTY OF CLARK)

20 On the 2<sup>nd</sup> day of July, 1984, personally  
21 appeared before me, WANDA J. McKAY, who acknowledged that she  
22 executed the above instrument.

23  CINDY ALEXANDER  
24 Notary Public-State of Nevada  
25 COUNTY OF CLARK  
26 My Appointment Expires Oct. 14, 1986

*Cindy Alexander*  
NOTARY PUBLIC

25 STATE OF NEVADA)  
26 ) ss.  
27 COUNTY OF CLARK)

28 On the 9<sup>th</sup> day of June 1985, 1984, personally  
29 appeared before me, STEVEN F. WINDISH, who acknowledged that he  
30 executed the above instrument.

31  CINDY ALEXANDER  
32 Notary Public-State of Nevada  
33 COUNTY OF CLARK  
34 My Appointment Expires Oct. 14, 1986

*Cindy Alexander*  
NOTARY PUBLIC

1 STATE OF NEVADA)  
2 ) ss.  
3 COUNTY OF CLARK)

4 On the 9th day of June 1985, 1984, personally  
5 appeared before me, HELEN G. WINDISH, who acknowledged that she  
6 executed the above instrument.

7  CINDY ALEXANDER  
8 Notary Public-State of Nevada  
9 COUNTY OF CLARK  
10 My Appointment Expires Oct. 14, 1986

*Cindy Alexander*  
NOTARY PUBLIC

11 STATE OF NEVADA)  
12 ) ss.  
13 COUNTY OF CLARK)

14 On the 20th day of June, 1985, personally  
15 appeared before me, RAY JEFFERS, who acknowledged that he executed  
16 the above instrument.

17  CHARLA L. SAMOLOVITCH  
18 Notary Public-State of Nevada  
19 COUNTY OF CLARK  
20 My Appointment Expires June 17, 1987

*Charla L. Samolovitch*  
NOTARY PUBLIC

21 STATE OF NEVADA)  
22 ) ss.  
23 COUNTY OF CLARK)

24 On the 28th day of May 1985, 1984, personally  
25 appeared before me, INEZ THOMAS, who acknowledged that she executed  
26 the above instrument.

27  CINDY ALEXANDER  
28 Notary Public-State of Nevada  
29 COUNTY OF CLARK  
30 My Appointment Expires Oct. 14, 1986

*Cindy Alexander*  
NOTARY PUBLIC

31 STATE OF NEVADA)  
32 ) ss.  
COUNTY OF CLARK)

On the \_\_\_\_\_ day of \_\_\_\_\_, 1984, personally  
appeared before me, BARBARA SEVERANCE, who acknowledged that she  
executed the above instrument.

NOTARY PUBLIC

1 STATE OF NEVADA )  
2 ) ss.  
3 COUNTY OF CLARK )

4 On the 20<sup>th</sup> day of June 1985, 1984, personally  
5 appeared before me, GARY C. SIMMONS, who acknowledged that he  
6 executed the above instrument.

7  CINDY ALEXANDER  
Notary Public-State of Nevada  
COUNTY OF CLARK  
My Appointment Expires Oct. 14, 1985

*Cindy Alexander*  
NOTARY PUBLIC

9 STATE OF NEVADA )  
10 ) ss.  
11 COUNTY OF CLARK )

12 On the 20<sup>th</sup> day of June 1985, 1984, personally  
13 appeared before me, BONNIE L. SIMMONS, who acknowledged that she  
14 executed the above instrument.

15  CINDY ALEXANDER  
Notary Public-State of Nevada  
COUNTY OF CLARK  
My Appointment Expires Oct. 14, 1985

*Cindy Alexander*  
NOTARY PUBLIC

17 STATE OF NEVADA )  
18 ) ss.  
19 COUNTY OF CLARK )

20 On the 21<sup>st</sup> day of July, 1984, personally  
21 appeared before me, LEROY E. HAMILTON, who acknowledged that he  
22 executed the above instrument.

23  CINDY ALEXANDER  
Notary Public-State of Nevada  
COUNTY OF CLARK  
My Appointment Expires Oct. 14, 1986

*Cindy Alexander*  
NOTARY PUBLIC

25 STATE OF NEVADA )  
26 ) ss.  
27 COUNTY OF CLARK )

28 On the 21<sup>st</sup> day of July, 1984, personally  
29 appeared before me, ANNA B. HAMILTON, who acknowledged that she  
30 executed the above instrument.

31  CINDY ALEXANDER  
Notary Public-State of Nevada  
COUNTY OF CLARK  
My Appointment Expires Oct. 14, 1986

*Cindy Alexander*  
NOTARY PUBLIC

1  
2  
3  
4  
5  
6  
7  
8  
9  
10  
11  
12  
13  
14  
15  
16  
17  
18  
19  
20  
21  
22  
23  
24  
25  
26  
27  
28

Line G

Beginning at the end of the existing Primary Line A within the NW $\frac{1}{4}$  of the NE $\frac{1}{4}$  of Section 2; thence S 78° 26' 15" E a distance of 1,281.31 feet to an angle pole; thence continuing S 57° 15' 06" E a distance of 582.38 feet to a service pole.

Notwithstanding any of the language above in the Easement Agreement, nor language in the Grant Bargain Sale Deed, the easement granted herein will be limited in width to 10 feet on either side of the center line for a total width of 20 feet.

*Barbra A. Severance*  
BARBARA A. SEVERANCE.

STATE OF CALIFORNIA )  
  ) SS  
COUNTY OF SAN DIEGO )

On the 31<sup>st</sup> day of July, 1985, before me, a Notary Public in and for said State, personally appeared BARBARA A. SEVERANCE, personally known to me or proved to me on the basis of satisfactory evidence to be the person whose name is subscribed to the within instrument and acknowledged that she executed the same.

WITNESS my hand and official seal.

*Lottie Jane Strachan*



No. 83285  
FILED AND RECORDED AT REQUEST OF  
Lincoln Co. Power Dist. #1  
August 23, 1985  
AT 5 MINUTES PAST 11 O'CLOCK  
IN BOOK 67 OF OFFICIAL  
RECORDS, PAGE 65 LINCOLN  
COUNTY, NEVADA.

*Frankie Nelson*  
COUNTY RECORDER

BOOK 67 PAGE 84

# EXHIBIT "A"

## SURVEYOR'S STATEMENT

I, Frank C. Hulse a duly Registered Land Surveyor in the State of Nevada, as agent for Hulse Engineering Inc. does hereby certify that this map, accurately and completely delineates a survey made by me or under my direct supervision at the instance of Richard Altano for the Lincoln County Power District No. 1. This survey was completed on August 30th, 1983.

Frank C. Hulse R.L.S. 6498

## OWNER'S STATEMENT

I, Richard Altano, as principal owner and proprietor of the Mt. Wilson Power Distribution System do represent this as a true and accurate map of the existing facilities on and around the Mt. Wilson Guest Ranch, and dedicate this system to the Lincoln County Power District No. 1, this 1st day of Nov. 1983.

*Richard Altano*  
Richard Altano

Lois Altano

Amended Map completed Nov 7th, 1983.

Frank C. Hulse R.L.S. 6498

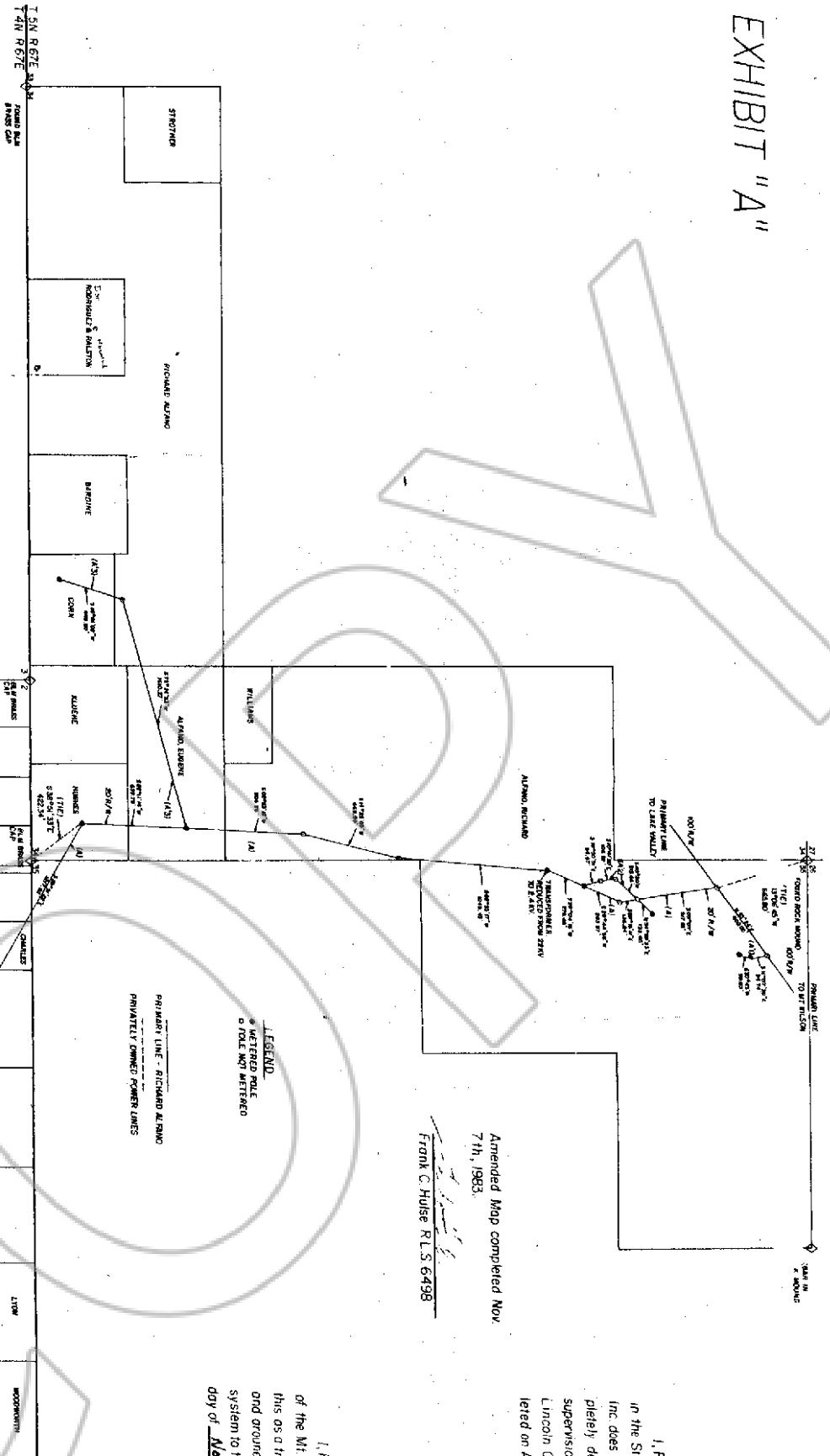

## ACKNOWLEDGEMENT

Subscribed and sworn to before this 1st day of November, 1983 Notary Public in and for Lincoln County, Nevada

MAP SHOWING POWER LINE RIGHTS-OF-WAY CROSSING PRIVATE GROUNDS, IN PORTIONS OF SECS. 34, 35, T.5N, R.67E, M.D.B. & M. & THE N/2 OF SEC. 2, T.4N, R.67E, M.D.B. & M.

BOOK 67 PAGE 36