

Lincoln County

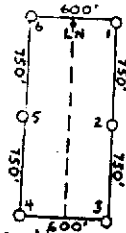

This diagram explains the method of description of the claim.

CERTIFICATE OF LOCATION - NEVADA

STATE OF NEVADA

COUNTY OF Lincoln } SS. Fee \$
At the request of Joseph W. Mueller No. _____
Filed for record this 19th day of
November 19 84, at 2:01
o'clock P. M. Reception No. 31578

Regorder Deputy

KNOW ALL MEN BY THESE PRESENTS, that Joseph W. Mueller, whose mailing address is 31248 Conifer Mtn. Drive, Conifer, Colorado 80433, hereby certifies that he has this 9 day of OCTOBER 1984, located and claimed and by these presents does locate and claim, in compliance with the Mining Acts of Congress, approved May 10, 1872, and all subsequent acts, and with local customs, laws and regulations, 1500 linear feet and horizontal measurement on the PROSPECT # 26 lode, vein, ledge or deposit, along the vein thereof, the general course of said vein being North/South with all its dips, angles and variations, as allowed by law, together with 300 feet on each side of the center of the vein at the surface, so far as can be determined from present developments, and all veins, lodes, ledges or deposits and surface ground within the lines of said claim, 20 feet running NORTH from the point of location monument and 1480 feet running SOUTH from the point of location monument; said location monument being situate upon said lode, vein, ledge or deposit, and within the lines of said claim, in the UNNAMED Mining District, County of LINCOLN and State of Nevada.

Said claim is located in the NE/4 of Sec. 13, SE/4 of Sec. _____, T. 4N, R. 67E, NW/4 of Sec. _____, SW/4 of Sec. _____

Mt. Diablo P. M., and more particularly described as follows, to wit: Beginning at the northeast corner Post No. 1,

- Thence, 750 feet in a due South direction to Post No. 2,
- Thence, 750 feet in a due South direction to Post No. 3,
- Thence, 600 feet in a due West direction to Post No. 4,
- Thence, 750 feet in a due North direction to Post No. 5,
- Thence, 750 feet in a due North direction to Post No. 6,
- Thence, 600 feet in a due East direction to Post No. 1,

the point of beginning and all posts being 4" X 4" X 5'. To tie this claim to the Public Survey, begin at the QUARTER corner, Section 12+13, Township 4N, Range 67E, Mt. Diablo P.M., bear EAST 2400 feet, and SOUTH 1500 feet to the northeast corner of this claim.

The location work consisted of making the map as provided in NRS 517.040. Dated NOVEMBER 8, A.D., 1984, and filed in duplicate.

JOSEPH W. MUELLER
31248 Conifer Mtn. Drive
Conifer, Colorado 80433
Phone: (303) 838-7732

By: Joseph W. Mueller
Locator

Witness: _____

STATE OF COLORADO }
COUNTY OF JEFFERSON } SS.

The foregoing instrument was acknowledged before me this 8 day of NOVEMBER, 1984, by Joseph W. Mueller.

Notary Public
My commission expires: Aug 17 1988