

- NOTES:
- At all Corners, Side Centers and Discovery Monuments are 4" diameter x 4 1/2' long posts with aluminum tags denoting the appropriate corners.
  - o = Corner and Side Center posts.  
• = Discovery Monuments
  - These claims are located by: David A. Bird  
P.O. Box 1911  
Reno, Nevada 89505
  - IRM No's 67 thru 72, 53, 54, 59, 60 located on July 20, 1984.  
IRM No's 73 thru 77, 61 thru 66 located on July 21, 1984.  
IRM No's 45, 46, 51, 52 located on July 22, 1984.  
IRM No's 47 thru 50, 23 thru 30, 1 thru 16, located on July 23, 1984.  
IRM No's 31 thru 44, 17 thru 22 located on July 25, 1984.  
IRM No's 56, 57, 58 located on September 27, 1984.
  - There are a total of 76 claims.

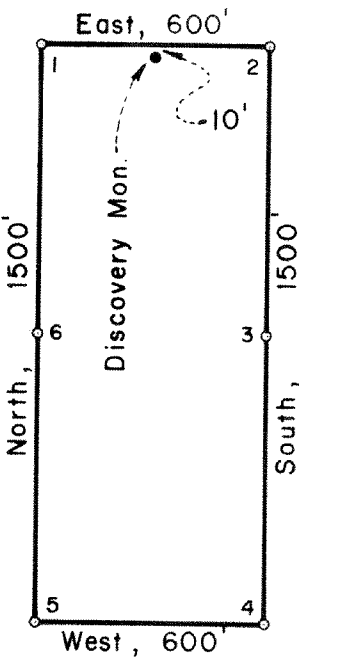

TYPICAL CLAIM  
Except as Shown and Noted

FILED AND RECORDED AT REQUEST OF  
*BOUNDY & FORMAN, Inc.*  
 Oct. 12, 1984  
 11:15 AM  
 11:15 AM  
 RECORDS, PAGE 376  
 COUNTY, NEVADA  
*David A. Bird*  
 500 1000 1500  
 Scale ~ 1" = 500'

COR. FOUND: Properly stamped B.L.M. brass cap (on Mount Diablo Base Line)  
 R.65 E. 229 1/2' W. 9500 72'  
 T.1 N. 34 X 35  
 T.1 S.

T.1 N., R.65 E., M.D.B. & M. T.1 N., R.66 E., M.D.B. & M.

SURVEYED & MAPPED BY  
 BOUNDY & FORMAN, INC.  
 ELY, NEVADA  
 JULY, AUG. & SEPT, 1984

MAP SHOWING  
 IRM LODE MINING CLAIMS  
 IN  
 T.1 N., R.65 & 66 E., M.D.B. & M.  
 LINCOLN COUNTY, NEVADA  
 FOR  
 DAVID A. BIRD