

R69E  
T35

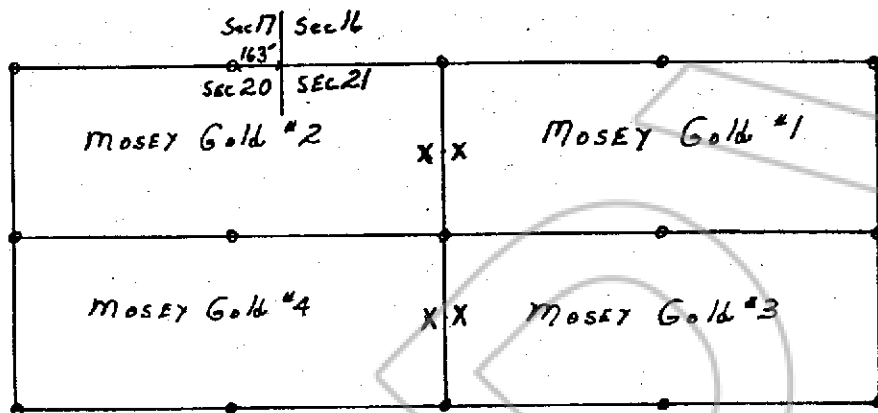

NORTH  
SCALE 1" = 500'

Describe here the position of the Claim Location Monument, if one is used.

Map of the Mosey Gold No 1,2,3,4 LODE Mining Claim Group,

in Section 20,21 Township 3S Range 69E

in the UNKNOWN Mining District,

Lincoln County, Nevada.

Located on the 27 day of April, 1983 by

Locator name and address (please print)

David A. Witts

Bruce A. Condie

Max McCrosky

SF#89063 Box 172  
Pioche Nevada 89043

RECORDER'S STAMP

No. 79886

FILED AND RECORDED AT REQUEST OF  
Max McCrosky  
May 2, 1984

AT 10 MINUTES PAST 10 O'CLOCK  
M IN THE BOOK 59 OF OFFICIAL

RECORDS, PAGE 520 LINCOLN  
COUNTY, NEVADA.

Yvonne Setzer  
COUNTY RECORDER