

ORIGINAL

RIGHT-OF-WAY EASEMENT

KNOW ALL MEN BY THESE PRESENTS, that WILLIAM and

ONALEE PIERPONT, husband and wife, of Caliente, Nevada

THE UNDERSIGNED, for a good and valuable consideration, the receipt whereof is hereby acknowledged, do hereby grant unto LINCOLN COUNTY POWER DISTRICT NO. 1, a municipal corporation of the State of Nevada, whose post office is Pioche, Nevada, and to its successors or assigns, the right to enter upon the lands and premises of the undersigned, situated in the County of Lincoln, State of Nevada, and more particularly described as follows:

Beginning at Station 0+00, said station being N.71° 44' 02" E. 2010.27' from the S. 1/4 Cor. of Sec. 14, T.3S., R.67E., M.D.B. & M. Thence S.62° 01' 59" E. 433.48' to Station 4+33⁴⁸ also the End of Project. The above described Right-of-Way is 20' wide, 10' each side of centerline.

and to construct, reconstruct, rephase, repair, operate and maintain on the above described lands and/or in or upon all streets, roads or highways abutting said lands, an electric transmission and/or distribution line or system; to cut, trim and control the growth by chemical means, machinery or otherwise of trees and shrubbery located within xxxxxxxx feet of the center line of said line or system, or that may interfere with or threaten to endanger the operation and maintenance of said line or system (including any control of the growth of other vegetation in the right-of-way which may incidentally and necessarily result from the means of control employed); and to license, permit, or otherwise agree to the joint use of occupancy of the line or system by any other person, association or corporation, for electrification or telephone purposes.

The undersigned agree that all poles, wires and other facilities including any main service entrance equipment, installed on the above described lands at the District's expense shall remain the property of the District, removable at the option of the District, upon termination of services to or on said lands.

The undersigned covenant they are the owners of the above described lands. (and that the said lands are free and clear of encumbrances and liens of whatsoever character except those held by the following persons:)

IN WITNESS WHEREOF, the undersigned have set their hands and seals this 12th day of October, 1983.

William Pierpont
Onalee Pierpont

State of NEVADA }
County of LINCOLN } ss.

The foregoing instrument was acknowledged before me this 12th day of October, 1983, by William Pierpont and Onalee Pierpont, husband and wife.

Witness my hand and official seal.

Carol A. Rosenlund

NOTARY PUBLIC
STATE OF NEVADA
County of Lincoln
Carol A. Rosenlund
My Appointment Expires June 6, 1984

No. 79633
FILED AND RECORDED AT REQUEST OF
Lincoln Co. Power Dist.
March 7, 1984
AT 5 MINUTES PAST 10 O'CLOCK
11 A.M. BOOK 59 OF OFFICIAL
RECORDS, PAGE 114 LINCOLN
COUNTY, NEVADA
Shirley A. [Signature]
COUNTY RECORDER

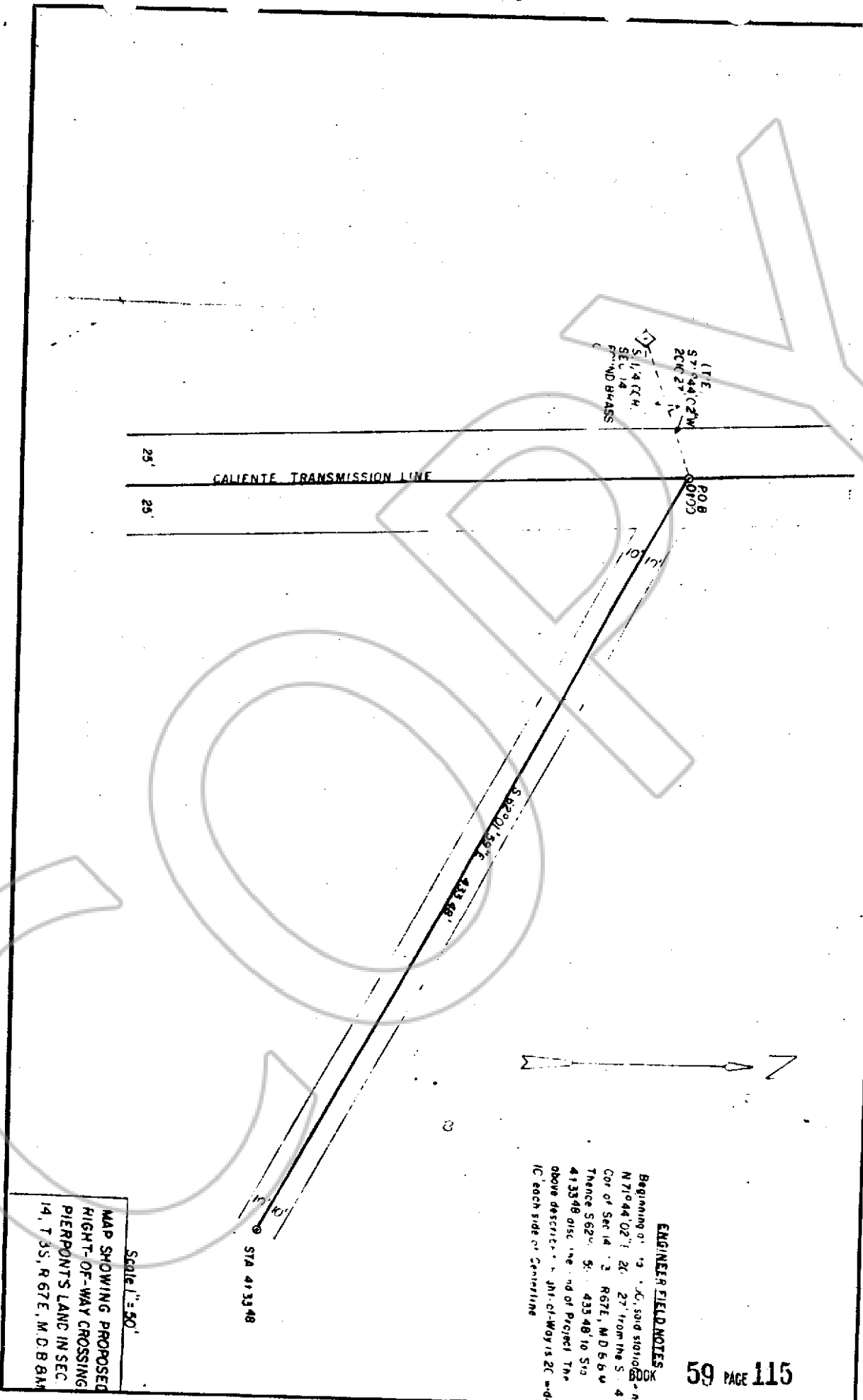

LITTLE
 57' 04" C/W
 20' 02" 27'
 S 1/4 R 67 E
 SEC 14
 T 35 N
 R 67 W
 M.D.B.M.

CALIENTE TRANSMISSION LINE

25'
25'

POB

3,882.01 ± 56.7
 433.48'

STA 413348



ENGINEER FIELD NOTES

Beginning of 13' 00" sag station
 N 71° 44' 02" E 20' 27" from the S.C.
 Cor of Sec 14 T 35 R 67 E, M.D.B.M.
 Thence S 62° 00' 50" E 433.48' to Sta
 413348 disc. the end of Project. The
 above description is the centerline
 10' each side of centerline

MAP SHOWING PROPOSED
 RIGHT-OF-WAY CROSSING
 PIERPONT'S LAND IN SEC.
 14, T 35, R 67 E, M. D. B. M.

Scale 1" = 50'