

SECTION 15

SECTION 14

SECTION 13

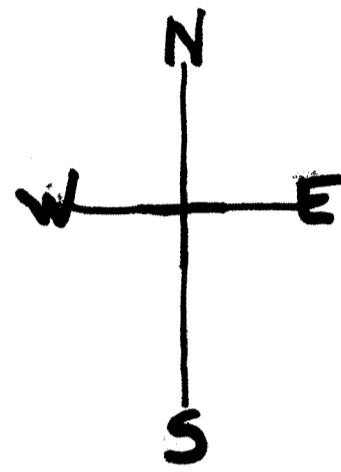

SK
Claims

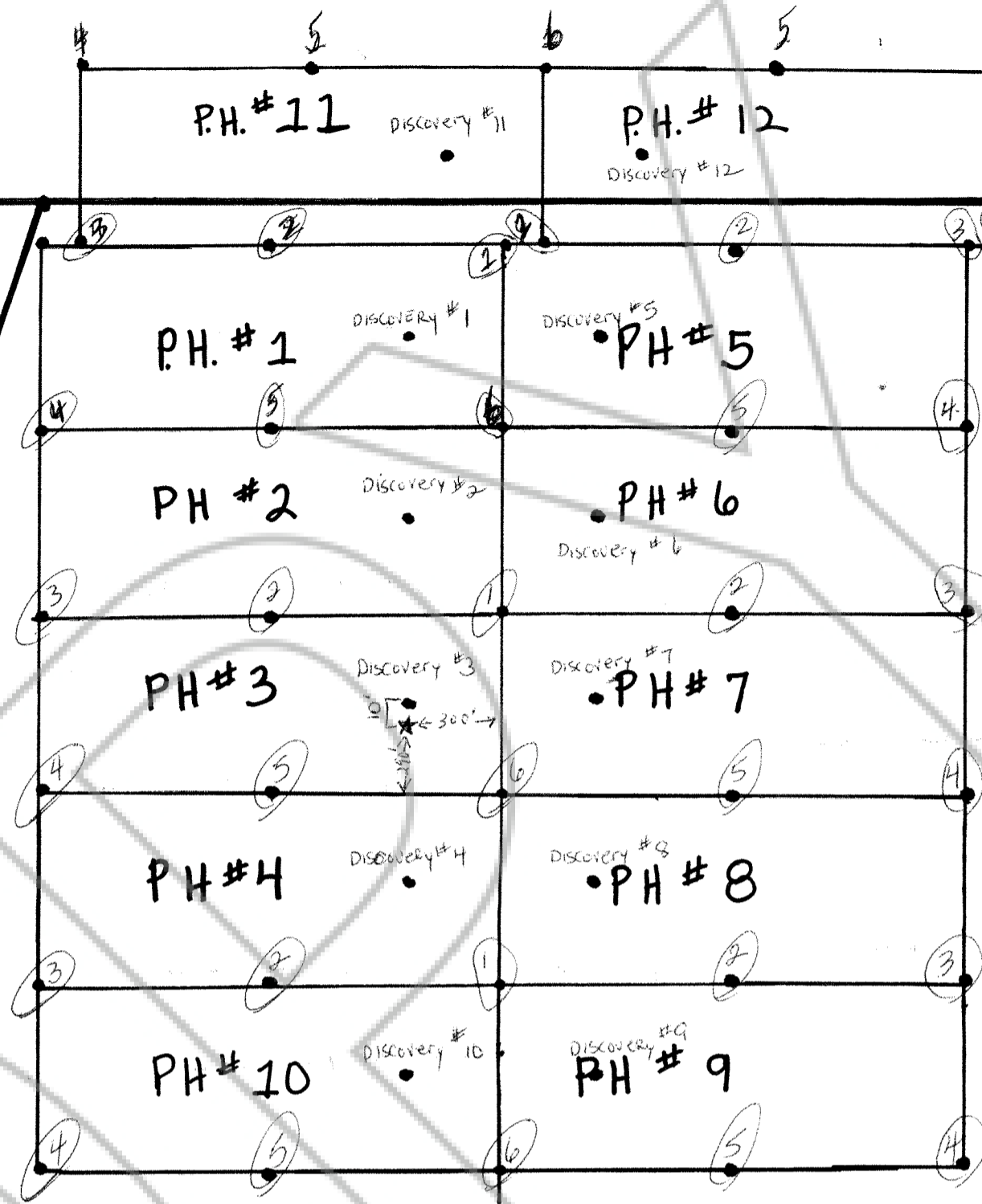

UNSURVEYED

TOWNSHIP 5 North
RANGE 63 East
of the Mount Diablo
MERIDIAN, NEVADA

POVERTY HELPER CLAIMS
SECTIONS 23 & 14
SILVER KING
Mining District
LINCOLN Co., NEVADA

Indicates boundary Lines
Poverty helper Claims

Claims 1500ft by 600ft
James Chavis

SECTION 23

SECTION 24 * Indicates Survey Monument
Rock Monument
REF. USGS, 7-5 Minutes Topographic Map
Sidehill Pass Nev

SECTION 22

SECTION 26

SECTION 25

SECTION 27

1 inch Equals 500ft



No. 77247
FILED AND RECORDED AT REQUEST OF
JAMES CHAVIS
FEB 25, 1983
AT 22 MINUTES PAST 2 O'CLOCK
P. M. OF BOOK 53 OF OFFICIAL
RECORDS, PAGE 561 LINCOLN
COUNTY, NEVADA.

Yvonne Selzer
COUNTY RECORDER