

MONARCH No 1 - 4033

TREASURE HILL No 4 4053

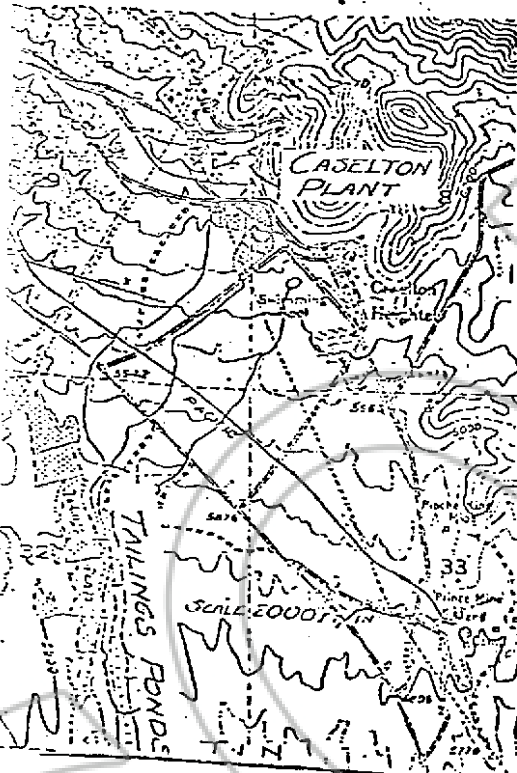

Description

Based upon the established coordinate system shown on surface maps of the Combined Metals Properties and represented on this map, the area intended to be reserved in connection with the operations of the Caselton Mill is described as follows:

Beginning at Corner 1, the NE corner of Lincoln County Power District No. 1, Main Distribution Substation area, (the coordinates of which are scaled from Plan General Arrangement Map D2-P on scale of 1 inch equals 100 ft.) thence east an approximate distance of 410 to Corner 2, thence south along coordinate 7300 E an approximate distance of 450 feet to corner 3, thence west along coordinate 12,500 N a distance of 400 feet to corner 4, thence south along coordinate 7700 E a distance of 900 feet to corner 5, thence west along coordinate 12,000 N a distance of 1100 feet to corner 6, thence north along coordinate 5600 E a distance of approximately 500 feet to west a line projected E 26° 24' W from corner 1, said course following along the east boundary of Lincoln County Power District No. 1 thence in a N 26° 24' E direction to corner 1, the point of beginning a distance of approximately 520 feet.

Above distances shown as "approximate" are subject to minor adjustment only to conform with actual coordinate position of the NE corner of Lincoln County Power District No. 1, parcel of land.

EXHIBIT "B"

Lincoln County

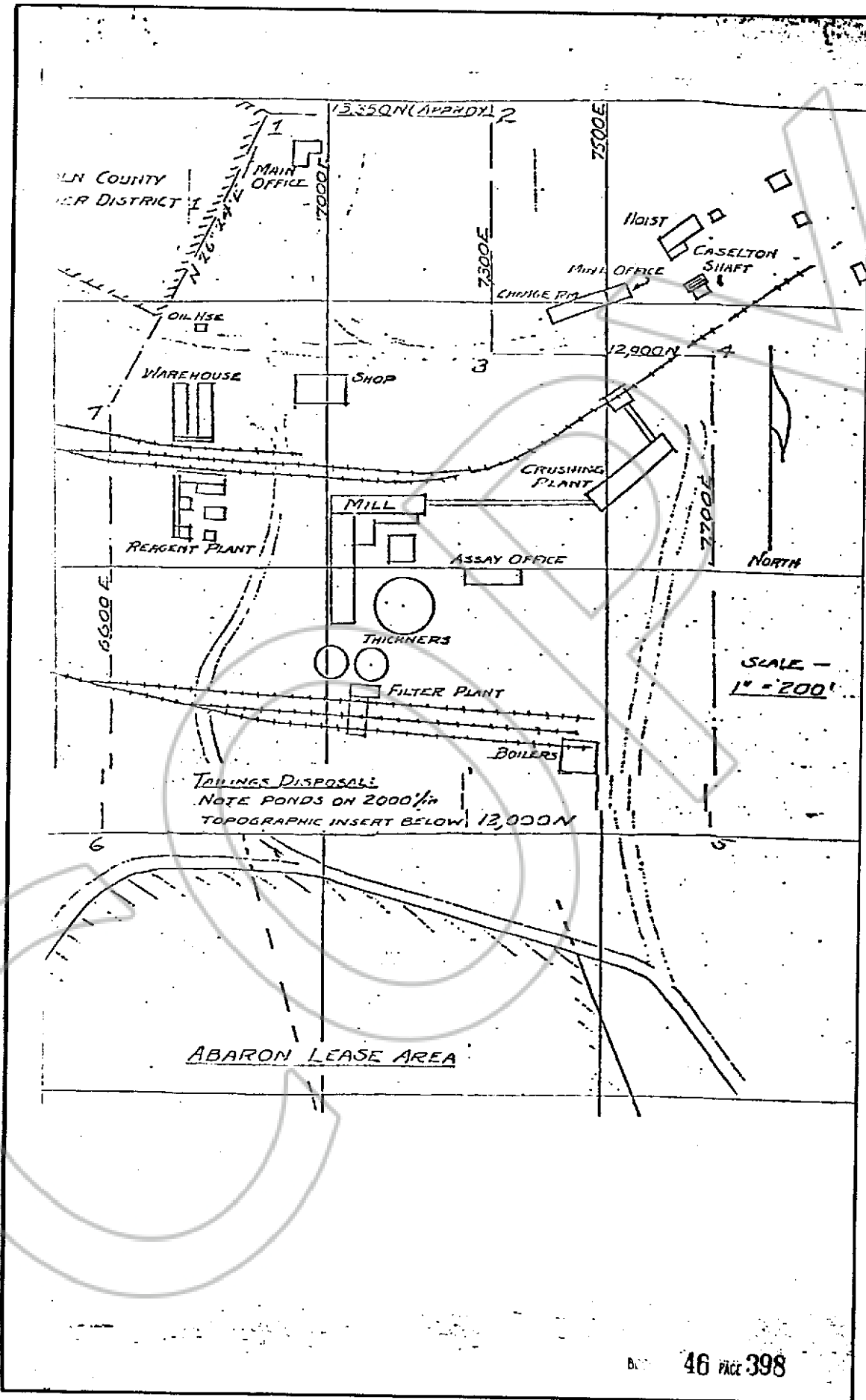

Lincoln County

CASELTON HEIGHTS AREA

The area containing the Caselton Heights Campsite is shown in Exhibit D and specifically described as the:

E1/2 SW1/4 SW1/4, W1/2 W1/2 SE1/4 SW1/4, SE1/4 NW1/4 SW1/4, S1/2 NE1/4 NW1/4 SW1/4, W1/2 SW1/4 NE1/4 SW1/4, S1/2 W1/2 NW1/4 NE1/4 SW1/4, Section 28, Township 1 North, Range 67 East, Mount Diablo Base & Meridian.

PERLITE PLANT AREA

The area known as the Perlite Plant Area consists of approximately five (5) acres and its location is indicated in Exhibit D. This area is bounded on the North by the Caselton Mine Highway right-of-way, on the East by the Caselton Mill Area as described in Exhibit B, on the South by the railroad right-of-way, which leads from the Caselton Mill Northwest past the Perlite Plant, and on the West by the West boundary of the SE-1/4 NW1/4 NE1/4, Section 29, Township 1 North, Range 67 East.

All of the Perlite Plant Area lies within the NW1/4 SE1/4 NE1/4, NE1/4 SW1/4 NE1/4, and the SE1/4 NW1/4 NW1/4, Section 29, Township 1 North, Range 67 East, Mount Diablo Base & Meridian.

TAILINGS AREA

That portion of the surface occupied by mill tailings in Section 32 of Township 1 North, Range 67 East, and Section 4, Township 1 South, Range 67 East, Mount Diablo Base & Meridian.

EXHIBIT "C"

Lincoln County

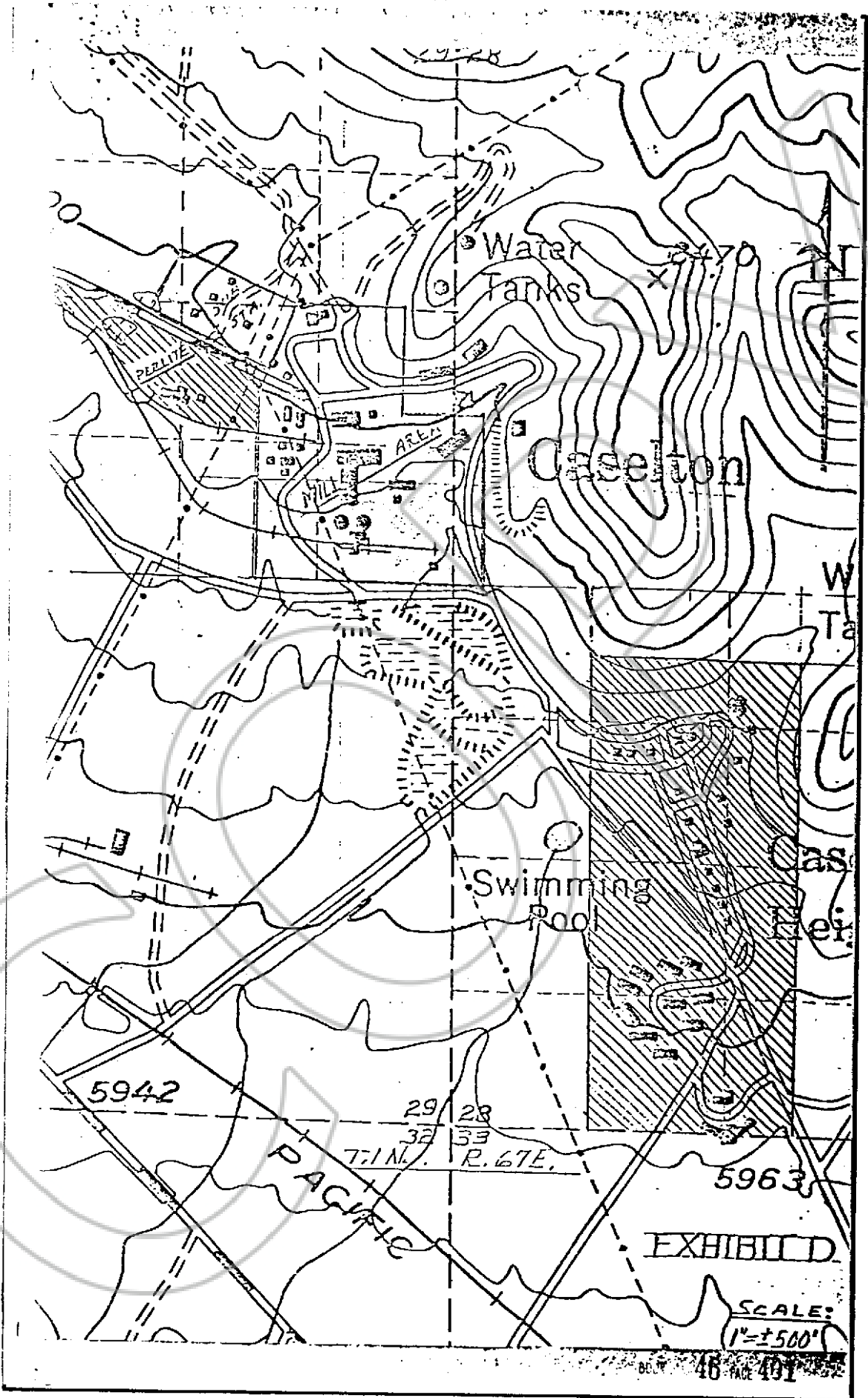
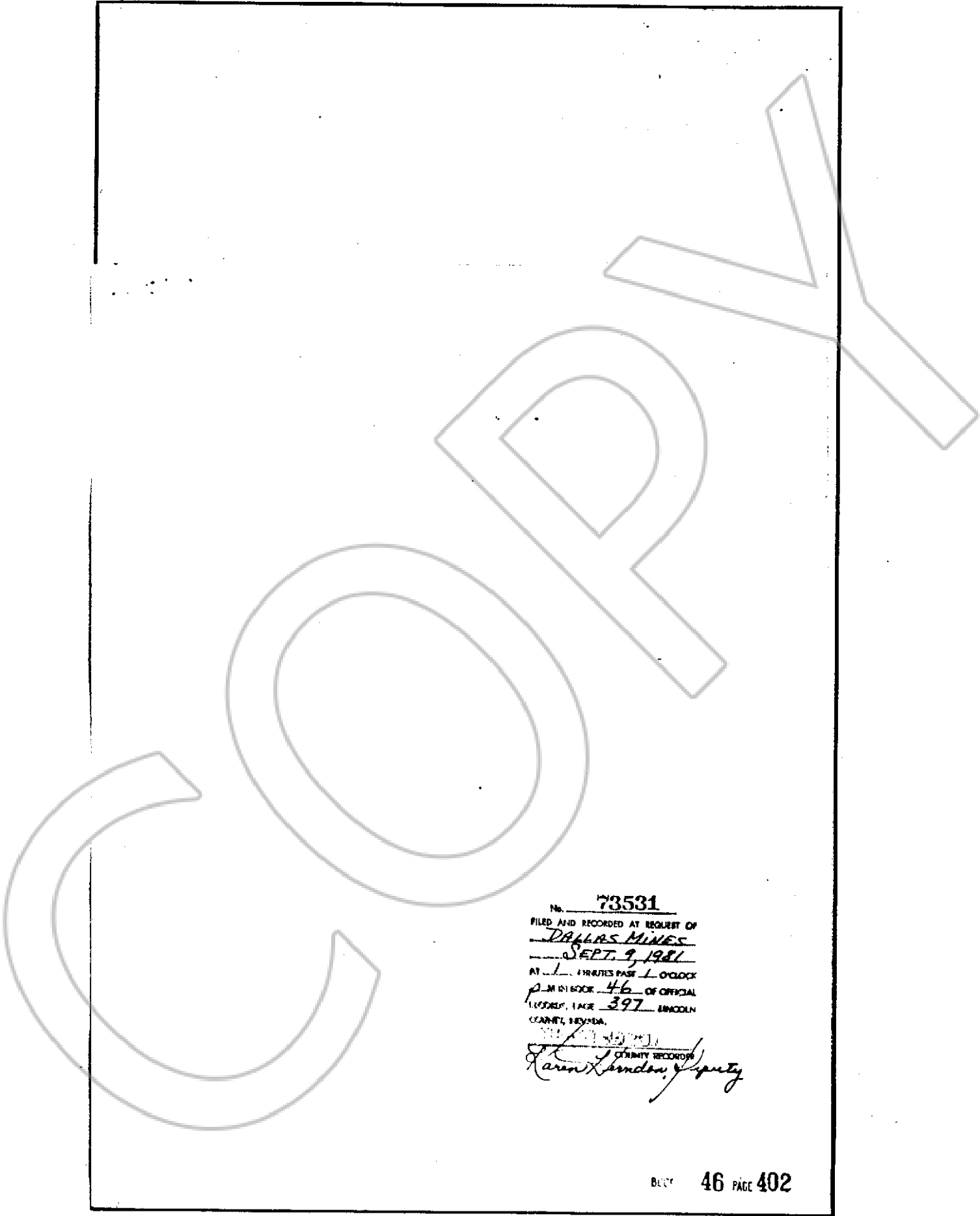

EXHIBIT D

SCALE:
1" = 500'



No. 73531
FILED AND RECORDED AT REQUEST OF
DALLAS MINES
SEPT. 9, 1981
AT 1 MINUTES PAST 1 O'CLOCK
P.M. IN BOOK 46 OF OFFICIAL
RECORDS, PAGE 397 LINCOLN
COUNTY, NEVADA.

RECORDED & INDEXED
COUNTY RECORDS
Karen London, Deputy