

Lincoln County

KNOW ALL MEN BY THESE PRESENTS, that STEVEN WEISS AGENT FOR AMOCO MINERALS CO. has located the JLC 13 lode Mining Claim, and by this certificate, and by right of discovery and location, claim 1500 feet, linear and horizontal measurement along the vein thereof, with all its dips, angles and variations, as allowed by law, 1470 feet on said vein running N 50° E from the discovery notice and 30 feet running S 50° W from the discovery notice together with 300 feet on each side of the middle of said vein at the surface, and all veins, lodes, ledges, deposits and surface ground within the lines of said claim, situated in the UNKNOWN Mining District, County of LINCOLN and State of Colorado, located in the SE 1/4 Sec. 9

R. 56 E., T. 2 N., HL Diablo P.M., and described by the metes and bounds as follows, to-wit:

- Beginning at Corner No. 1; Whence the U.S.L.M. No 278 BEARS: N 32° 56' E 7114'
- Thence, N 40° W 600 feet to Corner No. 2;
 - Thence, N 50° E 750 feet to the NORTH Side Center;
 - Thence, N 50° E 750 feet to Corner No. 3;
 - Thence, S 40° E 600 feet to Corner No. 4;
 - Thence, S 50° W 750 feet to the SOUTH Side Center;
 - Thence, S 50° W 750 feet to Corner No. 1, the point of beginning.

Location work consists of making maps as provided in N.R.S. 517.040

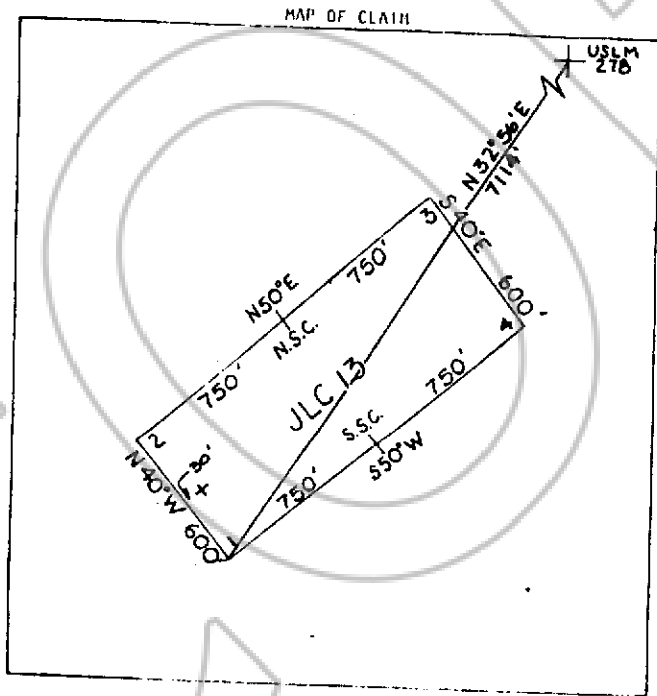

Said lode was discovered on JUNE 7, 1981

and located on JULY 16, 1981

Dated: JULY 16, 1981

Steven Weiss AGENT
 AMOCO MINERALS CO.
 333 W. Hampden Avenue
 Englewood, CO 80110

No. 73513
 FILED AT THE OFFICE OF THE COUNTY CLERK OF
 LINCOLN COUNTY, COLORADO
SEPT. 8, 1981
 AT 46 10

Kevin S. Seeger