

Lincoln County

N38W
1,970'

From post #6, Horse #20, the NE Cor. Sec. 21, T.2N., R.69E., bears N38W, a distance of approx. 1,970 feet.

Au #25 is part of claim group located by Joseph W. Mueller Route 1, Box 527 Conifer, Colorado

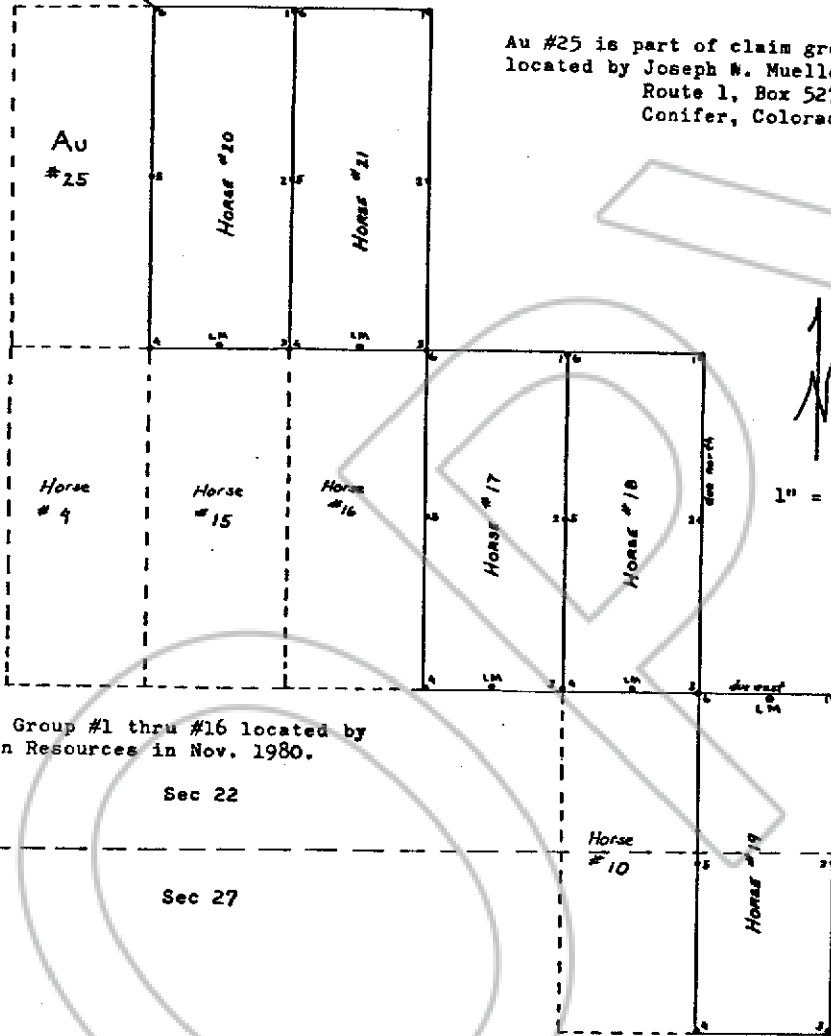

Horse Group #1 thru #16 located by Canyon Resources in Nov. 1980.

Sec 22

Sec 27

Describe here the position of the Claim Location Monument, if one is used.

Map of the Horse #17, #18, #19, #20, & #21 Mining Claim Group,

in Sections 22, 27 Township, 2N Range 69E,

in the Eagle Valley Mining District,

Lincoln County, Nevada.

Located on the 17th day of February, 1981, by

Canyon Resources Corporation
Locator name and address (please print)

2207 Jackson Street Suite B-101

Golden, Colorado 80401

Bert W. Jeffries, Agent

CARLISLE FORM NO. 58 N

RECORDER'S STAMP

No. 71947
FILED AND RECORDED AT REQUEST OF
BERT JEFFRIES
APR 1, 1981
AT 1 MIDDLES POINT 1 O'CLOCK
P.M. IN BOOK 43 OF OFFICIAL
RECORDS PAGE 410 LINCOLN
COUNTY, NEVADA.

YURIKO SETZER
Karen Henderson, Deputy

43 410