

Lincoln County

Filed for record the 29 day of Dec, A.D. 1980, at 3:30 P. YURIKO SETZER RECORDER.  
Reception No 70864 By William B. Killip DEPUTY

Filed at request of Minerals Service Co., Book 41, Page 203

STATE OF NEVADA)  
SS.  
COUNTY OF LINCOLN)

KNOW ALL MEN BY THESE PRESENTS, That Hunt Oil Company of Nevada, Minerals Division, has this 16th day of November, 1980 located and claimed, and by these presents does locate and claim, by right of discovery and location, in compliance with the Mining Acts of Congress, approved May 10, 1872, and all subsequent acts, and with local customs, laws and regulations, 1500 linear feet and horizontal measurement on the MN#23 lode, vein ledge or deposit, along with the vein thereof, with all its dips, angles and variations, as allowed by law, together with 300 feet on the North side, and 300 feet on the South side of the middle of said vein, at the surface, so far as can be determined from present developments, and all veins, lodes, ledges or deposits and surface ground within the lines of said claim 1480 feet running West from the point of discovery monument and 20 feet running East from the point of discovery monument; said discovery monument being situate upon said lode, vein, ledge or deposit, and within the lines of said claim, in Undesignated Mining District, County of Lincoln and State of Nevada described by metes and bounds as follows, to-wit:

Beginning at Corner No. 1, the Northeast corner which is located 30,000 feet North and 4,200 feet East from the NE corner of Section 9, Township 6S, Range 64E, Mount Diablo Meridian, thence 750 feet West to the North side center; thence 750 feet West to the Northwest corner; thence 600 feet South to the Southwest corner; thence 750 feet East to the South side center; thence 750 feet East to the Southeast corner; thence 600 feet North to the point of beginning.

1. Legal Subdivision of the land upon which the claim is located, if such land is surveyed:  
Northeast Quarter of Section 10, Township 5 South, Range 64 East of the Mount Diablo Meridian, in the County of Lincoln, State of Nevada;
2. The monuments recited herein are 4" x 4" x 4 1/2" wood posts of native lumber and marked with metal tags identifying claim corners and side centers.
3. A map complying with NRS 517.040 has been prepared and will be filed in accordance with statutes.
4. The claim pattern with courses and distances of the boundary lines is as follows:

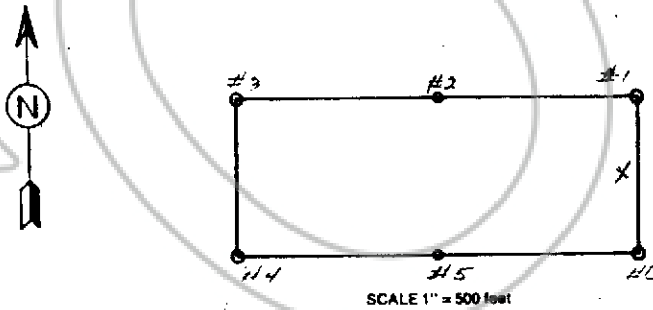

Said lode was discovered on the 16th day of November 1980

Date of Location, 11/16 A.D. 1980

Date of Certificate, 11/16 A.D. 1980

STATE OF COLORADO

COUNTY OF MESA

The foregoing instrument was acknowledged before me this 16th day of November, 1980

Witness my hand and official seal My commission expires

My Commission expires Jan. 10, 1983

Hunt Oil Company of Nevada

Minerals Division

P.O. Box 1317

Denver, Colorado 80201

By: [Signature] Agent

[Signature] Notary Public