

Lincoln County

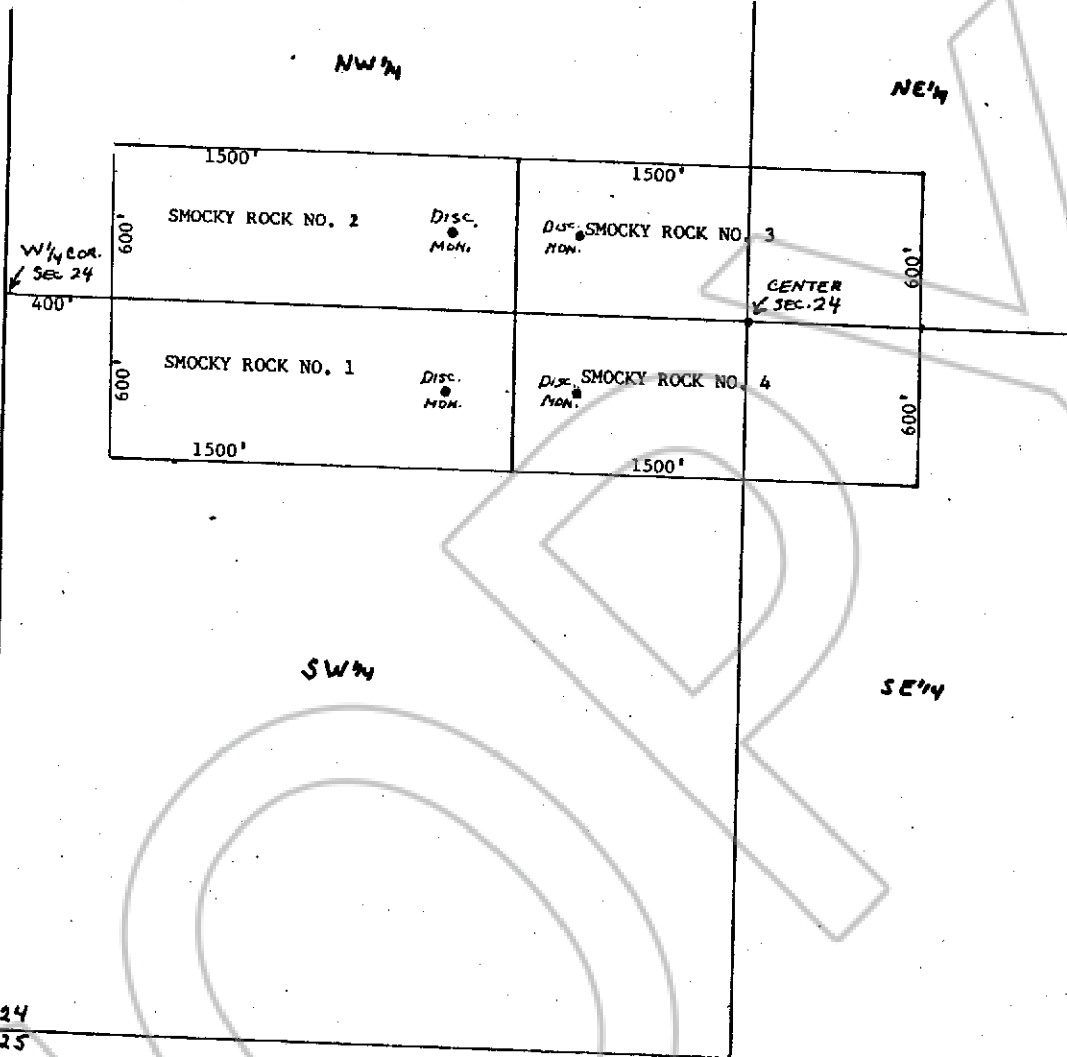

23 24
24 25

Describe here the position of the Claim Location Monument, if one is used.

Map of the SMOCKY ROCK Mining Claim Group
 in Section 24 Township, 5N, Range 68E,
 in the Unnamed Mining District,
Lincoln County, Nevada.

Located on the 25th day of June 19 80, by

- Wayne Pearson, Rt. Box 260, Pioche, Nevada
- Locators name and address (print or type)
- Keith Pearson, Rt. Box 260, Pioche, Nevada
- Roger Pearson, Rt. Box 260, Pioche, Nevada
- Lee Pearson, Rt. Box 260, Pioche, Nevada

No. 68982

Recorded at the request of

KEITH PEARSON

JULY 3, 1980

at 10 min past 10 AM

in Book 38 Official Records

of LINCOLN Co., Nevada,

at Page 164

Yvonne L. Lutz
 County Recorder