

32 33
5 4

33 34
4 3

34 35
3 2

T4N, R65E M.D.B. & M. 35 36
T3N, R65E M.D.B. & M. 2 1
(UNSURVEYED)

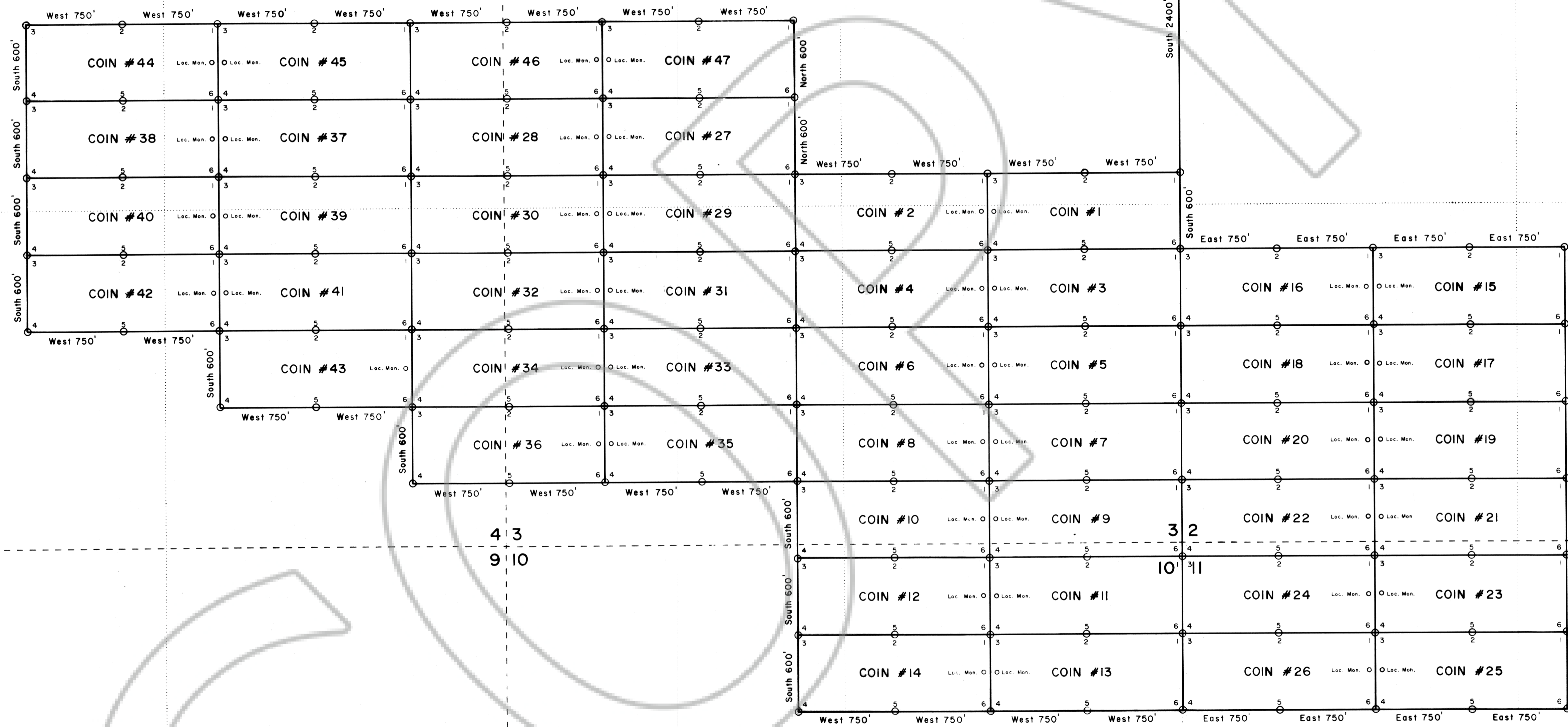

5 4
8 9

4 3
9 10

3 2
10 11

2 1
11 12

TRUE NORTH

NOTE: All location monuments, corners, and side centers are 4" X 4" wooden posts except the common corner for claims 3, 4, 5, & 6 which is a 6" diameter tree that has been topped and squared. All corners and side centers have a metal tag attached that is embossed with the appropriate description.

MAP OF THE
COIN NO. 1 thru 47
GROUP OF LODE MINING CLAIMS

SILVERHORN MINING DISTRICT
LINCOLN COUNTY, NEVADA

Sections 2, 3, 4, 10, & 11, T3N, R65E, M.D.B. & M.

Located by: Wesley R. Bury
P.O. Box 235
Erie, Colorado 80516

Coin # 1 thru 14 located 12 April 1980
Coin # 15 thru 26 located 13 April 1980
Coin # 27 thru 36 located 15 April 1980
Coin # 37 thru 47 located 24 April 1980

68649
FILED AND RECORDED AT REQUEST OF
WESLEY R. BURY
May 27, 1980
AT 53 MINUTES PAST 11 O'CLOCK
A.M. IN BOOK 37 OF OFFICIAL
RECORDS, PAGE 424 LINCOLN
COUNTY, NEVADA.
Spencer Schaefer
COUNTY CLERK

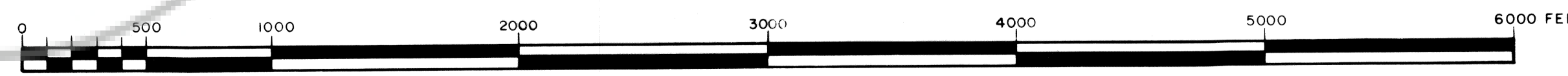

Scale 1" = 500'