

Lincoln County

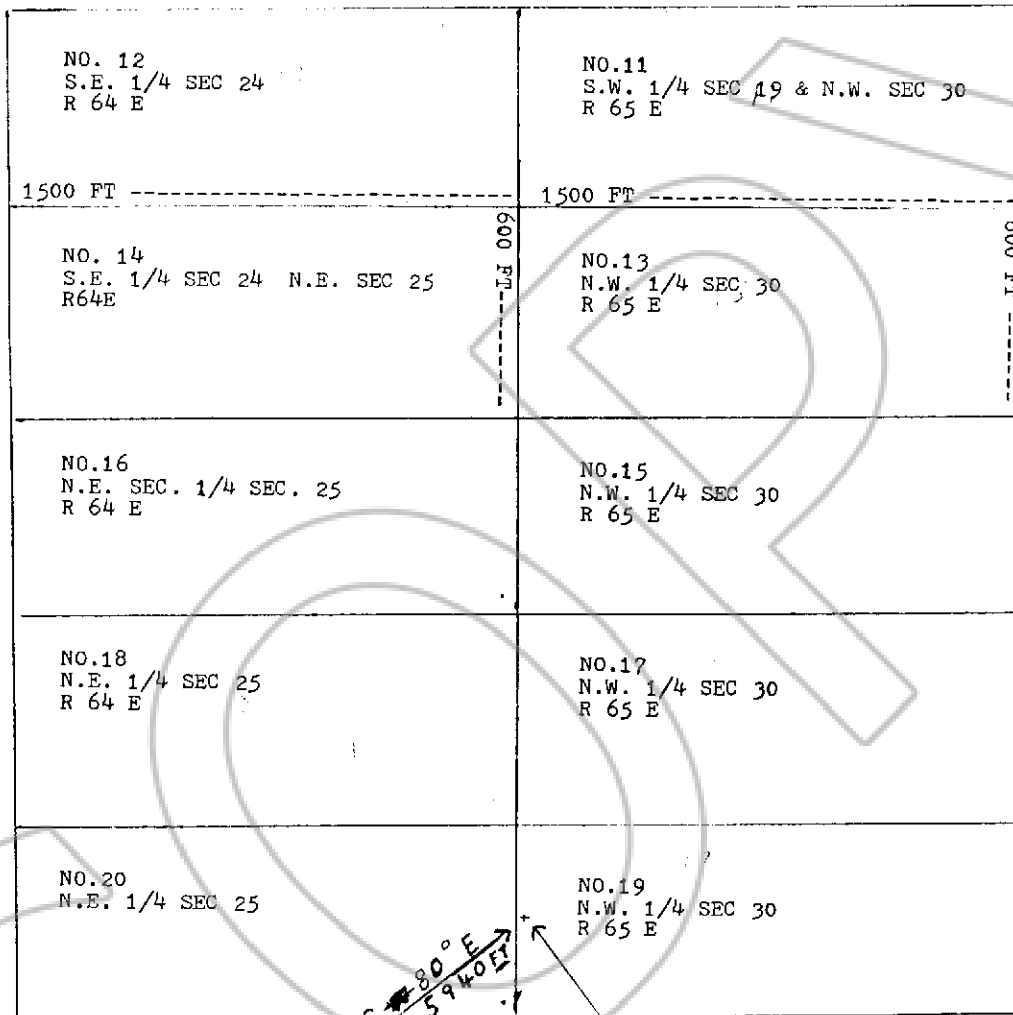

M D M MINING CLAIMS 11 THRU 20 SECTIONS 19-24=25=30
 TOWNSHIP 9 NORTH RANGE 64 & 65 EAST. MOUNT DIABLO MERIDIAN.
 PATTERSON MINING DISTRICT. LINCOLN COUNTY. NEVADA.
 (LOCATORS) EUGENE HODGES 426 SOUTH 400 EAST CEDAR CITY. UTAH
 (MAP E) JOINING MAP A TO THE NORTH & MAP D TO THE EAST.

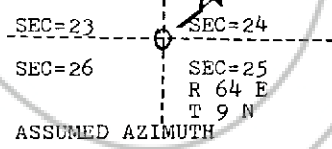

Eugene Hodges
James M. Hodges
Malon Walker
Solm Walker

DISCOVERY MONUMENT

No. **68523** Recorded at the request of Eugene Hodges at 9:45 A.m,
 this 6 day of December A.D. 1979, in Book 33 page 648 Official Record
 Lincoln County, Nevada.

County Recorder BUDA *Karen Anderson, Deputy* 33 PAGE 648