

TRUE
NORTH

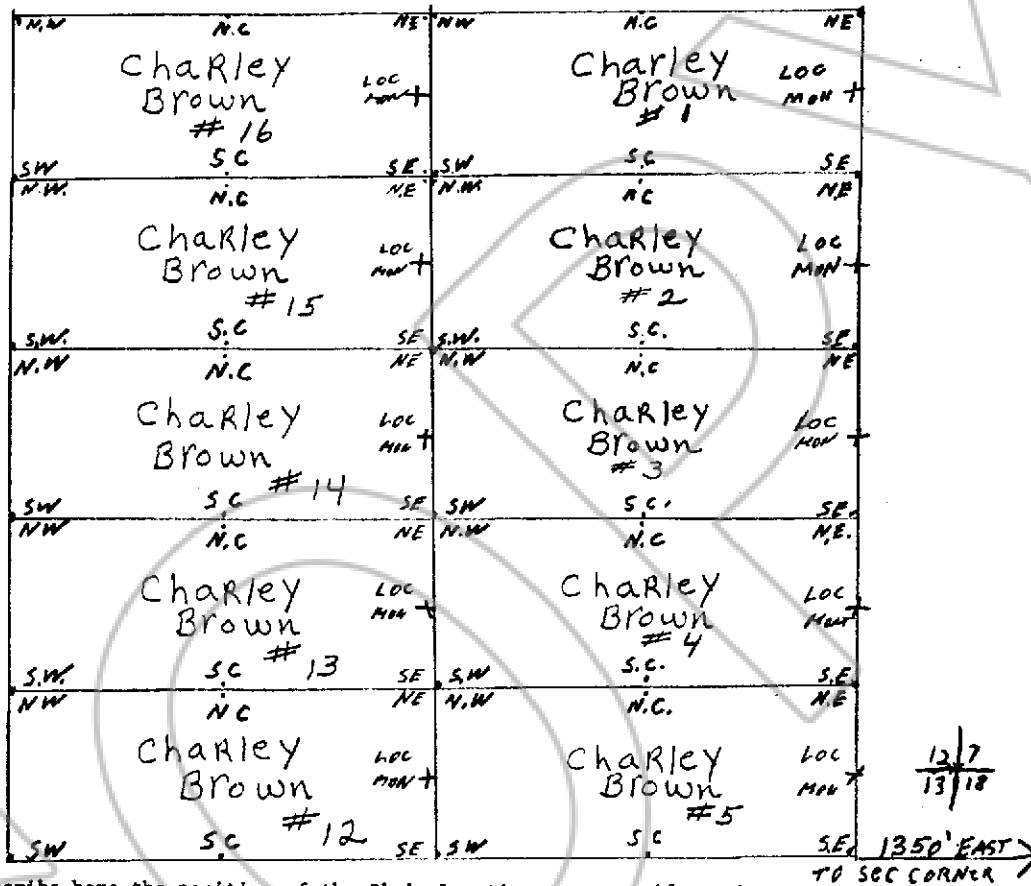

SCALE 1" = 500'



Describe here the position of the Claim Location monument if one is used.

Map of CHARLEY BROWN GROUP # 1 Mining Claim Group.

in Section 12 Township T4S Range 67E,

in the UNKNOWN Mining District,

LINCOLN County, Nevada.

Located on the 12 day of JAN 1979 by

Locator name and address (please print)

JERRY A. MAEDER

WALTER F. BROWN

CAHENTE, NEVADA 89008

RECORDER STAMP

63747

No.

FILED AND RECORDED AT REQUEST OF

JERRY MAEDER

FEBRUARY 16, 1979

AT 45 MINUTES PAST 4 O'CLOCK

P.M. IN BOOK 29 OF OFFICIAL

RECORDS, PAGE 94 LINCOLN

COUNTY, NEVADA

[Signature]
COUNTY RECORDER