

Lincoln County

STATE OF NEVADA
AMENDED MINING LOCATION CERTIFICATE
LODE CLAIM ON FEDERAL PUBLIC DOMAIN

STATE OF NEVADA

NOTICE IS HEREBY GIVEN that the IRON POINT EXTENTION WHITE SHAFT BLUE NOSE
NO. 2

lode mining claim is hereby amended as the BLUE NOSE #30 lode
mining claim. This claim was located by

LEO O. HOLT, MONA HOLT

on the 15 day of JUNE, 1964, and a copy of the location certi-
ficate is of record in the office of the Recorder of Lincoln County, Nevada in Book
V-1 page 400. This claim was previously amended as the BLUE NOSE #30
lode mining claim on the 1 day of OCTOBER, 1970, and a copy of the
amended location certificate is of record in the office of the Recorder of Lincoln
County, Nevada in Book 1 page 450.

The general course of this claim is NORTHERLY.
This claim is 1500 feet in length along the course of the claim, being 50
feet from the point of discovery in a SOUTHERLY direction to the
SOUTH end line of this claim, and 1,450 feet in a NORTHERLY
direction to the NORTH end line of the claim. This claim is 600 feet in
width, being 300 feet in width on each side of the center line of the claim.

This claim is located within the UNSURVEYED NE 1/4 of
Section 25, Township VIOLA 8S, Range 68E, Mount Diablo
Base and Meridian, VIOLA Mining District, Lincoln
County, Nevada. The location monument of this claim is situated with reference to
some natural object or permanent monument as follows: approximately 2390 feet in
an approximate S 18° 45' W. direction from the established common corner
of Sections 24 + 25 T. 8S, R. 68E. and Sections 19 + 30 T. 8S, R. 69E.

The corners of this claim are POSTS marked with the appropriate
corner number as shown on the following sketch and the accompanying claim map.

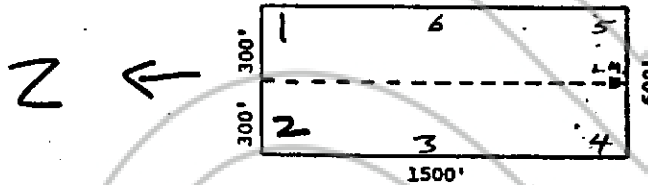

The location work consisted of making the maps as provided in NRS 517.040.

This amendment is made for the purposes of changing the name of the claim;
correcting any errors, defects or omissions in the original and amended location
certificates; complying with any requirements of the law that were not complied
with prior to filing the original and amended location certificates; acquiring
additional rights, if any, within the boundaries of this claim in compliance with
the laws of the United States and the State of Nevada; all without waiver of any
rights acquired within the above-described boundaries under the original location or
any prior amendment thereof.

Dated and posted on the ground this _____ day of SEPTEMBER, 1978.

OWNERS

- JAMES LEROY HOLT - 206 SOUTH 400 WEST, ST. GEORGE, UTAH 84770
- VIOLET G. HOLT - 206 SOUTH 400 WEST, ST. GEORGE, UTAH 84770
- MONA F. HOLT - 360 SOUTH 500 EAST, ST. GEORGE, UTAH 84770

By Nicholas A. Gentrycombe
Agent for Owners

STATE OF NEVADA)
) ss.
COUNTY OF LINCOLN)

I hereby certify that the within
instrument was filed and recorded at
the request of: AMAX ELP. CORP.
FILE NO. 63058
on NOV 1 1978
at 1:20 P. M.,
Book 27 Page 601

Witness my hand and official seal the
day and year aforesaid.

Dominick Beahm
County Recorder

By _____ BOOK 27 PAGE 601

Deputy Recorder