

Map Showing The Location of  
Pam Claims No. 75 thru No. 82  
Lode Mining Claims

T.6S., R.64E., Mount Diablo Base & Meridian  
Ferguson Mining District  
Lincoln County, Nevada

Scale: 1" = 500'



Found Brass Cap Section Corner



Found Brass Cap 1/4 Corner



Location Monument - 4" x 4" wooden post



Claim Boundary Monument - 4" x 4" wooden post

62072

FILED AND RECORDED AT REQUEST OF  
**NEVADANT EXPL. LTD**  
OCT 16 1978

AT 40 MINUTES TO 1 O'CLOCK  
P.M. BEFORE 27 OF OFFICIAL  
REC'D IN THE 471 L.S. CLERK  
COUNTY, NEVADA

*[Signature]*  
COUNTY CLERK

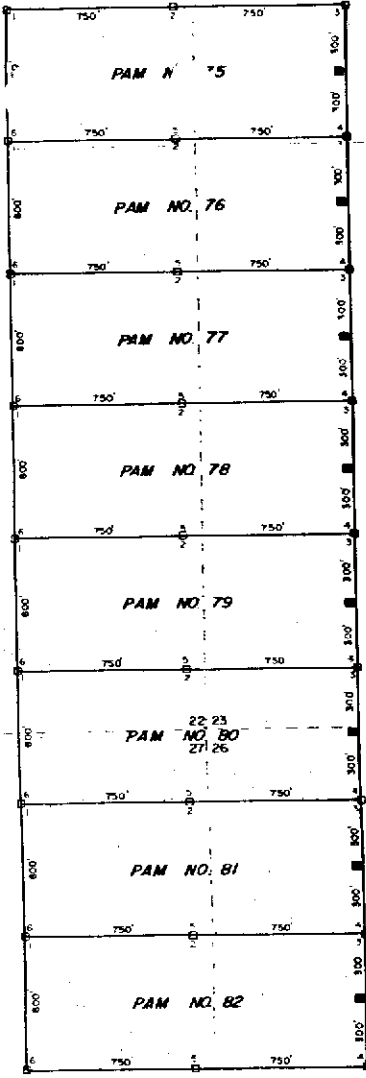

NW 1/4

SW 1/4

Pam  
Claim  
Group

NW 1/4

NE 1/4

S 72° W  
± 4840

Pam  
Claim  
Group

SE 1/4

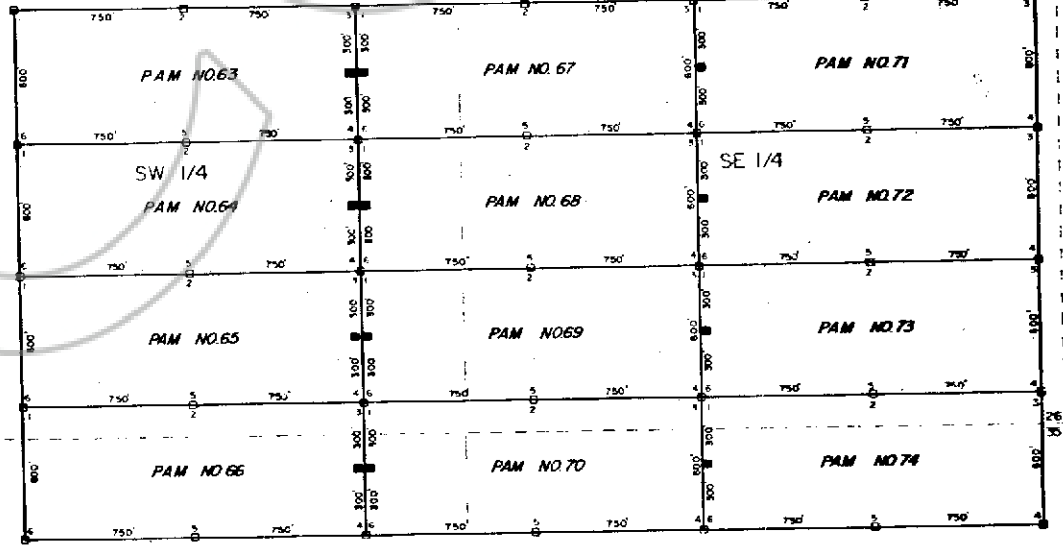

27 26  
34 35

1/4 Corner  
26 25

26 25  
34 35

26 25  
34 35

NE 1/4

NW 1/4

NE 1/4