

DEPT. OF WATER	
S15	S14
S12	S13
19	65

200' 90° 00'

CLAIMS / MARKERS

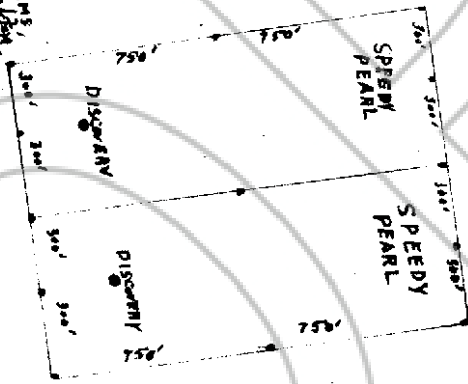

T55. R64 E SEC. 14  
 FERGUSON MIN. DISTILLING CO.  
 SCALE 1" = 500'  
 ALL STAKES MARKED WITH TOPS  
 SPEEDY PEARL LOPE  
 MAP IS 350' WEST OF TRUE NORTH  
 S 1/2 NW 1/4 + 1/8 OF SW 1/4 OF SEC. 14.

TRUE NORTH

MAG. NORTH

57320

No. 57320  
 FILED AND RECORDED AT REQUEST OF  
LRA McMAHAN  
Oct 21 1975  
 AT 46 MINUTES PAST 1 O'CLOCK  
P.M. IN BOOK 15 OF OFFICIAL  
 RECORDS, PAGE 476 LINCOLN  
 COUNTY, NEVADA.

*Official Recorder*  
 COUNTY RECORDER