

Lincoln County

ALL CLAIM BOUNDARIES ARE EAST-WEST
OR NORTH-SOUTH
ALL CLAIMS ARE 1500' LONG BY 600' WIDE

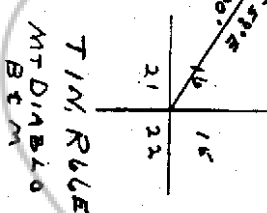
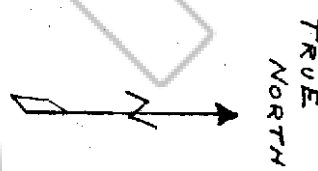
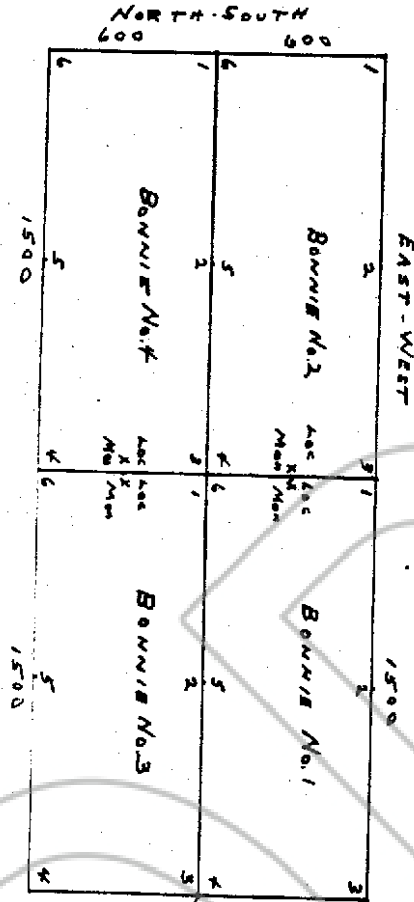

Describe here the position of the Claim Location monument if one is used.

Map of Bonnie Mining Claim Group.

in Section 16&21 Township 1 N Range 66E,
Mt. Diabloc B & M
in the Highland Mining District,
Lincoln County, Nevada.

Located on the 18th day of April 1974 by
F. L. Heidenreich, Box 18, 1130 Avenue L. East Ely,
Locator name and address (please print) Nevada
Darell H. Free, Panaca, Nevada

RECORDER STAMP

No. 51648

FILED AND RECORDED AT REQUEST OF
F. L. Heidenreich
July 10, 1974

AT 1 MINUTES PAST 1 O'CLOCK
P.M. IN BOOK 10 OF OFFICIAL
RECORDS, PAGE 521 LINCOLN
COUNTY, NEVADA.

[Signature]
COUNTY RECORDER