

### LODE LOCATION NOTICE EVERLASTING ARM CLAIM # 2

NOTICE IS HEREBY GIVEN THAT I, HUBERT C. FERREIRA, DO HEREBY LOCATE AND CLAIM 1500 LINEAR FEET OF THIS VEIN OR LOSE, TOGETHER WITH SURFACE GROUND EXTENDING 300 FEET IN WIDTH ON EACH SIDE OF THE MIDDLE OF SAID VEIN OR LOSE AND DESCRIBED AS FOLLOWS:

COMMENCING AT A POST WHERE THIS NOTICE IS POSTED, WHICH POST IS AT THE POINT OF DISCOVERY ON SAID VEIN OR LOSE AND ON THE CENTER LINE OF THIS LOCATION, I HEREBY CLAIM 1400 FEET EXTENDING IN A NORTHERLY DIRECTION ALONG THE COURSE OF SAID VEIN AND 100 FEET IN A SOUTHERLY DIRECTION. THE GENERAL COURSE OF THE VEIN OR LOSE IS NORTHERLY AND SOUTHERLY AS NEAR AS CAN BE DETERMINED FROM PRESENT DEVELOPMENTS. THE DISCOVERY MONUMENT IS SITUATED ABOUT 245 FEET IN A ~~SOUTHWESTERLY~~ SOUTHWESTERLY DIRECTION FROM A 1964 U.S. DEPT OF THE INTERIOR CADASTRAL SURVEY MARKER MENTIONED IN CLAIM # 1.

THE NAME OF THIS CLAIM IS EVERLASTING ARM # 2 AND IT IS SITUATED IN THE PLOCHE MINING DISTRICT, COUNTY OF LINCOLN, STATE OF NEVADA.

DATE: DECEMBER 22, 1973

Hubert C. Ferreira,  
HUBERT C. FERREIRA,  
LOCATOR  
P.O. BOX 77251  
SAN FRANCISCO, CAL.  
94107

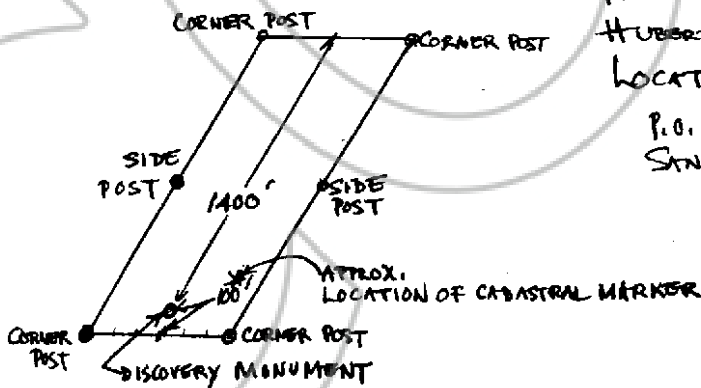

No. 53734 recorded at the request of Hubert C. Ferreira 1: 45 pm. this 27 day of December A.D. 1973 in Book 8 on page 695 Official Records of Lincoln County, Nev.

*Bruce B. Quinn*  
County Recorder