

LODE LOCATION NOTICE

NOTICE IS HEREBY GIVEN THAT I, HUBERT C. FERREIRA, DO HEREBY LOCATE AND CLAIM 1500 (FIFTEEN HUNDRED) LINEAR FEET OF THIS VEIN OR LODE, TOGETHER WITH SURFACE GROUND EXTENDING 300 FEET IN WIDTH ON EACH SIDE OF THE MIDDLE OF SAID VEIN OR LODE AND DESCRIBED AS FOLLOWS:

COMMENCING AT A POST WHERE THIS NOTICE IS POSTED, WHICH POST IS AT THE POINT OF DISCOVERY ON SAID VEIN OR LODE AND ON THE CENTER LINE OF THIS LOCATION, I HEREBY CLAIM 1480 FEET EXTENDING IN A NORTHERLY DIRECTION ALONG THE COURSE OF SAID VEIN AND 20 FEET IN A SOUTHERLY DIRECTION. THE GENERAL COURSE OF THE VEIN OR LODE IS NORTHERLY AND SOUTHERLY AS NEAR AS CAN BE DETERMINED FROM PRESENT DEVELOPMENTS. THE DISCOVERY POST IS SITUATED ABOUT 945 FEET IN A ~~SOUTHWESTERLY~~ DIRECTION FROM A U.S. DEPT OF THE INTERIOR 1964 CADASTRAL SURVEY MARKER.*

THE NAME OF THIS CLAIM IS EVERLASTING ARM # 1 AND IT IS SITUATED IN POCHE MINING DISTRICT, COUNTY OF LINCOLN, STATE OF NEVADA.

DATE: NOVEMBER 22, 1973

Hubert C. Ferreira
HUBERT C. FERREIRA,
LOCATOR.

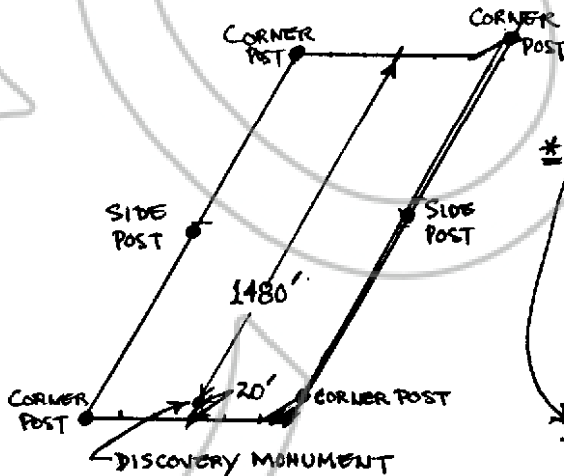

* U.S. DEPT OF THE INTERIOR
T4S360E
S36
S1 | S6
T5S | T5S
R60E & C R61E
1964
CADASTRAL SURVEY
BLM
P.O. BOX 77251
SAN FRANCISCO, CAL. 94107

No 53733 Recorded at the request of Hubert Ferreira at 1:45 P.M. this 27 day of December A.D. 1973 in Book 8 on page 694 Official Records of Lincoln County, Nev.

Donald Robinson
County Recorder