

RESOLUTION RELINQUISHING PORTION
OF HIGHWAY RIGHT-OF-WAY

WHEREAS, the State of Nevada Department of Highways presently holds a certain right-of-way being a portion of U.S. 93 (State Route 7), a federal-aid highway, located approximately one-half of a mile north of Alamo, County of Lincoln, Nevada, said right-of-way being used for a primary route; and

WHEREAS, said right-of-way is depicted on exhibit "A" attached hereto and made a part hereof and delineated in blue; and

WHEREAS, a portion of said right-of-way as depicted in blue is of no further use as a primary route due to the relocation of U.S. 93; and

WHEREAS, the Department of Highways, pursuant to the provisions contained in NRS 408.997, may relinquish and vacate by resolution, any portion of a state highway which has been superseded by relocation.

NOW THEREFORE, be it resolved by the Board of Directors of the State of Nevada Department of Highways that the following described right-of-way and incidents thereto, being all that land delineated in blue on exhibit "A," be and hereby is relinquished to the County of Lincoln, State of Nevada. Said right-of-way is more particularly described as follows:

Situate, lying and being in the County of Lincoln, State of Nevada, and more particularly described as being a portion of the W 1/2 of the SE 1/4 and the SW 1/4 of the NE 1/4 of Section 32, T. 6 S., R. 61 E., M.D.B. & M., being a strip of land one hundred feet in width, fifty feet wide on each side of the following surveyed highway centerline:

BEGINNING at the intersection of the centerline of U.S. 93 (State Route 7) at Highway Engineer's

Station "C" 55 + 78.46 P.O.C. and the left or westerly highway right-of-way line of present U.S. 93 (State Route 7) at a point 100 feet left of and measured radially from Highway Engineer's Station "C" 792 + 49.12 P.O.C., said point of beginning further described as bearing N. 52° 40' 19" W., a distance of 1738.41 feet from the southeast corner of Section 32, T. 6 S., R. 61 E., M.D.B. & M., thence from a tangent which bears N. 18° 01' 36" W., curving to the left along said centerline, with a radius of 2000 feet, through an angle of 0° 58' 45", an arc distance of 34.18 feet to a point; thence N. 19° 00' 21" W., continuing along said centerline a distance of 646.95 feet to a point; thence from a tangent which bears the last-described course, curving to the right along said centerline, with a radius of 1500 feet, through an angle of 8° 37', an arc distance of 225.58 feet to Highway Engineer's Station Equation "C" 64 + 85.17 P.T. = "N" 70 + 48.20 P.O.T., thence N. 10° 23' 21" W., continuing along said centerline a distance of 1035.09 feet to a point, thence from a tangent which bears the last-described course, curving to the left along said centerline, with a radius of 2000 feet, through an angle of 36° 57' 32", an arc distance of 1290.11 feet to the point of ending at an intersection of said centerline with the north boundary of the SW 1/4 of the NE 1/4 of said Section 32, at Highway Engineer's Station "N" 93 + 73.40 P.O.C., said parcel contains an area of 7.42 acres, more or less.

This document is intended to convey, and does convey, pursuant to relinquishment, any and all of the State of Nevada Department of Highways' right, title and interest in and to the above set out right-of-way to the County of Lincoln, State of Nevada.

DATED this 27th day of April, 1973.

ATTEST:

BOARD OF DIRECTORS, STATE OF NEVADA
DEPARTMENT OF HIGHWAYS

Stanley D. Sandeen
Secretary

Mike O'Callaghan
Chairman-Governor Mike O'Callaghan

Presented by:

Robert List
State Highway Engineer

Robert List
Member-Robert List

Approved as to Legality and Form:

Wilson McGowan
Member- Wilson McGowan

William H. Raymond
Deputy Attorney General,
Assistant Counsel
Department of Highways

EX

T.6S.R.61E.
T.7S.R.61E.

31.32
6 5



"W" 7+22.34 P.O.T.
"N" 201+81.69 P.O.T.

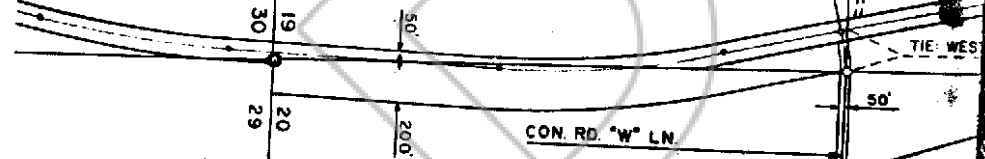

"C" 921+5
"W" 0+00

TRACED
CHECKED.

TO BE RELINQUISHED TO COUNTY
TO BE RETAINED
TO BE ABANDONED

52917

AND RECORDED AT REQUEST OF
State of Nev. Highway
by 21, 1973

TO LAS VEGAS
BY BOOK 353 OF OFFICIAL
PL. PAGE 353 LINCOLN
CO. NEVADA
COUNTY RECORDER

SKETCH MAP

ALAMO TO CRYSTAL SPRINGS

PROJ S-544 (II)
NEW T/W CONTRACT 1398
OLD T/W CONTRACT 407
Scale: 1" = 500' Date: FEBRUARY, 73

Revised MARCH 1973 CR

BOOK 7 355

